

Benchmark:
 City of Wichita Benchmark Disc,
 Hydraulic and 53th Street South,
 42.00' North of Centerline, 40.70'
 West of Centerline, 3.70' North of
 centerline of Power Pole, 58.20'
 Northwest of Southeast Corner, Sec.
 21, Twp. 28-S, R-1-E.
 Elev. = 76.19 City Datum
 Elev. = 1263.59 (NGVD29)

Scale: 1" = 20'
 • = Iron

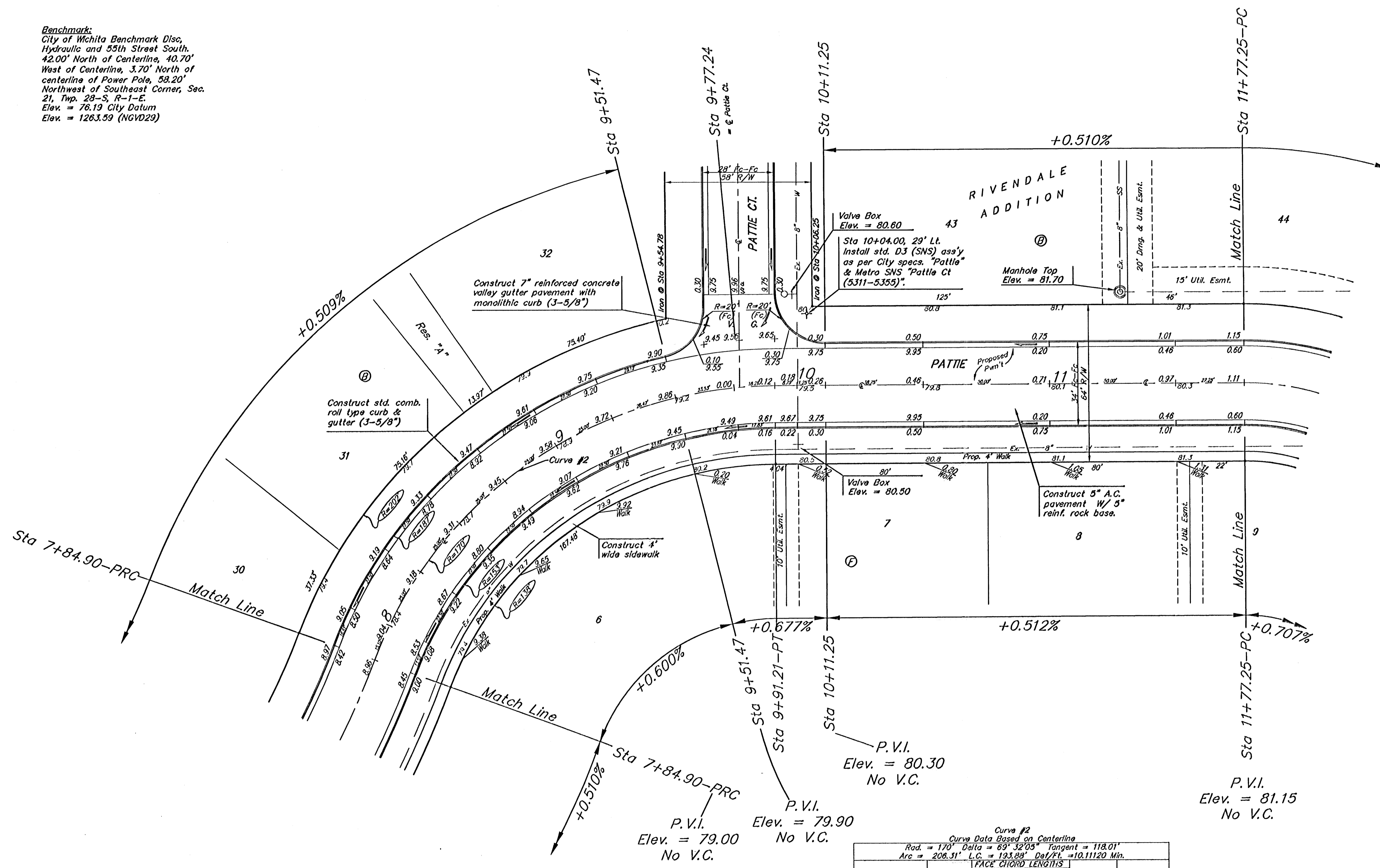

Subdivision Bench Marks

Street & Station	Location Description	Elevation
Pattie Ct. 3+54.24, 14.25' Lt.	Adjacent to Fire Hydrant at the Southeast corner of Lot 43, Block B	
Mona Cir. 3+03.34, 14.25' Rt.	Adjacent to Fire Hydrant at the Northeast corner of Lot 44, Block B	
Victoria Ct. 0+37.00, 14.25' Rt.	Adjacent to Fire Hydrant at the Northwest corner of Lot 25, Block C	

P.V.I.
Elev. = 80.30
No V.C.

P.V.I.
Elev. = 79.90
No V.C.

P.V.I.
Elev. = 79.00
No V.C.

P.V.I.
Elev. = 81.15
No V.C.

Curve #2
 Curve Data Based on Centerline
 Rad. = 170' Delta = 69° 32' 03" Tangent = 118.01'
 Arc = 208.31' L.C. = 123.88' Def/Flt = 10.11120 Min.

Station	Arc	FACE CHORD LENGTHS		Defn.	T. Defn.
		8' Lt.	8' Rt.		
7+84.90	-	-	-	0°00'00"	0°00'00"
8+00.00	15.10'	17.32'	12.88'	2°32'41"	2°32'41"
8+25.00	25.00'	28.55'	21.30'	4°12'47"	6°45'27"
8+50.00	25.00'	28.55'	21.30'	4°12'47"	10°58'14"
8+75.00	25.00'	28.55'	21.30'	4°12'47"	15°11'01"
9+00.00	25.00'	28.65'	21.30'	4°12'47"	19°23'48"
9+25.00	25.00'	28.65'	21.30'	4°12'47"	23°36'35"
9+50.00	25.00'	28.65'	21.30'	4°12'47"	27°49'21"
9+51.47	1.47'	1.69'	1.25'	0°14'52"	28°04'13"
9+77.24	25.77'	29.33'	21.98'	4°20'34"	32°24'43"
9+91.21	13.97'	16.02'	11.91'	2°21'13"	34°46'02"

NOTE: ROLL TYPE CURB & GUTTER TO BE CONSTRUCTED ON THE PAVEMENT SHOWN ON THIS SHEET. TOP OF CURB ELEVATIONS ARE GIVEN FOR FULL HEIGHT CURB.

RIVENDALE ADDITION - PHASE II

PATTIE
 Baughman STA 7+84.90 TO STA 11+77.25

Baughman Company, P.A. 315 E. 10th St., Wichita, KS 67211 P 316-262-7711 F 316-262-0149	
ENGINEERING SURVEYING PLANNING LANDSCAPE ARCHITECTURE	
PROJECT NUMBER 47243657	DESIGN MIS
REVISIONS	DRAWN TMS
	APPROVED DATE 02/05
	SCALE Noted
	SHEET 7 OF 28

Rivendale/Phase2/Str2 05-01-B138