

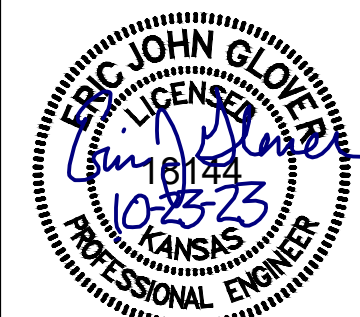

© 2023 GARVER, LLC
 THIS DOCUMENT, ALONG WITH THE IDEAS AND DESIGNS CONVEYED HEREIN, SHALL BE CONSIDERED INSTRUMENTS OF PROFESSIONAL SERVICE AND ARE PROPERTY OF GARVER, LLC. ANY USE, REPRODUCTION, OR DISTRIBUTION OF THIS DOCUMENT, ALONG WITH THE IDEAS AND DESIGN CONTAINED HEREIN, IS PROHIBITED UNLESS AUTHORIZED IN WRITING BY GARVER, LLC OR EXPLICITLY ALLOWED IN THE GOVERNING PROFESSIONAL SERVICES AGREEMENT FOR THIS WORK.

1995 Midfield Road
 Wichita, KS 67209
 (316) 264-8008



REV.	DATE	DESCRIPTION



CITY OF WICHITA
 WICHITA, KANSAS
 AREA 151
 WATER - PHASE 1

**EC PLAN
 NORTH
 WATER**

JOB NO.: 22T41002
 DATE: OCT. 2023
 DESIGNED BY: .
 DRAWN BY: .

BAR IS ONE INCH ON ORIGINAL DRAWING
 IF NOT ONE INCH ON THIS SHEET, ADJUST SCALES ACCORDINGLY.

DRAWING NUMBER

SHEET NUMBER **43** OF **52**

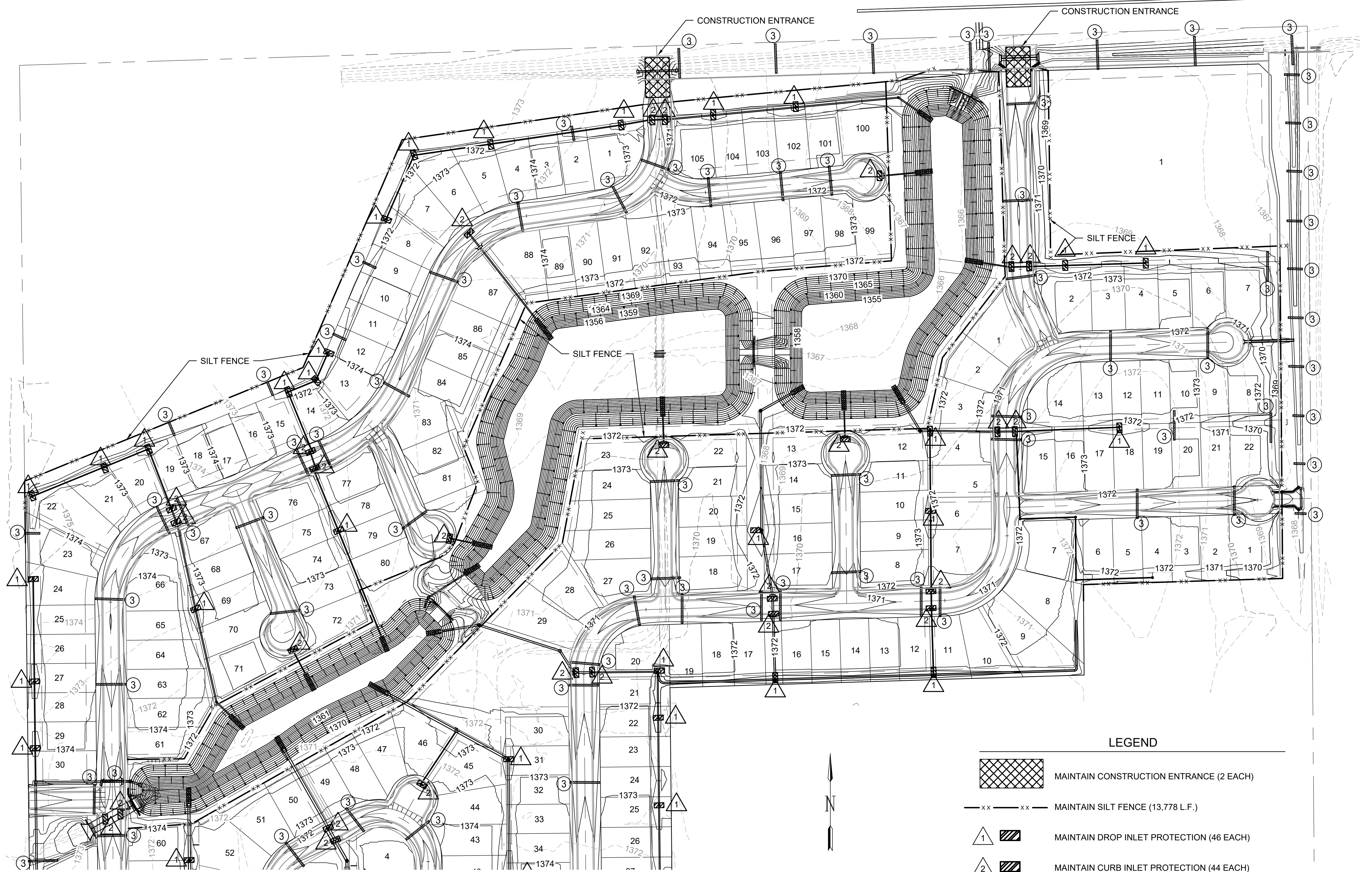

- LEGEND**
- MAINTAIN CONSTRUCTION ENTRANCE (2 EACH)
 - MAINTAIN SILT FENCE (13,778 L.F.)
 - MAINTAIN DROP INLET PROTECTION (46 EACH)
 - MAINTAIN CURB INLET PROTECTION (44 EACH)
 - MAINTAIN LINEAR SEDIMENT BARRIER (117 EACH)

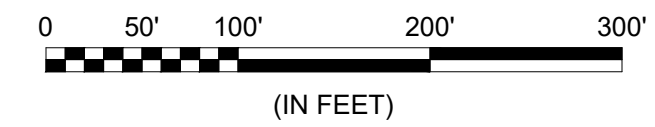

THESE ARE TOTALS FOR THIS SHEET AND THE NEXT SHEET.

File: L:\2022\22T41002 - Area 151 - Addition\Drawings\CADD\22T41002 EROSION CONTROL PLANS.dwg Last Save: 11/30/2023 2:57 PM Last saved by: DRStandrich
 Last plotted by: Standrich, Darryl R. Plot Style: --- Plot Scale: 1:2,5849 Plot Date: 11/30/2023 3:02 PM Plotter Used: None