

② CURVE DATA

P.I. Sta. 31+98.65 Bk.
P.I. Sta. 31+39.26 Ahd.
 $\Delta=90^{\circ}36'26''$
 $D=42^{\circ}26'29''$
 $R=135.00'$
 $T=136.44'$
 $L=213.49'$
 $E=56.94'$

① CURVE DATA

P.I. Sta. 35+09.49 Bk.
P.I. Sta. 34+51.55 Ahd.
 $\Delta=90^{\circ}00'00''$
 $D=42^{\circ}26'29''$
 $R=135.00'$
 $T=135.00'$
 $L=212.06'$
 $E=55.92'$

SCALE: 1"=20'

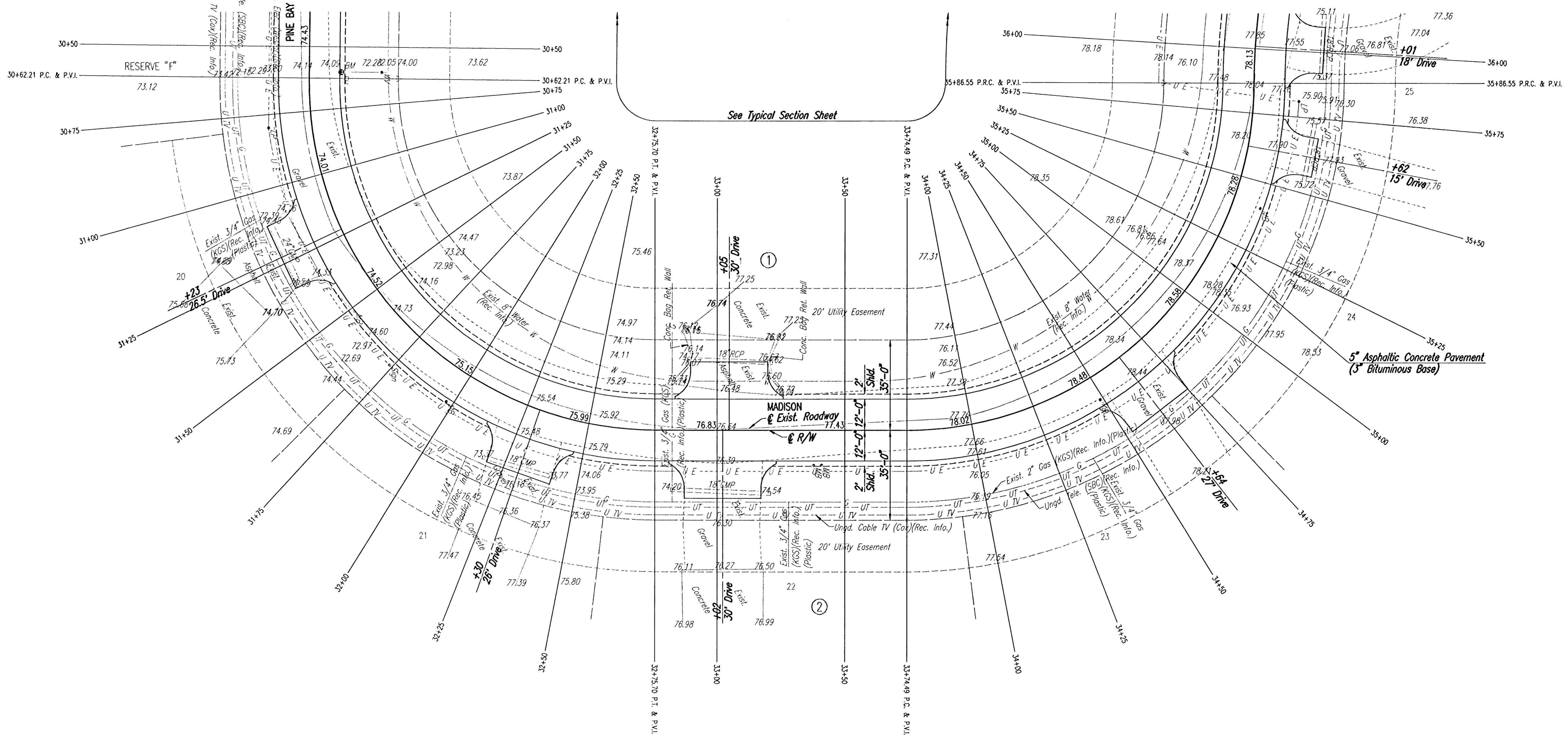

DSNR: BOB OPER: BJS SCALE: 1"=20.00
C:\2004\04465\000\STR31-36 01-14-2005 07:40:14 am

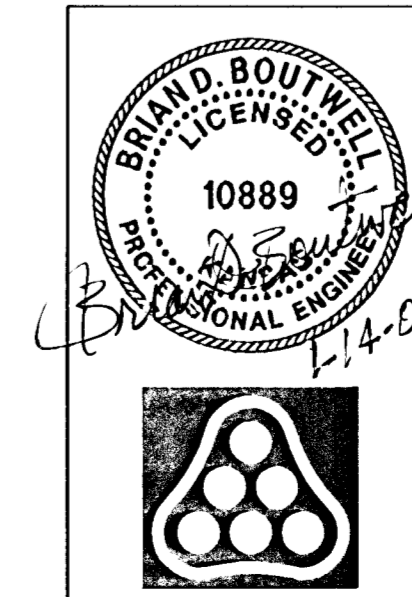

No.	Revision	By	Date

PINE BAY ESTATES
MADISON
STA. 30+62.21 TO STA. 35+86.55
JAMES L. ARMOUR, P.E. - ACTING CITY ENGINEER
CITY OF WICHITA PROJECT NO. 472-84034

Professional Engineering Consultants, P.A.
303 S. TOPEKA • WICHITA, KANSAS 67202
316-262-2691 • FAX 316-262-3003

Designed by	BDB	Job No.	35-04465-000	Sht. 9 of 37
Drawn by	BJS	Date	SEPTEMBER 2004	