

SCALE: 1"=20'

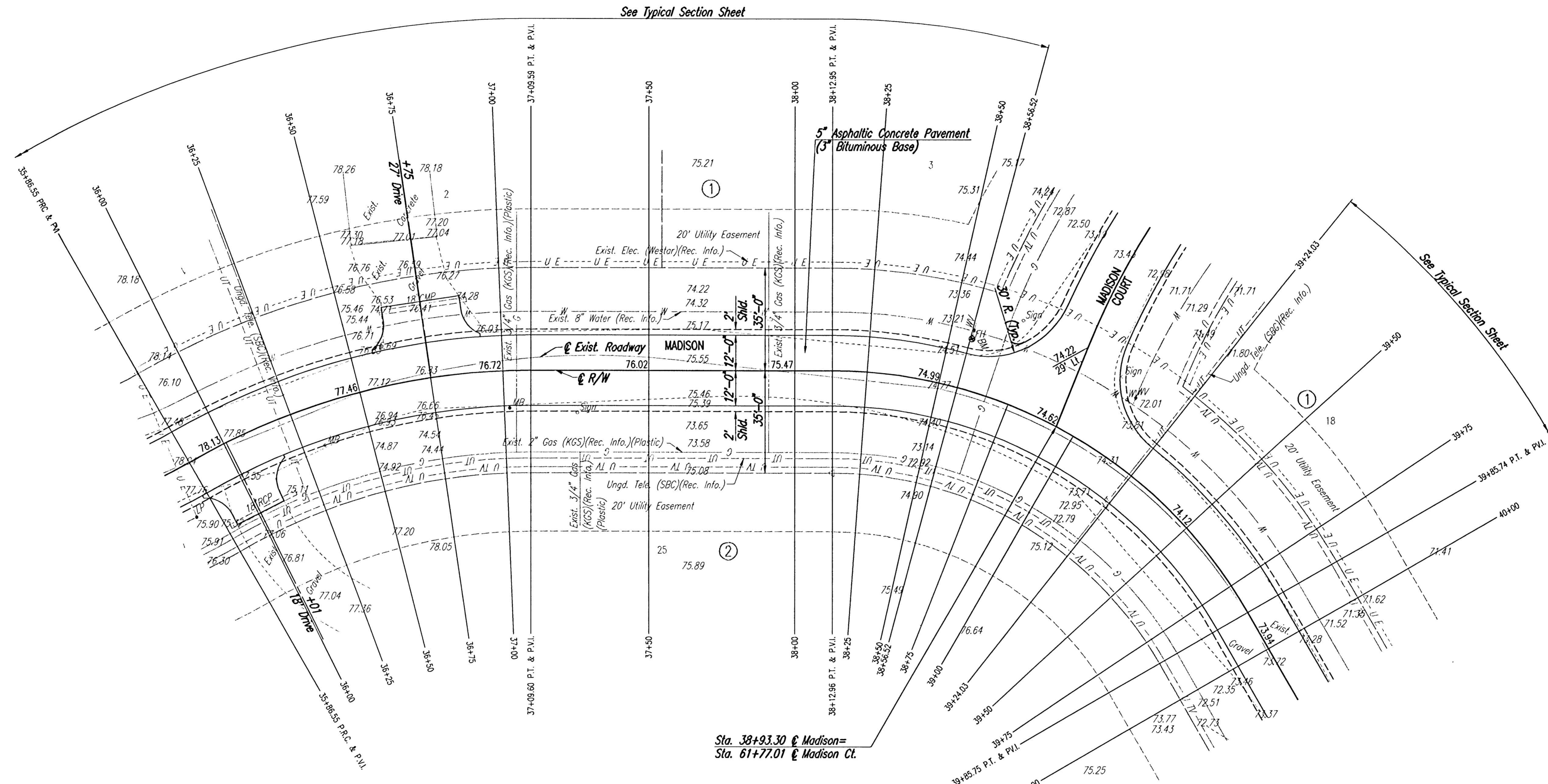

See Typical Section Sheet

See Typical Section Sheet

Sta. 38+93.30 @ Madison =
Sta. 61+77.01 @ Madison Ct.

☺ CURVE DATA

P.I. Sta. 36+49.52 Bk.
P.I. Sta. 36+46.63 Ahd.
Δ=30°00'00"
D=24°22'52"
R=235.00'
T=62.97'
L=123.05'
E=8.29'

☺ CURVE DATA

P.I. Sta. 39+08.22 Bk.
P.I. Sta. 39+90.48 Ahd.
Δ=60°00'00"
D=34°43'29"
R=165.00'
T=95.26'
L=172.79'
E=25.53'

DSNR: BDB OPER: BJS SCALE: 1"=20.00
 C:\2004\04465\000\STR36-40 01-14-2005 07:42:02.am

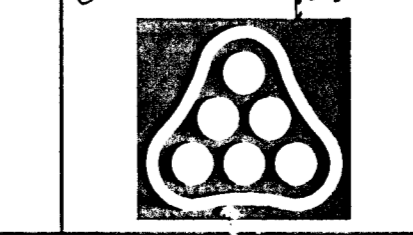
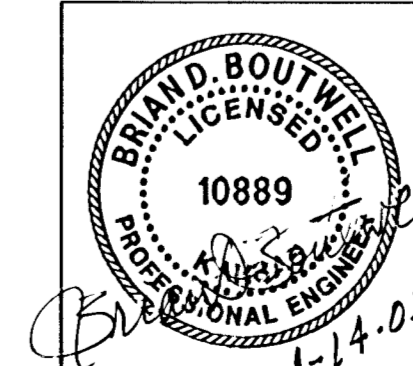

No.	Revision	By	Date
	PINE BAY ESTATES MADISON STA. 35+86.55 TO STA. 39+85.75 JAMES L. ARMOUR, P.E. - ACTING CITY ENGINEER CITY OF WICHITA PROJECT NO. 472-84034 Professional Engineering Consultants, P.A. 303 S. TOPEKA • WICHITA, KANSAS 67202 316-262-2691 • FAX 316-262-3093		
Designed by	BDB	Job No.	35-04465-000
Drawn by	BJS	Date	SEPTEMBER 2004