

DSNR: BOB OPER: BJS SCALE: 1"=20.00
 Q:\2004\04465\000\STR66-62 01-14-2005 07:55:57 am

☉ CURVE DATA

P.I. Sta. 60+66.43 Bk.
 P.I. Sta. 60+59.89 Ahd.
 $\Delta=38^{\circ}07'10"$
 $D=22^{\circ}28'08"$
 $R=255.00'$
 $T=88.10'$
 $L=169.65'$
 $E=14.79'$

SCALE: 1"=20'

Sta. 61+77.01 @ Madison Ct. =
 Sta. 38+93.30 @ Madison

See Typical Section Sheet

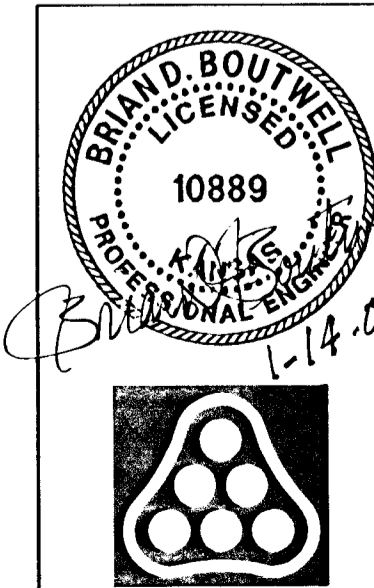
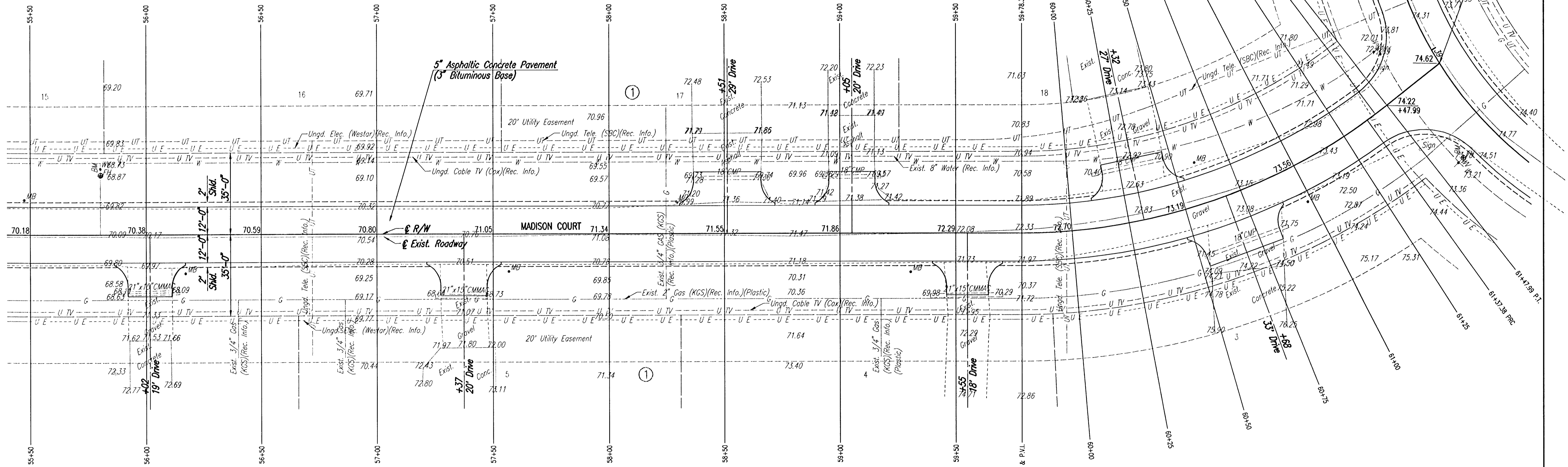

| | | | |
|--|----------|---------|----------------|
| No. | Revision | By | Date |
| PINE BAY ESTATES | | | |
| MADISON COURT | | | |
| STA. 55+50 TO STA. 61+77.01 | | | |
| JAMES L. ARMOUR, P.E. - ACTING CITY ENGINEER | | | |
| CITY OF WICHITA PROJECT NO. 472-84034 | | | |
| Professional Engineering Consultants, P.A. | | | |
| 303 S. TOPEKA • WICHITA, KANSAS 67202 316-262-2691 • FAX 316-262-3003 | | | |
| Designed by | BOB | Job No. | 35-04465-000 |
| Drawn by | BJS | Date | SEPTEMBER 2004 |
| | | | SH. 13 of 37 |