

WOODLAND LAKES ESTATES
THIRD ADDITION

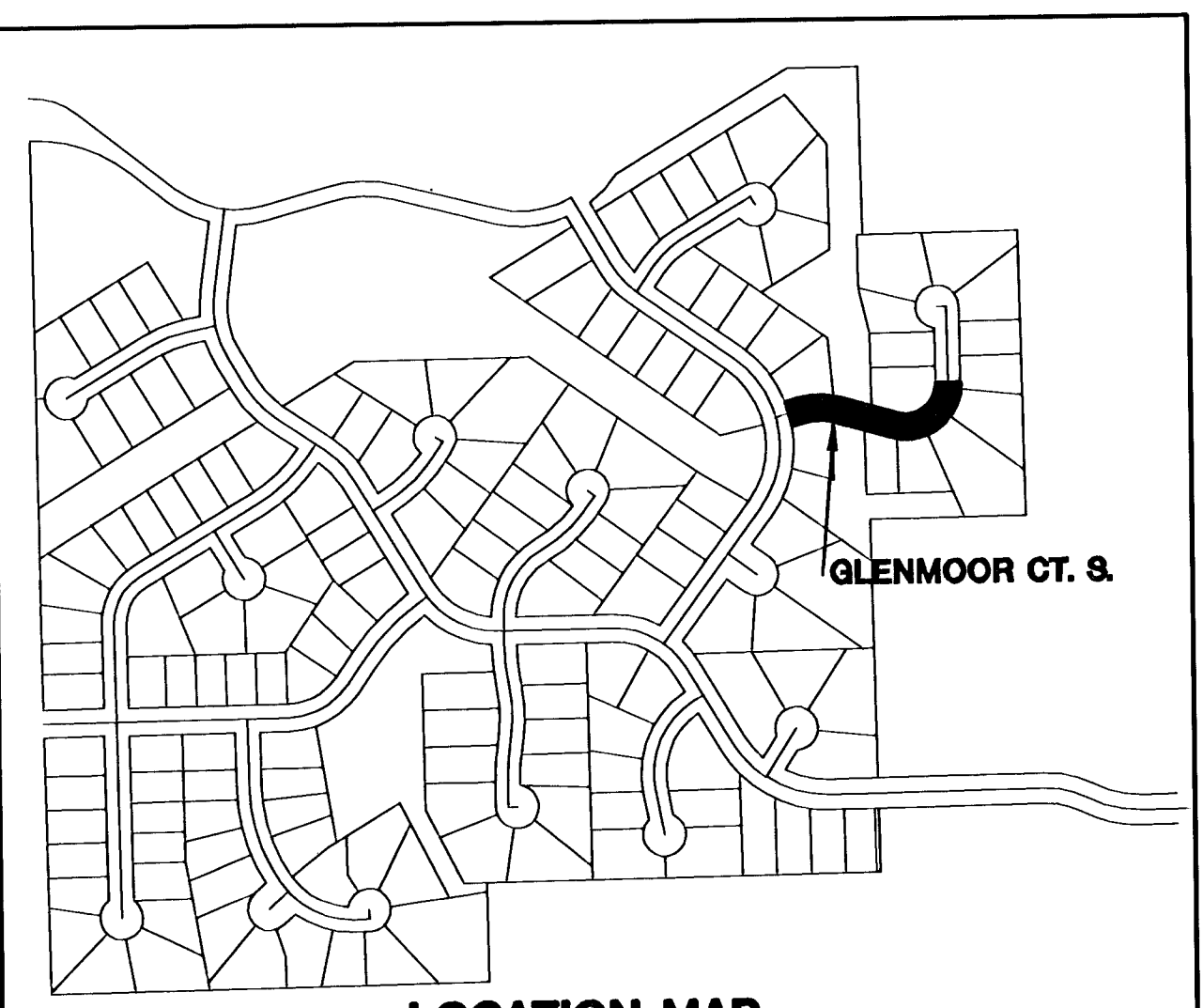
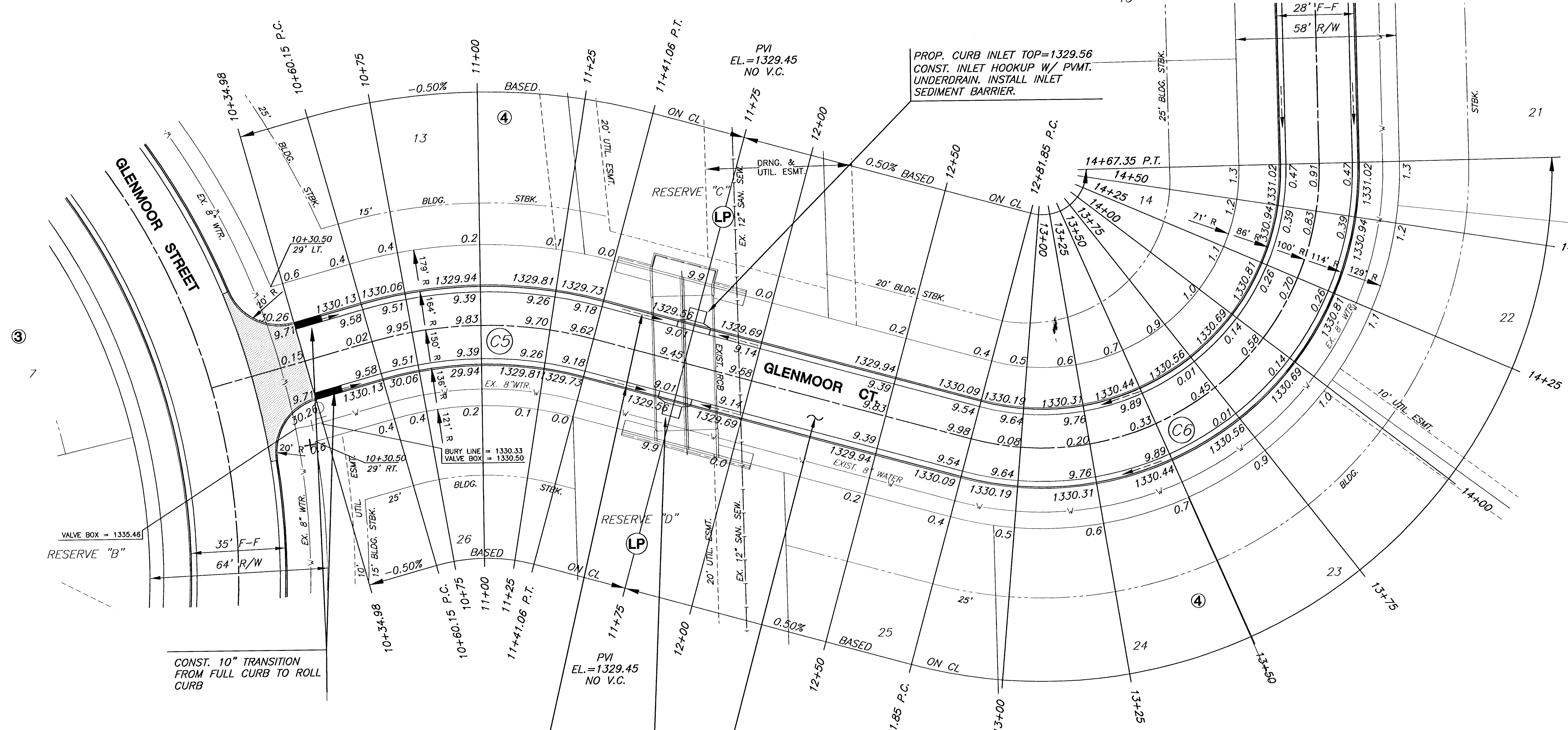
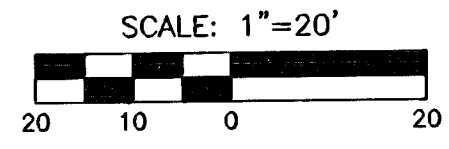

CONSTRUCT COMBINED
CURB & GUTTER
(ROLL CURB, 3 5/8")

PROP. CURB INLET TOP=1329.56
CONST. INLET HOOKUP W/ PVMT.
UNDERDRAIN. INSTALL INLET
SEDIMENT BARRIER.

CONST. 5" A.C. PAVEMENT
W/ 3" BIT. BASE OVER 6"
CRUSHED ROCK BASE ON
GEOGRID REINFORCEMENT.

- NOTE:**
1. TOP OF CURB ELEVATIONS SHOWN ARE FOR FULL CURB. CONSTRUCT CURB AS NOTED.
 2. CONTRACTOR SHALL REMOVE ALL TREES WITHIN ROAD RIGHT-OF-WAY.
 3. CURVE DATA FOR CURVES LABLED (C#) MAY BE FOUND ON SHEET 15.

- LEGEND**
- + STREET SIGN & SIGN LOCATION
(SEE SIGN ASSEMBLY TABLE
FOR TYPE & STATION OF SIGN)
 - [Hatched Box] = VALLEY GUTTER

H:\CIVIL\95058\02172\dwg\Pav\GLENMOOR\02172E6.dwg

<p>MKEC ENGINEERING CONSULTANTS 411 N. WEBB ROAD WICHITA, KS. 67206 316 - 884 - 9600</p>	<p>WOODLAND LAKES THIRD ADDTION PROJECT NAME</p>		
	<p>GLENMOOR COURT SO. - GLENMOOR PHASE SHEET TITLE</p>		
	<p>SRS DESIGN BY:</p>	<p>DM DRAWN BY:</p>	<p>SRS CHECKED BY:</p>
	<p>MAY 2005 DATE</p>	<p>02172E6 JOB NO.</p>	<p>13 / 29 SHEET/OF</p>