

REEDS COVE ADDITION

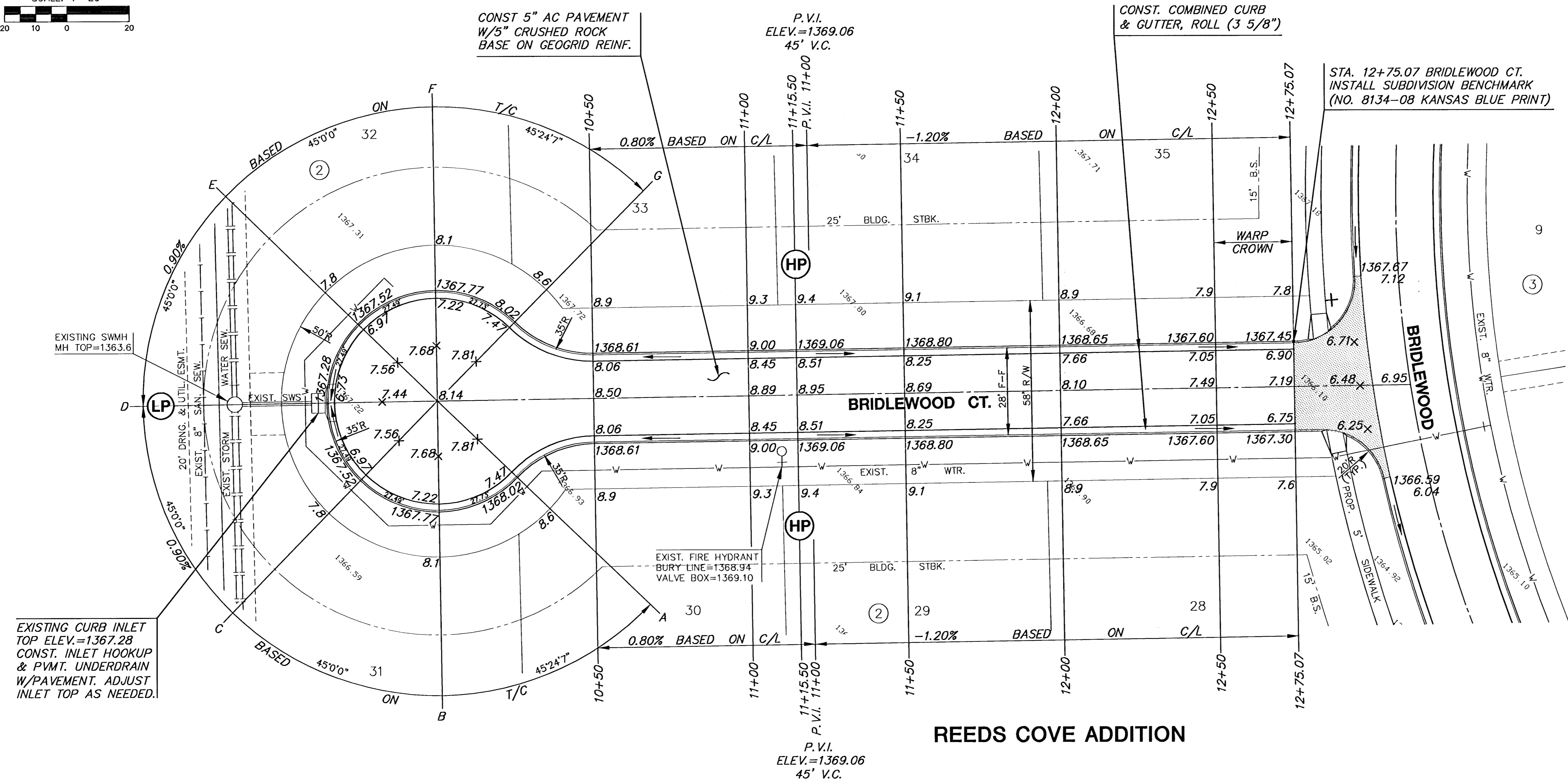

EXISTING CURB INLET
TOP ELEV.=1367.28
CONST. INLET HOOKUP
& PVMT. UNDERDRAIN
W/PAVEMENT. ADJUST
INLET TOP AS NEEDED.

CONST 5" AC PAVEMENT
W/5" CRUSHED ROCK
BASE ON GEOGRID REINF.

CONST. COMBINED CURB
& GUTTER, ROLL (3 5/8")

STA. 12+75.07 BRIDLEWOOD CT.
INSTALL SUBDIVISION BENCHMARK
(NO. 8134-08 KANSAS BLUE PRINT)

REEDS COVE ADDITION

P.V.I.
ELEV.=1369.06
45' V.C.

SUBDIVISION BENCH MARKS				
NO.	STREET AND STATION	FROM CL	DESCRIPTION	ELEVATIONS
1	BRIDLEWOOD CT., STA. 12+75.07	14.5' LT	TOP OF CURB AT S.E. CURB RETURN	

NOTE: CONTRACTOR SHALL INSTALL SUBDIVISION BENCH MARKS ("FLAT SURVEY MARKERS NO. 8134-08 3" TOP DIAMETER" PROVIDED BY KANSAS BLUE PRINT CO., INC.) COSTS TO BE CONSIDERED SUBSIDIARY TO CONSTRUCTION OF COMBINED CURB AND GUTTER.

NOTE:
TOP OF CURB ELEVATIONS SHOWN
ARE FOR FULL CURB. CONSTRUCT
CURB & GUTTER AS NOTED.

LEGEND

+ STREET SIGN & SIGN LOCATION
(SEE SIGN ASSEMBLY TABLE
FOR TYPE & STATION OF SIGN)



REEDS COVE ADDITION - PHASE 3
PROJECT NAME

BRIDLEWOOD COURT PAVING
SHEET TITLE

DFL DESIGN BY:	DMU DRAWN BY:	GJA CHECKED BY:
JUNE 2005 DATE	02121 JOB NO.	9 / 19 SHEET/OF

P:\DWG\02121\DWG\PAV\PHASE 3\02121_E3.DWG