

BENCHMARK:
 City Disc in T.C. Adj. to F.H.
 38' South of intersection of
 Onwood and Auburn Hills.
 Elev. = 178.48 (City Datum)

"□" cut in south curb of
 Onwood 272' west of C.L.
 Auburn Hills.
 Elev. = 179.73 (City Datum)

Subdivision Bench Marks		
Street & Station	Location Description	Elevation
Ocala Ct. 1+02.06, 14.25' Lt.	Adjacent to Fire Hydrant near common lot corner of Lots 24-25, Block B.	
Ocala Ct. 5+71.79, 14.25' Lt.	Adjacent to Fire Hydrant at W. End of N. Curb Return of Ocala & Ocala Ct.	

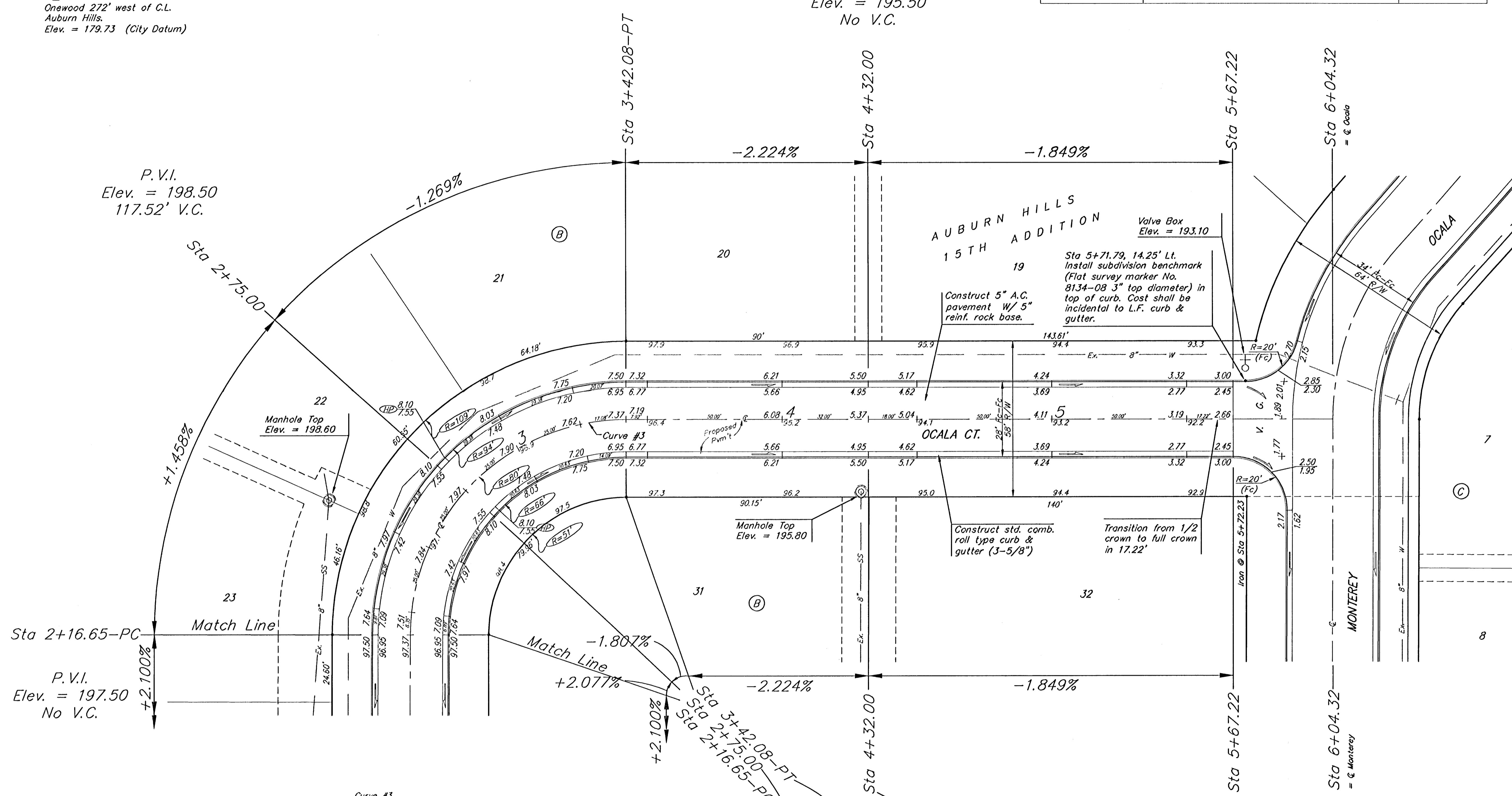
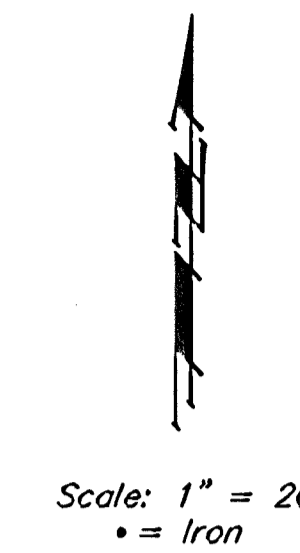

P.V.I.
 Elev. = 198.50
 117.52' V.C.

P.V.I.
 Elev. = 197.50
 No V.C.

P.V.I.
 Elev. = 195.50
 No V.C.

P.V.I.
 Elev. = 197.50
 No V.C.

P.V.I.
 Elev. = 198.50
 82.52' V.C.

P.V.I.
 Elev. = 197.50
 No V.C.

Curve #3
 Curve Data Based on Centerline
 Rad. = 80' Delta = 89° 49' 57" Tangent = 79.77'
 Arc = 125.43' L.C. = 112.97' Del/Fl. = 21.48589 Min.

Station	Arc	FACE CHORD LENGTHS		Defl.	T. Defl.
		8" Lt.	8" Rt.		
2+16.65	-	-	-	0°00'00"	0°00'00"
2+25.00	8.35'	10.64'	6.05'	2°59'24"	2°59'24"
2+50.00	25.00'	31.75'	18.05'	8°57'09"	11°56'33"
2+75.00	25.00'	31.75'	18.05'	8°57'09"	20°53'42"
3+00.00	25.00'	31.75'	18.05'	8°57'09"	29°50'51"
3+25.00	25.00'	31.75'	18.05'	8°57'09"	38°47'60"
3+42.08	17.08'	21.74'	12.36'	6°06'59"	44°54'58"

Baughman AUBURN HILLS 15TH ADDITION - PHASE 2B
OCALA CT.
 STA 2+16.65 TO STA 6+04.32

Baughman Company, P.A. 315 11th St. Wabasha, KS 67111 P.316.263.7121 F.316.263.6149
 ENGINEERING | SURVEYING | PLANNING | LANDSCAPE ARCHITECTURE

PROJECT NUMBER	DESIGN AEG	DRAWN TMS
REVISIONS	APPROVED	DATE 06/05
	SCALE Noted	
	SHEET	9 OF 21

Auburn15/Ph2B/Std 04-11-E099