

Existing Grade
 Proposed Grade

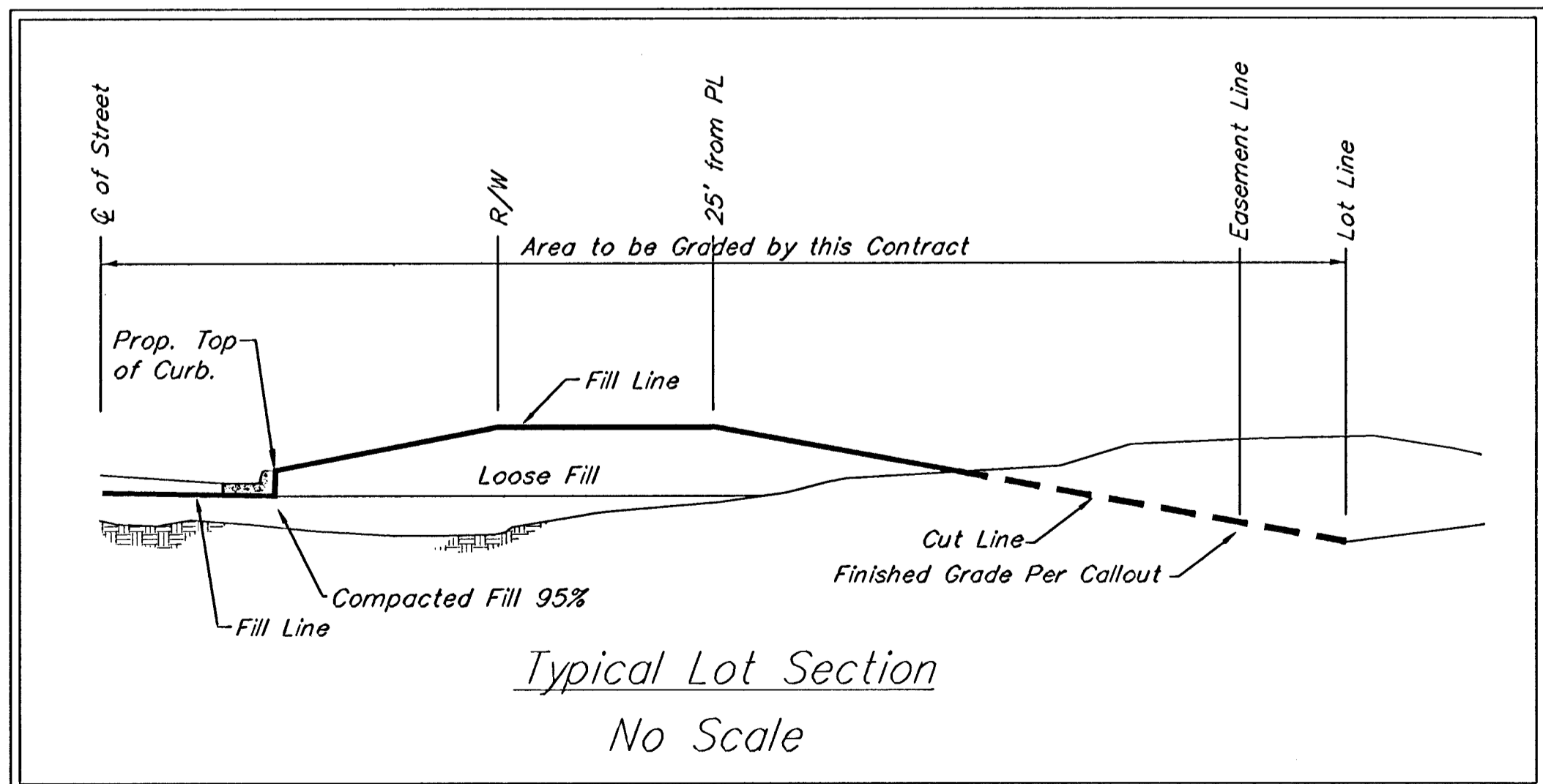

EARTH WORK TOTALS

	C.Y. Excavation	C.Y. Fill
Mass Grading	24,397	7,419

Stockpile excess material on-site on Lots 1-10, Block A, out of easements and right-of-way. Earthwork quantities are for reference only. All cost associated with mass grading shall be incidental to lump sum bid item "Mass Grading".

- Contractor to strip top 3" of soil within street R/W's before mass grading and stockpile.
- Compaction of 95% shall be obtained in all street R/W's, 90% in all other areas.
- It shall be the Contractor's responsibility to protect the sanitary sewer and water distribution system during mass grading. Any damage done to these systems by Contractor or subcontractor shall be repaired at no additional cost to the project.
- Only trees within the street R/W may be removed if necessary for grading. All other trees shall be protected from damage.
- All areas disturbed during construction not under proposed pavement are to be seeded as follows:
 Seed: - Rye Grass (PLS) - 5#/1000 Sq. Ft. and Kansas Premium Fescue Blend - 5#/1000 Sq. Ft. Cost of seeding shall be incidental to "Project Seeding".

EROSION CONTROL PLAN LEGEND
(Installation Details Found in the SMD2 Plan)

- LIGHT STONE RIP-RAP
- DROP INLET PROTECTION
- CURB INLET PROTECTION
- STRAW BALE BARRIERS
- SILT FENCING
- EARTH DIKES
- CURLEX BLANKET

NO SCALE

THE FAIRMONT - PHASE III
MASS GRADING PLAN &
EROSION CONTROL PLAN
 WICHITA, KANSAS

Baughman Company, P.A. 315 Ellis St. Wichita, KS 67211 P 316-262-7271 F 316-262-0149
ENGINEERING | SURVEYING | PLANNING | LANDSCAPE ARCHITECTURE

PROJECT NUMBER 472-93485	DESIGN TMS
REVISIONS	APPROVED DATE 09/05
SCALE Noted SHEET 17 OF 27	

FairmontPhaseIII.Mas 0404-E871