

STREET AND INCIDENTAL DRAINAGE IMPROVEMENTS

TO SERVE

84042

PRAIRIE POINTE-PHASE 2

MANCHESTER-FROM THE N.L. OF LOT 3, BLOCK 3, TO THE N.L. OF LOT 10, BLOCK 3
 HAVENHURST-FROM THE W.L. OF MANCHESTER TO THE W.L. OF LOT 21, BLOCK 4
 SIDEWALK-ALONG THE WEST SIDE OF MANCHESTER FROM THE S.L. OF LOT 32, BLOCK 4
 TO THE N.L. OF LOT 30, BLOCK 4, AND THE SOUTH SIDE OF HAVENHURST
 FROM THE E.L. OF LOT 29, BLOCK 4, TO THE WEST LINE OF LOT 21, BLOCK 4.

OCA NO. 765958

CITY OF WICHITA PROJECT NO. 472-84042

CITY OF WICHITA, KANSAS

JAMES L. ARMOUR, P.E. - CITY ENGINEER

INDEX OF SHEETS

1. TITLE SHEET
2. KEY MAP AND GENERAL NOTES
- 3-4. PLATS
- 5-6. FOUR CORNER LOT GRADING PLANS
7. TYPICAL 21' BK.-BK. PAVEMENT DETAILS
8. TYPICAL 35' BK.-BK. PAVEMENT DETAILS
9. PAVING PLAN-HAVENHURST
10. PAVING PLAN-HAVENHURST/MANCHESTER
11. PAVING PLAN-MANCHESTER
12. PAVING PLAN-MANCHESTER
13. MISCELLANEOUS PAVING DETAILS
- 14-15. PLAN/PROFILE-SWS LINE NO. 1
- 16-17. PLAN/PROFILE-SWS LINE NO. 2
18. PLAN/PROFILE-SWS LINE NO. 2A
19. STD. TYPE 1A CURB INLET (5' OPENING)
20. STD. TYPE II CURB INLET
21. STD. AREA INLET DETAILS
22. STD. TYPE "P" MANHOLE DETAILS
23. MANHOLE FRAME AND COVER
24. MISCELLANEOUS DRAINAGE DETAILS
25. EROSION CONTROL PLAN
- 26-29. EROSION CONTROL DETAILS
30. SIGNING DETAILS
- 31-38. CROSS SECTIONS

EARTHWORK

EXCAVATION 374 CU. YDS.
 COMPACTED FILL 1,959 CU. YDS.
 LOOSE FILL 2,231 CU. YDS.
 CONTRACTOR FURNISHED BORROW 4,190 CU. YDS.
 PROJECT LENGTH = 1,403 LIN. FT.

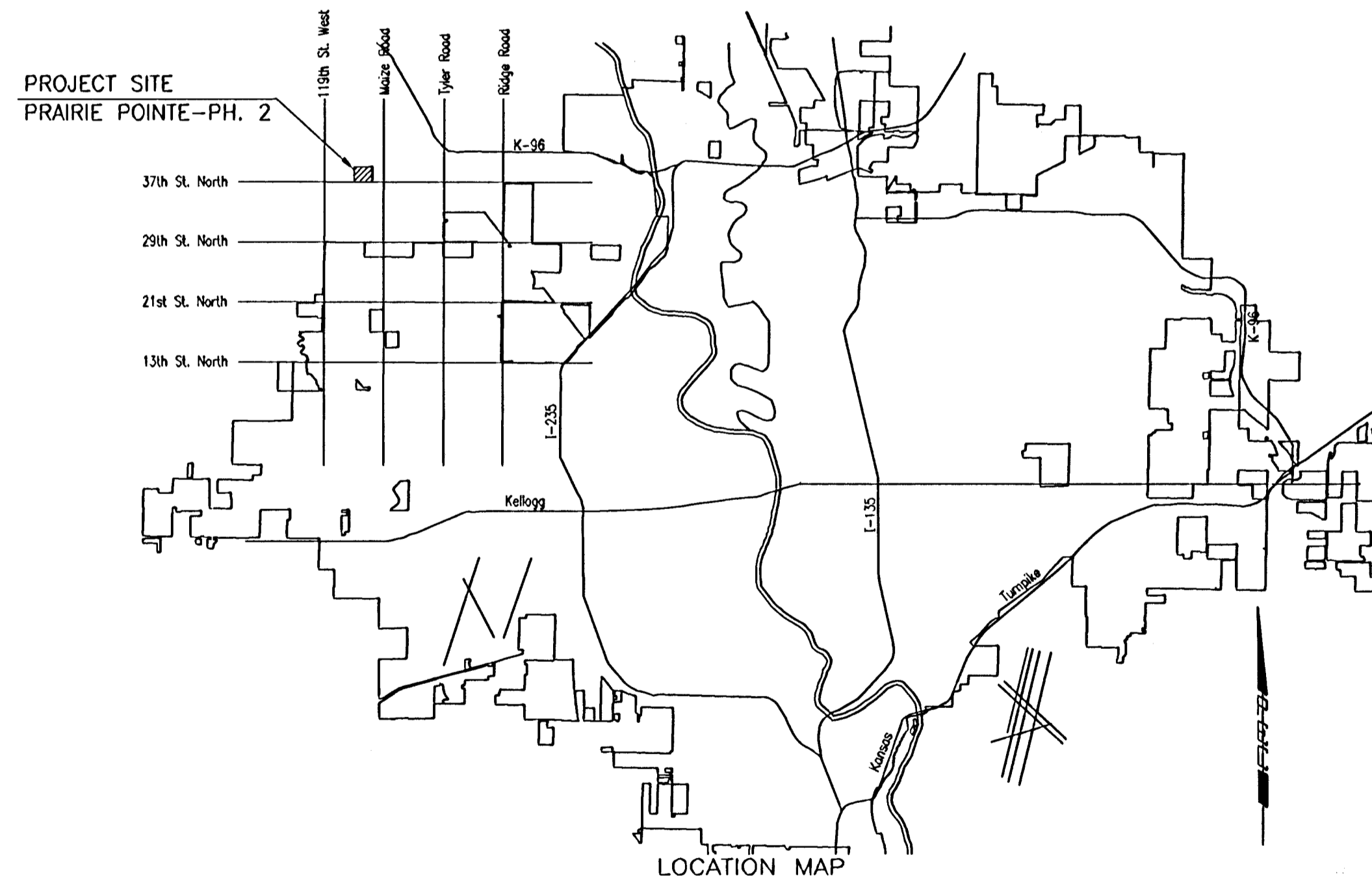

SUBDIVISION BENCH MARKS (SBM)				
NO.	STREET AND STATION	FROM	DESCRIPTION	ELEVATION
1	HAVENHURST, STA. 46+63.19	17.5' LT.	ON NORTH CURB, SW COR. LOT 3, BLOCK 2, PRAIRIE POINTE 2ND	
2	HAVENHURST, STA. 52+97.12	17.5' LT.	WEST END, NORTHWEST CURB RETURN, MANCHESTER	
3	MANCHESTER, STA. 57+00	17.5' LT.	ON EAST CURB, 13.5' NORTH FROM CENTER EXIST. INLET	

THE COST OF THE BENCH MARK DISC, INCLUDING INSTALLATION, SHALL BE INCIDENTAL TO THE CURB.

OCTOBER 2005

PLANS PREPARED BY
PROFESSIONAL ENGINEERING CONSULTANTS, P.A.
 ENGINEERS
 WICHITA, KANSAS

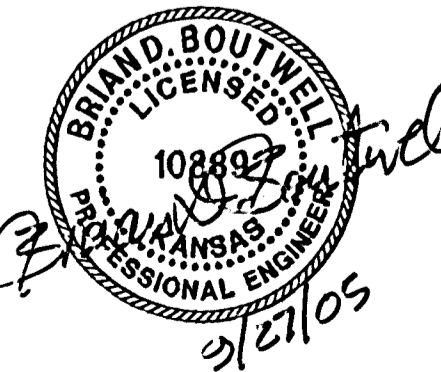

CONSTRUCTION SCHEDULE/SEQUENCE

THE CONTRACTOR FOR EACH OF THE FOLLOWING PRAIRIE POINTE PHASE 2 PROJECTS SHALL COORDINATE THEIR EFFORTS WITH OTHER CONTRACTORS PERFORMING WORK IN THIS AREA SUCH THAT ANY NECESSARY SIMULTANEOUS CONSTRUCTION CAN PROCEED CONCURRENTLY WITHOUT CAUSING UNDUE DELAYS SO THAT CONSTRUCTION CAN BE COMPLETED WITHIN THE TIME FRAMES AS NOTED.

SANITARY SEWER (468-83808)

THE CONTRACTOR SHALL COMPLETE, INCLUDING TESTING AND ACCEPTANCE, ALL WORK ON THE PROJECT BY DECEMBER 20, 2005.

WATER DISTRIBUTION SYSTEM (448-89951)

THE CONTRACTOR SHALL COMPLETE PRAIRIE POINTE - PHASE 2 WATERLINE CONSTRUCTION BY JANUARY 31, 2006.

STREETS/DRAINAGE (472-84042)

THE CONTRACTOR SHALL COMPLETE PRAIRIE POINTE - PHASE 2 STREETS/DRAINAGE CONSTRUCTION BY MARCH 31, 2006.

37TH STREET ASPHALT MAT PAVING (472-84044)

THE CONTRACTOR SHALL COMPLETE PRAIRIE POINTE - 37TH STREET ASPHALT MAT PAVING CONSTRUCTION BY DECEMBER 16, 2005.

DSNR: BLB OPER: BUS SCALE: 1"=1.00
 CA: 2005\05300\000\05300-000-C-STREET TITLE: 09-26-2005 04:40:12 pm