

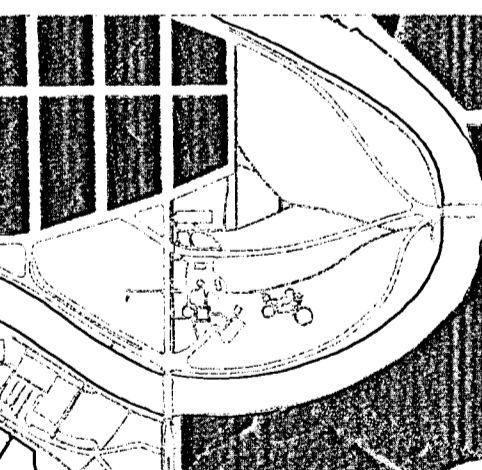

RIVERSIDE PARK SYSTEM
Riverside Pavement Contract
Wichita, Kansas

KEY PLAN



CENTRAL RIVERSIDE PARK

PRINTS ISSUED
MAY 3, 2002 - 50% REVIEW
JULY 1, 2002 - 85% REVIEW
SEPTEMBER 6, 2002 - FOR BID

WDM No. 00113
drawn: BDI/KDM
checked: PJM/NBW

Demolition Plan - West of Nims

SECTION ONE
3 of 6

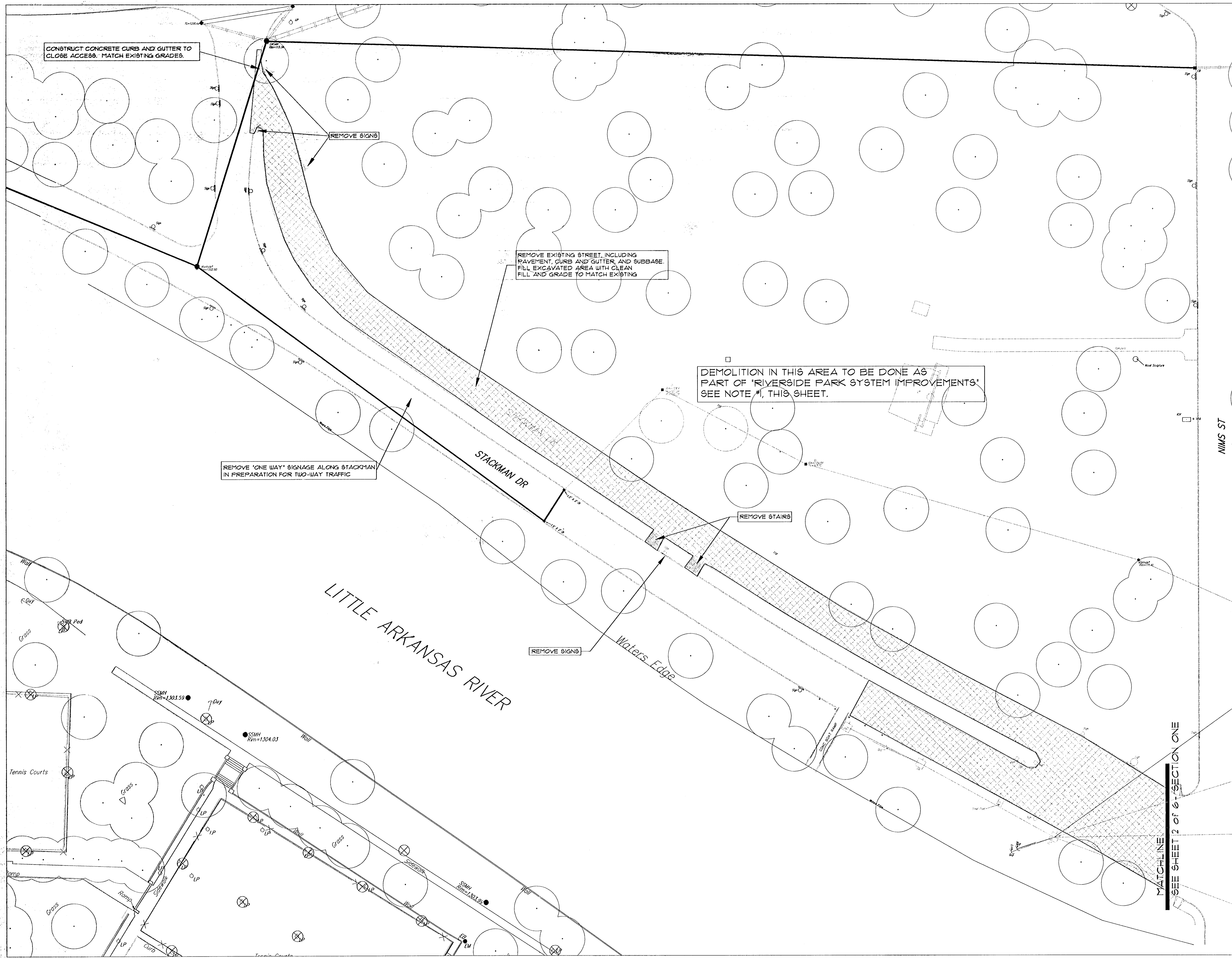

LEGEND

- PAVEMENT TO BE REMOVED
- TREE TO BE REMOVED

- NOTES**
1. REFER TO RIVERSIDE PARK IMPROVEMENT DOCUMENT SHEET C2-D1 FOR ADDITIONAL DEMOLITION WORK RELATED TO PARK IMPROVEMENTS IN THIS AREA.
 2. REMOVE ANY ITEMS NOT SHOWN THAT CONFLICT WITH CONSTRUCTION. CONTRACTOR SHALL CONTACT OWNER'S REPRESENTATIVE PRIOR TO REMOVAL.
 3. SALVAGE ALL STONE MATERIALS (STONE VENEER, RETAINING WALL STONE, STONE CURBS, ROADWAY BRICK, ETC) AND RETURN TO CITY.

WEST CENTRAL RIVERSIDE PARK DEMOLITION PLAN

SCALE: 1" = 30'-0"

