

WATER VALVE BOX ELEVATIONS			
STREET	STATION	OFFSET	PROPOSED ELEVATION
FONTANA	25+13.02	23.0' RL	176.7
FONTANA	25+33.02	23.0' RL	176.5

CURVE DATA						
Δ=59°25'6" L D=7' 58" 56.9" R=717.77' L=744.36' T=409.56' E=108.63'						
CURVE DATA BASED ON C radius Δ/2= 29° 42' 33"						
STATION	ARC LENGTH	FACE CURB LENGTH	RIGHT CURB	CHORD LENGTH	DEFLECTION ANGLE	TOTAL DEFLECTION
8' OFF LEFT FACE CURB	8' OFF RIGHT FACE CURB					
16+06.67					0°00'00.0"	0°00'00.0"
16+11.91	5.24'	5.34'	5.34'	5.40'	00°12'32.9"	00°12'32.9"
16+25.00	13.09'	12.83'	13.35'	12.69'	13.49'	00°31'20.8"
16+50.00	25.00'	24.51'	25.49'	24.23'	25.76'	00°59'52.1"
16+75.00	25.00'	24.51'	25.49'	24.23'	25.76'	00°59'52.1"
17+00.00	25.00'	24.51'	25.49'	24.23'	25.76'	00°59'52.1"
17+25.00	25.00'	24.51'	25.49'	24.23'	25.76'	00°59'52.1"
17+50.00	25.00'	24.51'	25.49'	24.23'	25.76'	00°59'52.1"
17+75.00	25.00'	24.51'	25.49'	24.23'	25.76'	00°59'52.1"
18+00.00	25.00'	24.51'	25.49'	24.23'	25.76'	00°59'52.1"
18+00.50	0.50'	0.49'	0.51'	0.48'	0.52'	00°01'11.8"
18+14.69	14.19'	13.91'		13.75'		00°33'58.9"
18+25.00	10.31'					00°24'41.4"
18+50.00	25.00'					00°59'52.1"
18+75.00	25.00'					00°59'52.1"
18+81.90	6.90'					00°18'31.4"
18+90.52	8.42'	8.28'		8.16'		00°20'09.8"
19+00.00	9.88'	9.49'	9.87'	9.98'		00°23'10.9"
19+25.00	25.00'	24.51'	25.49'	24.23'	25.76'	00°59'52.1"
19+50.00	25.00'	24.51'	25.49'	24.23'	25.76'	00°59'52.1"
19+75.00	25.00'	24.51'	25.49'	24.23'	25.76'	00°59'52.1"
20+00.00	25.00'	24.51'	25.49'	24.23'	25.76'	00°59'52.1"
20+25.00	25.00'	24.51'	25.49'	24.23'	25.76'	00°59'52.1"
20+41.34	16.34'	16.02'	16.66'	15.84'	16.84'	00°39'07.8"
20+50.00	8.66'	8.83'		8.93'		00°20'44.3"
20+75.00	25.00'		25.49'	25.76'	00°59'52.1"	18°41'31.8"
21+00.00	25.00'		25.49'	25.76'	00°59'52.1"	19°41'23.9"
21+08.54	8.54'	8.71'		8.80'		00°20'27.1"
21+25.00	16.46'	16.14'	16.78'	15.96'	16.96'	00°39'25.0"
21+50.00	25.00'	24.51'	25.49'	24.23'	25.76'	00°59'52.1"
21+75.00	25.00'	24.51'	25.49'	24.23'	25.76'	00°59'52.1"
22+00.00	25.00'	24.51'	25.49'	24.23'	25.76'	00°59'52.1"
22+25.00	25.00'	24.51'	25.49'	24.23'	25.76'	00°59'52.1"
22+50.00	25.00'	24.51'	25.49'	24.23'	25.76'	00°59'52.1"
22+54.96	4.96'	4.86'	5.06'	4.81'	5.11'	00°11'52.7"
22+58.92	1.96'		2.00'	2.02'		00°04'41.6"
22+75.00	18.08'					00°43'11.8"
23+00.00	25.00'					00°59'52.1"
23+25.00	25.00'					00°59'52.1"
23+50.00	25.00'					00°59'52.1"
23+51.03	1.03'					00°02'28.0"
TOTAL	744.36'	498.67'	571.62'			Defl./L= 2.394741 min.

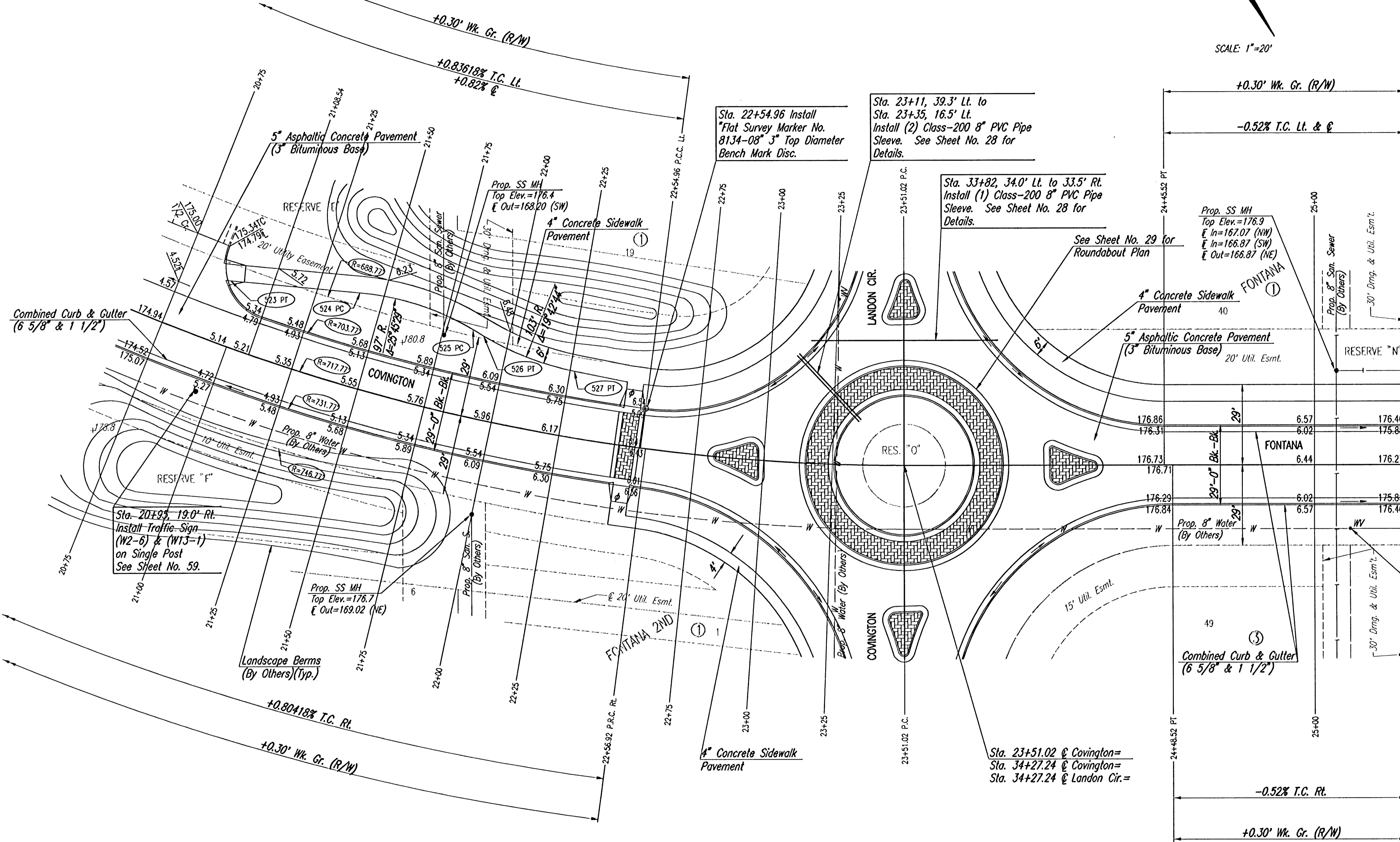

NOTE:
See Sheet No. 31 for Signing Plan.
Sta. 22+00 to Sta. 25+00.

FRONT OF SDWK. COORDINATE LIST		
POINT	NORTH	EAST
522 PC	26,224.4699	16,480.3686
523 PT	26,238.3424	16,467.1185
524 PC	26,265.3043	16,428.3685
525 PT	26,297.2914	16,399.2716
526 PC	26,301.1914	16,397.0729
527 PT	26,328.4909	16,374.7539

⑤ = COORDINATE POINT NO.
SEE SHEET NO. 3 FOR PLAT COORDINATES

- Construct Std. Wheelchair Ramp
- Install Type OMA-3 (End of Roadway Marker)
See Sheet No. 59.

No.	Revision	By	Date
-----	----------	----	------

FONTANA ADDITION-PHASE 1

COVINGTON/FONTANA

STA. 21+00 TO STA. 25+33.02

JAMES L. ARMOUR, P.E. - CITY ENGINEER

CITY OF WICHITA PROJECT NO. 472-84086

Professional Engineering Consultants, P.A.

303 S. TOPEKA • WICHITA, KANSAS 67202

316-262-2691 • FAX 316-262-3003

Designed by BDB, BLB
Drawn by BJS

Job No. 35-04485-000
Date September 2004

Sheet 14 of 101

Sheet 03-14-2006 11:08:56 AM by BJS
 Plot Date 12-03-14-2006 11:08:19 AM by JMU
 C:\2004\04485\000\51021-24