

C CURVE DATA							
A=59°25'6" D=38°11'49.9" R=150.00' L=155.56' T=85.59' E=22.7'							
CURVE DATA BASED ON C radius Δ/2=29°42'33"							
C STATION	C ARC LENGTH	FACE CURB LENGTH		CHORD LENGTH		DEFLECTION ANGLE	C TOTAL DEFLECTION
		LEFT CURB	RIGHT CURB	8' OFF LEFT FACE CURB	8' OFF RIGHT FACE CURB		
26+44.37						0°00'00.0"	0°00'00.0"
26+50.00	5.63'	5.10'	6.16'	4.80'	6.46'	01°04'30.9"	01°04'30.9"
26+75.00	25.00'	22.67'	27.33'	21.31'	28.63'	04°46'28.7"	05°50'59.7"
27+00.00	25.00'	22.67'	27.33'	21.31'	28.63'	04°46'28.7"	10°37'28.4"
27+25.00	25.00'	22.67'	27.33'	21.31'	28.63'	04°46'28.7"	15°23'57.2"
27+50.00	25.00'	22.67'	27.33'	21.31'	28.63'	04°46'28.7"	20°10'25.9"
27+75.00	25.00'	22.67'	27.33'	21.31'	28.63'	04°46'28.7"	24°56'54.6"
27+99.93	24.93'	22.60'	27.25'	21.25'	28.55'	04°45'40.6"	29°42'33"
TOTAL	155.56'	141.04'	170.08'				

Defl./ft. = 11.459156 min.

WATER VALVE BOX ELEVATIONS			
STREET	STATION	OFFSET	PROPOSED ELEVATION
LONDON CIRCLE	25+00.00	39.73' LL	180.1
LONDON CIRCLE	27+54.93	22.0' RL	178.5

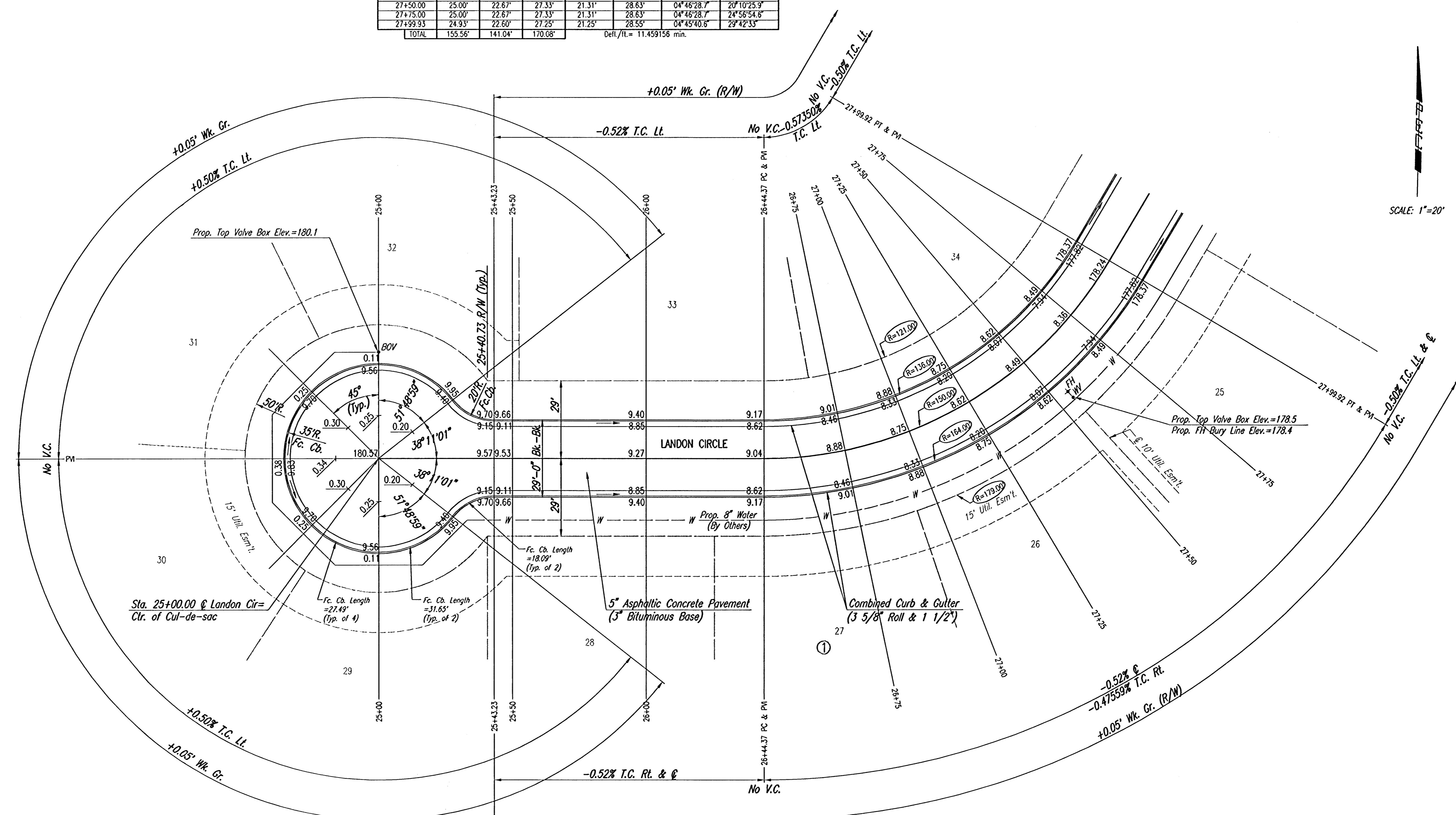

Sta. 25+00.00 @ Landon Cir =
Ctr. of Cul-de-sac

5" Asphaltic Concrete Pavement
(3" Bituminous Base)

Combined Curb & Gutter
(3 5/8" Roll & 1 1/2")

NOTE: THIS STREET TO BE CONSTRUCTED WITH
ROLL-TYPE CURB. TOP OF CURB ELEVATIONS
GIVEN ARE FOR FULL HEIGHT CURB.

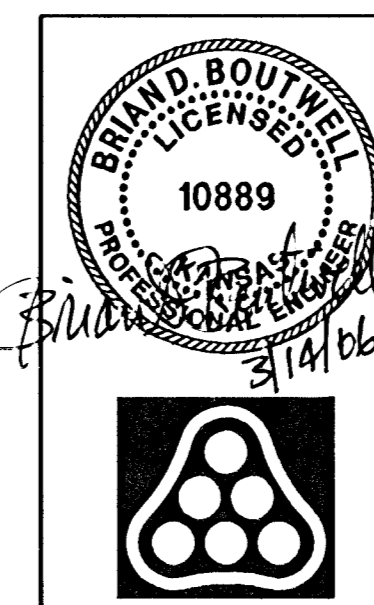

No.	Revision	By	Date
	FONTANA ADDITION-PHASE 1		
LONDON CIRCLE			
STA. 25+00.00 TO STA. 27+99.92			
JAMES L. ARMOUR, P.E. - CITY ENGINEER			
CITY OF WICHITA PROJECT NO. 472-84086			
Professional Engineering Consultants, P.A.			
303 S. TOPEKA • WICHITA, KANSAS 67202			
316-262-2691 • FAX 316-262-3003			
Designed by	BOB, BLB	Job No.	35-04485-000
Drawn by	BJS	Date	September 2004
		Sheet	15 of 101

Saved 03-14-2006 9:24:34 AM by JMU
 Plot Scale 1:20 03-14-2006 9:57:48 AM by JMU
 C:\WORK\04485\000\51625-28