

WATER VALVE BOX ELEVATIONS			
STREET	STATION	OFFSET	PROPOSED ELEVATION
LONDON CIRCLE	31+61.83	22.0' RT.	176.4
LONDON CIRCLE	33+67.09	23.48' RT.	176.8

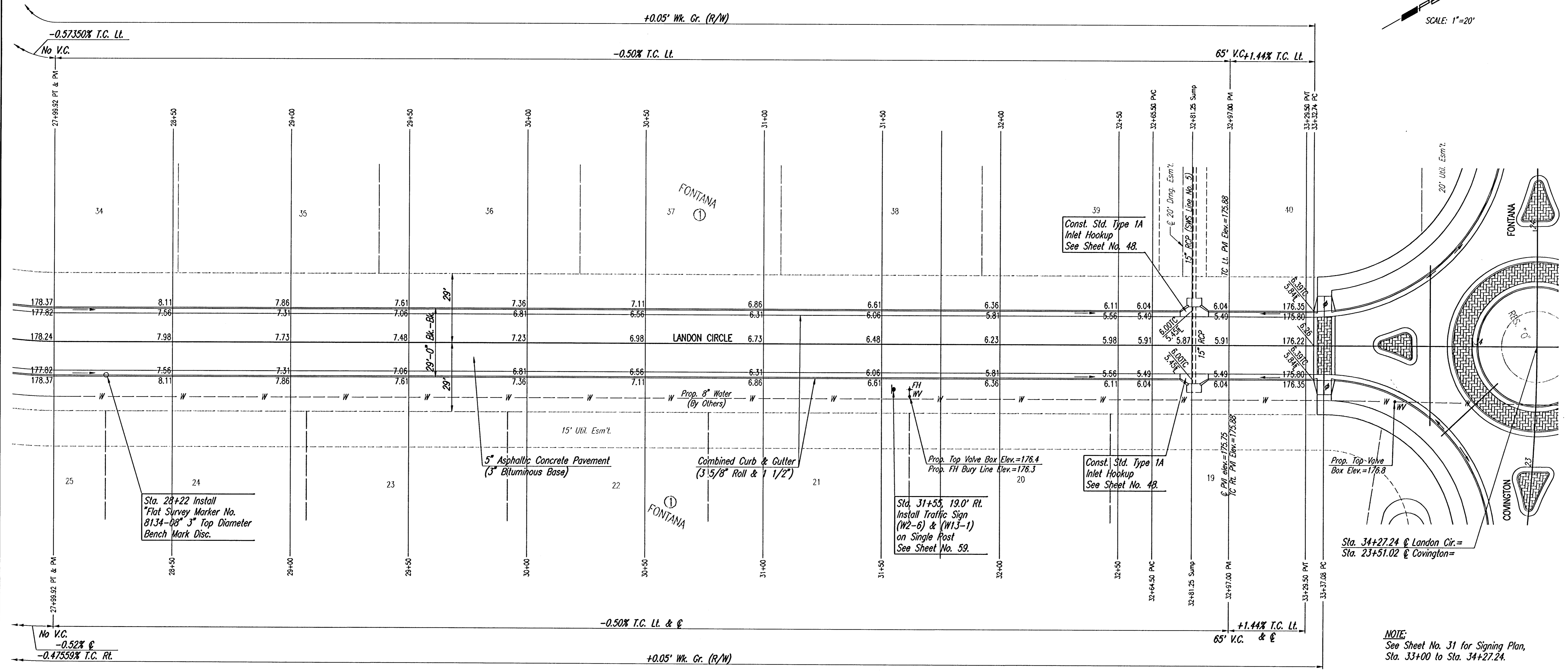
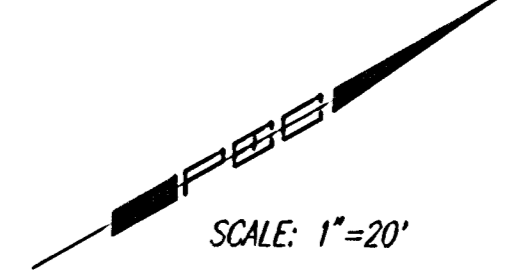

Sta. 28+22 Install
Flat Survey Marker No.
8134-08 3" Top Diameter
Bench Mark Disc.

Sta. 31+55, 19.0' Rt.
Install Traffic Sign
(W2-6) & (W13-1)
on Single Post
See Sheet No. 59.

Sta. 34+27.24 @ London Cir.=
Sta. 23+51.02 @ Covington=

NOTE:
See Sheet No. 31 for Signing Plan,
Sta. 33+00 to Sta. 34+27.24.

Construct Std. Wheelchair Ramp

Sheet 01-14-2006 9:13:50 AM by JML
 Plot Scale: 1"=20' 03-14-2006 9:56:58 AM by JML
 D:\2004\04485\000\STR02-34

NOTE: THIS STREET TO BE CONSTRUCTED WITH
ROLL-TYPE CURB. TOP OF CURB ELEVATIONS
GIVEN ARE FOR FULL HEIGHT CURB.

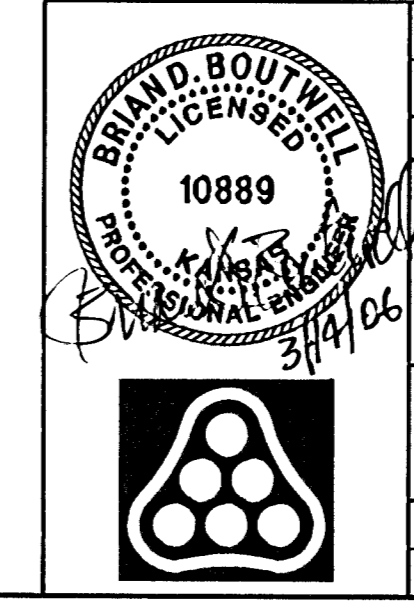

No.	Revision	By	Date
FONTANA ADDITION-PHASE 1 LONDON CIRCLE STA. 27+99.92 TO STA. 34+27.24 JAMES L. ARMOUR, P.E. - CITY ENGINEER CITY OF WICHITA PROJECT NO. 472-84086			
Professional Engineering Consultants, P.A. 303 S. TOPEKA • WICHITA, KANSAS 67202 316-262-2691 • FAX 316-262-3003			
Designed by	BDB, BLB	Job No.	35-04485-000
Drawn by	BJS	Date	September 2004
			Sheet 16 of 101