

WATER VALVE BOX ELEVATIONS			
STREET	STATION	OFFSET	PROPOSED ELEVATION
COVINGTON	84+67.39	25.0' LL	172.1

SCALE: 1"=20'

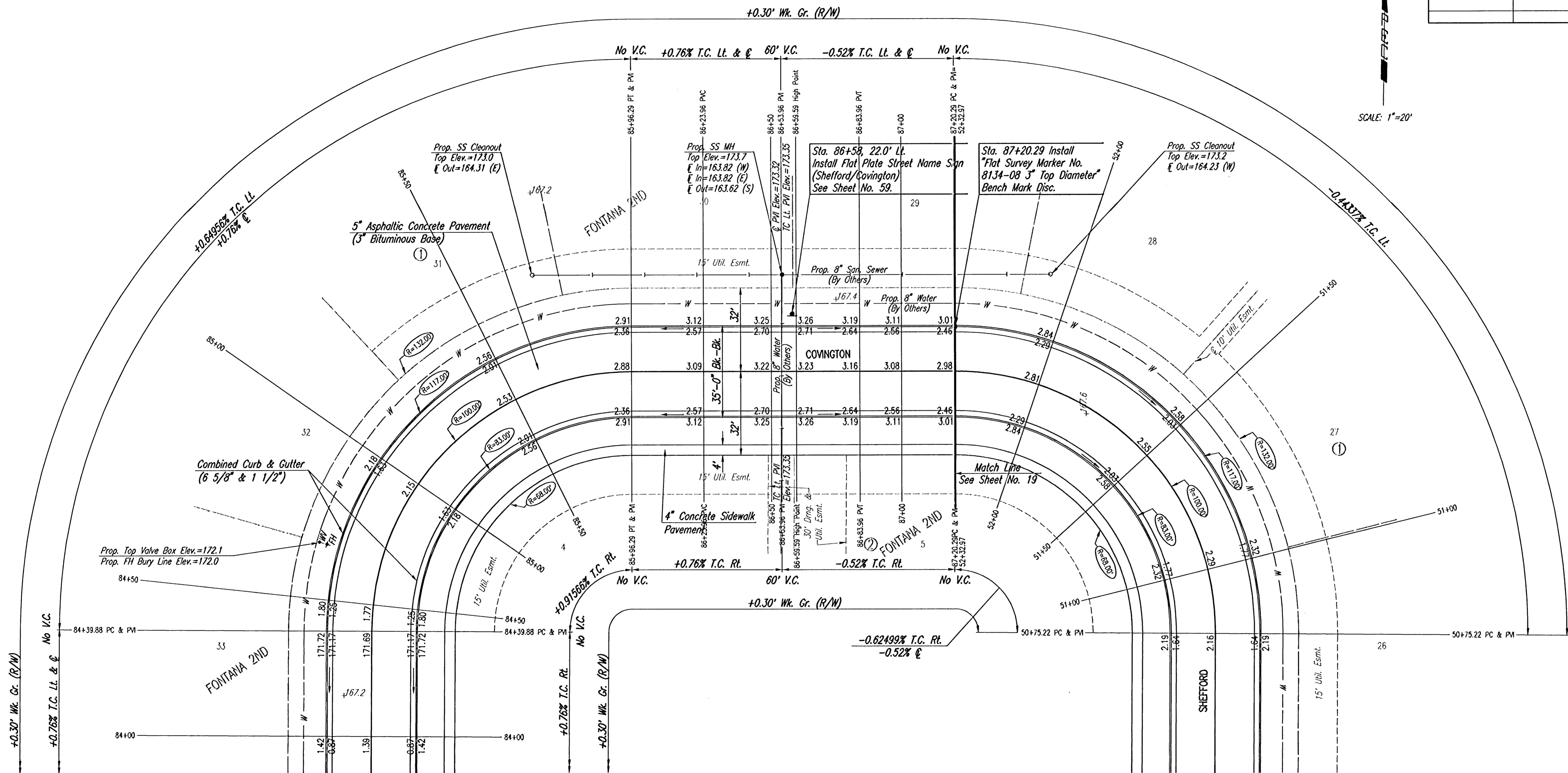

② CURVE DATA
 $A=89^{\circ}17'18''$ $D=37'17''44.8''$ $R=100.00'$ $L=156.41'$ $I=99.33'$ $E=40.25'$
 CURVE DATA BASED ON \odot radius $d/2=44^{\circ}48'31.5''$

② STATION	② ARC LENGTH	FACE CURB LENGTH		CHORD LENGTH		DEFLECTION ANGLE	② TOTAL DEFLECTION
		LEFT CURB	RIGHT CURB	8' OFF LEFT FACE CURB	8' OFF RIGHT FACE CURB		
84+39.88						0°00'00.0"	0°00'00.0"
84+50.00	10.12'	11.84'	8.40'	12.84'	7.59'	02°53'57.0"	02°53'57.0"
84+75.00	25.00'	29.25'	20.75'	31.17'	18.70'	07°09'43.1"	10°03'40.1"
85+00.00	25.00'	29.25'	20.75'	31.17'	18.70'	07°09'43.1"	17°13'23.3"
85+25.00	25.00'	29.25'	20.75'	31.17'	18.70'	07°09'43.1"	24°23'06.4"
85+50.00	25.00'	29.25'	20.75'	31.17'	18.70'	07°09'43.1"	31°32'49.5"
85+75.00	25.00'	29.25'	20.75'	31.17'	18.70'	07°09'43.1"	38°42'32.8"
85+96.29	21.29'	24.91'	17.67'	26.56'	15.34'	05°05'56.9"	44°48'31.5"
TOTAL	156.41'	183'	129.82'				

Defl./L = 17.188734 min.

SEE SHEET 19 FOR ② CURVE DATA TABLE (P.C. STA. 87+20.29=P.T. STA. 52+32.97)

Source: 05-13-2006 4:05:44 PM by BJS
 PLOT: 05-13-2006 4:05:44 PM by BJS
 01:20:00 04:48:31.5"

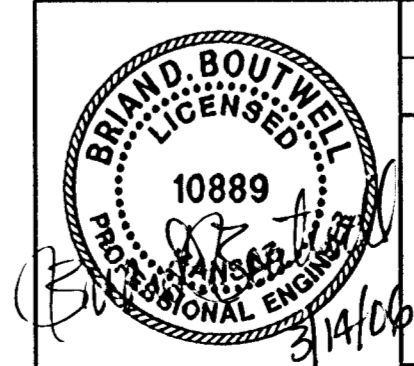

No.	Revision	By	Date
FONTANA ADDITION-PHASE 1 COVINGTON/SHEFFORD STA. 84+39.88 TO STA. 87+20.29 JAMES L. ARMOUR, P.E. - CITY ENGINEER CITY OF WICHITA PROJECT NO. 472-84086			
Professional Engineering Consultants, P.A. 303 S. TOPEKA • WICHITA, KANSAS 67202 316-262-2691 • FAX 316-262-3003			
Designed by	BDB, BLB	Job No.	35-04485-000
Drawn by	BJS	Date	September 2004
			Sheet 21 of 101