

SECTION A-A

GENERAL NOTES  
BRICK PAVEMENT

1. CONCRETE PAVING BRICK SHALL BE 2 3/8" MIN. THICKNESS AND MEET OR EXCEED ASTM C-936-82. PAVING STONES TO BE "HOLLAND STONE" IN THE ANTIQUE RED COLOR AS MANUFACTURED BY PAVESTONE CO., OR APPROVED EQUAL. STONES SHALL BE LAID IN A HERRINGBONE PATTERN.
2. SAND BEDDING SHALL MEET THE CITY'S REQUIREMENTS FOR FINE AGGREGATE. AN UNCOMPACTED SAND LAYING COURSE SHALL BE SPREAD EVENLY OVER THE AREA TO BE PAVED AND THEN SCREED TO A LEVEL OF APPROXIMATELY 1" THICKNESS. ONCE SCREED AND LEVELED TO THE DESIRED ELEVATION, THE SAND LAYING COURSE SHALL NOT BE DISTURBED IN ANY WAY.
3. THE PAVING BRICK SHALL BE INSTALLED PERPENDICULAR AND PARALLEL TO THE MAJOR AXIS OF THE CROSSWALK OR AREA BEING PAVED. STONES SHALL BE PLACED WITH THE CHAMFERED SIDE UP, AND JOINT SPACES KEPT UNIFORM APPROXIMATELY 1/8" THICK. THE CAPS AT THE EDGE OF THE PAVED SURFACE SHALL BE FILLED WITH STONES CUT TO FIT. CUTTING SHALL BE ACCOMPLISHED TO LEAVE A CLEAN EDGE TOWARD THE TRAFFIC SURFACE, USING A MASONRY SAW. WHENEVER POSSIBLE, NO CUTS SHOULD RESULT WITH A PAVER LESS THAN ONE-THIRD OF ITS ORIGINAL DIMENSION.
4. PAVING BRICK SHALL BE VIBRATED TO THEIR FINAL LEVEL IN THE SAND LAYING COURSE BY TWO OR THREE PASSES OF A VIBRATING COMPACTOR CAPABLE OF 3000 TO 5000 POUNDS COMPACTION FORCE WITH THE SURFACE CLEAN AND JOINTS OPEN.
5. AFTER VIBRATION, CLEAN CONCRETE SAND SHALL BE SPREAD OVER THE PAVING STONE SURFACE, ALLOWED TO DRY, AND VIBRATED INTO JOINTS WITH ADDITIONAL PASSES OF THE PLATE VIBRATOR SO AS TO COMPLETELY FILL THE JOINTS. A LIGHT COATING OF SAND SHALL BE SWEEPED OVER THE COMPLETED SURFACE AND LEFT TO WEATHER IN.
6. PLACEMENT AND COMPACTION OF SAND FOR INSTALLATION OF THE PAVING BRICK IS SUBSIDIARY TO THE PAVING BRICK ITEM. PLACEMENT OF THE 5" REINFORCED CONCRETE PAVEMENT UNDER ALL PAVING BRICK AREAS, INCLUDING THE 18" CONCRETE HEADER AT CROSS WALK, WILL BE PAID FOR AS "REINFORCED CONCRETE PAVEMENT (5)".

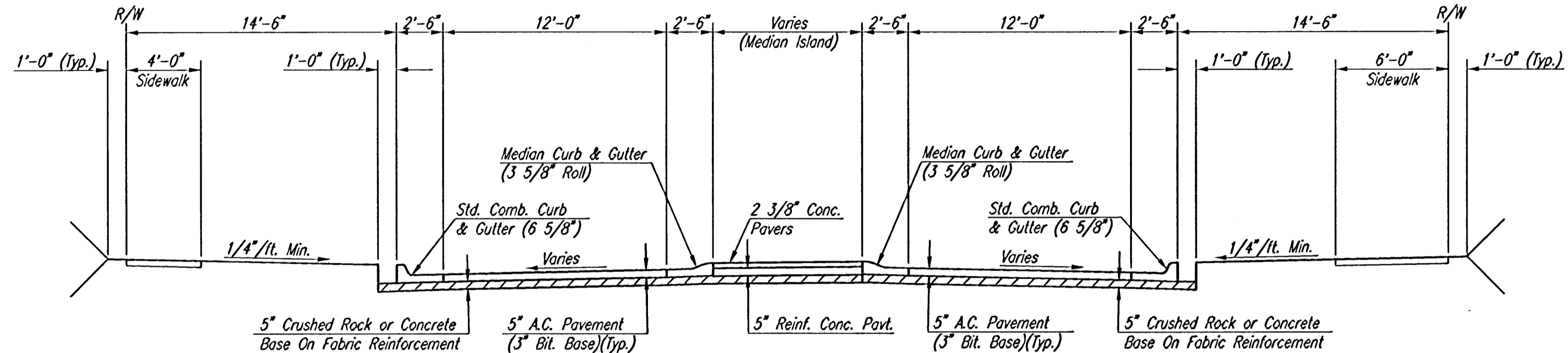

SECTION B-B

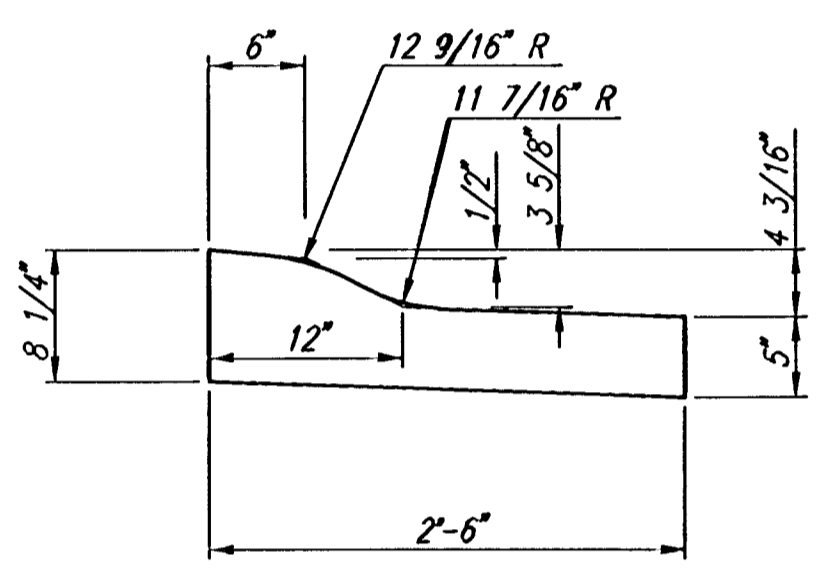

MEDIAN CURB & GUTTER  
(3 5/8" ROLL)

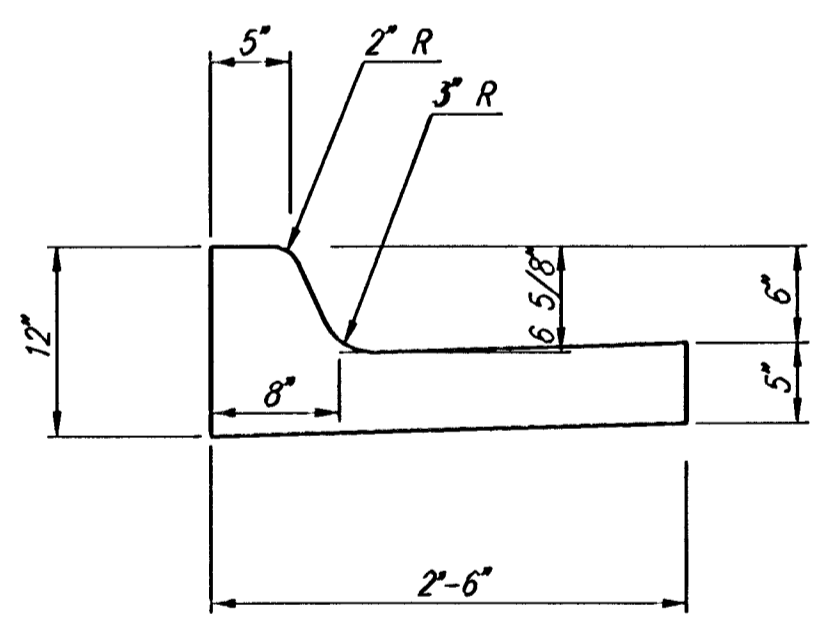

COMBINED CURB & GUTTER  
(6 5/8")

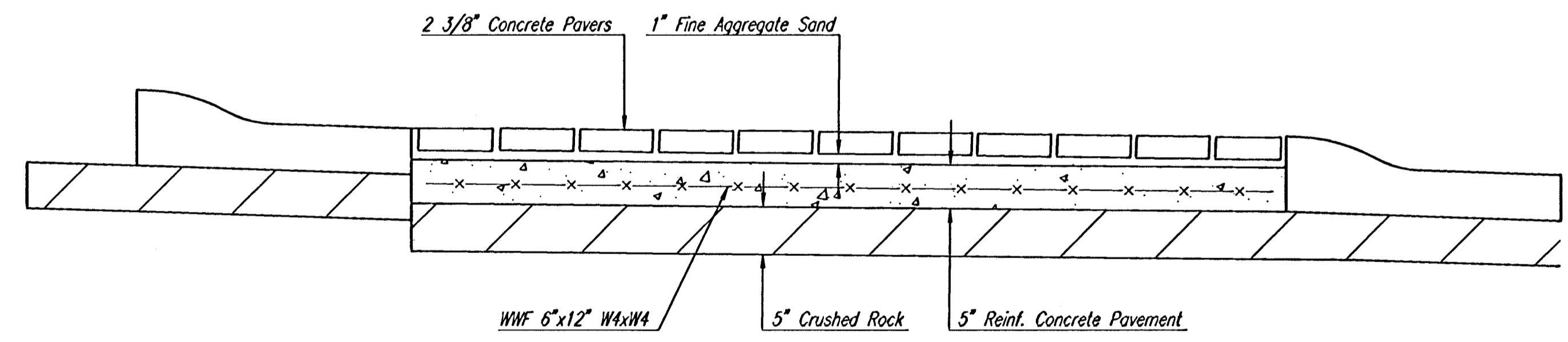

SECTION THRU 8'-0" TRUCK APRON

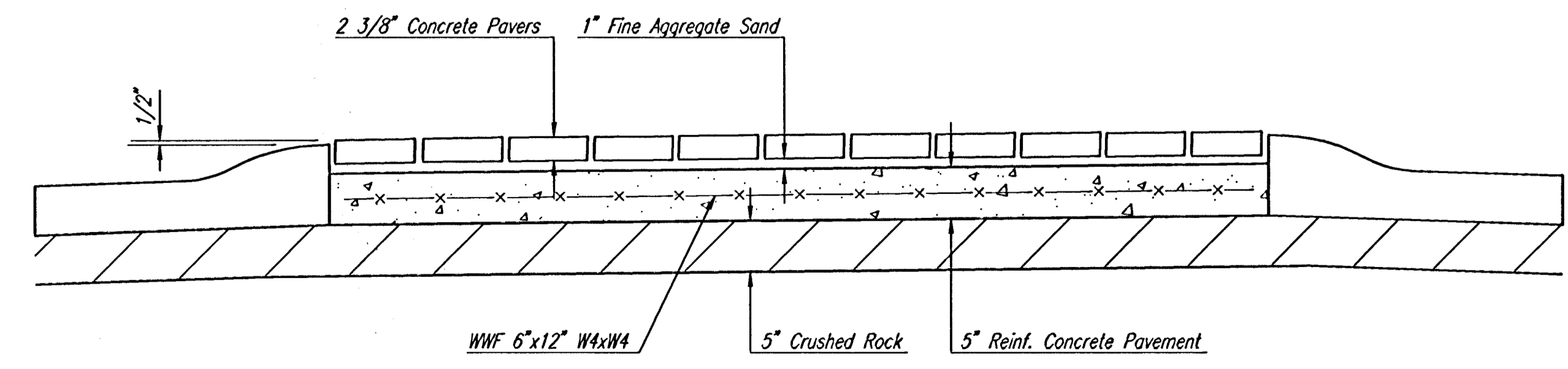

SECTION THRU MEDIAN ISLAND

Saved: 03-14-2006 9:51:48 AM by JMU  
 Plot Scale: 1:10 03-14-2006 10:26:25 AM by JMU  
 C:\2001\04485\000\ROUNDABOUT\_TPSPEC

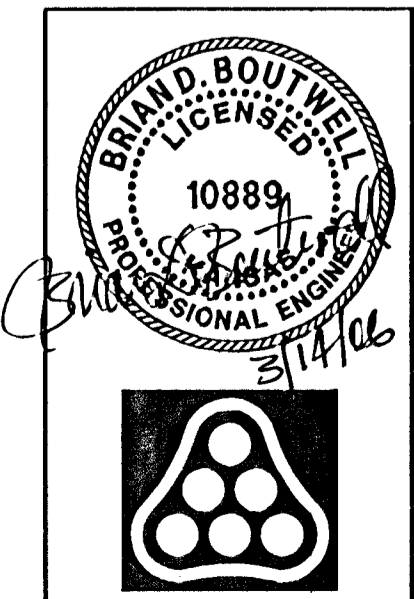

No.	Revision	By	Date
FONTANA ADDITION-PHASE 1			
<b>ROUNDABOUT TYPICAL SECTIONS</b>			
JAMES L. ARMOUR, P.E.- CITY ENGINEER CITY OF WICHITA PROJECT NO. 472-84086 <b>Professional Engineering Consultants, P.A.</b> 303 S. TOPEKA • WICHITA, KANSAS 67202 316-262-2691 • FAX 316-262-3003			
Designed by	BDB, BLB	Job No.	35-04485-000
Drawn by	BJS	Date	September 2004
			Sheet 32 of 101