

PLAN  
 CHECKED  
 CHECKED  
 BY  
 DATE

PROFILE  
 CHECKED  
 CHECKED  
 BY  
 DATE

Sta. 8+66.0 SWS Line No. 1  
 Begin 24" RCP Construction  
 Install 134.0 L.F. 24" RCP (SE)  
 (Including End Section)

Install 57 L.F.  
 Excavatable Flowable  
 Fill to Elev. 171.5

CAUTION !!!  
 Proposed 8" San. Sewer  
 City of Wichita

Sta. 10+00.0 SWS Line No. 1  
 Special Area Inlet  
 Top Elev.=171.80

Install 22 S.Y.  
 Light Stone Riprap  
 See Sheet No. 52.

POND #1  
 Static Pool=170.0  
 DWS<sub>100</sub>=170.8  
 RESERVE "F"

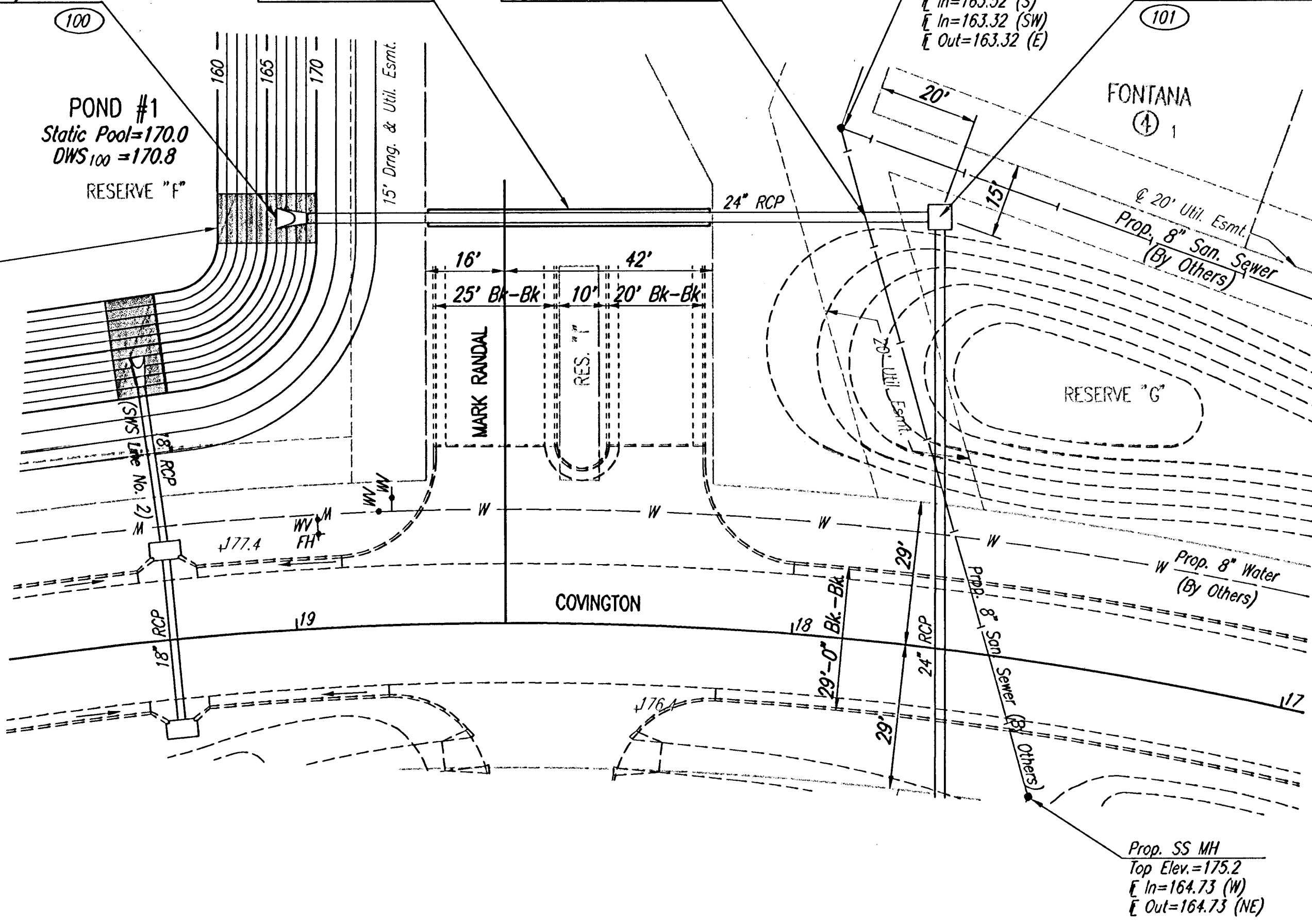

COORDINATE LIST		
POINT	NORTH	EAST
100	26,124.3800	16,664.0055
101	25,999.4721	16,712.5375

(100) = COORDINATE POINT NO.  
 SEE SHEET NO. 4 FOR PLAT COORDINATES

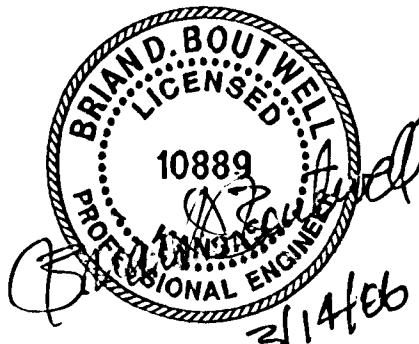
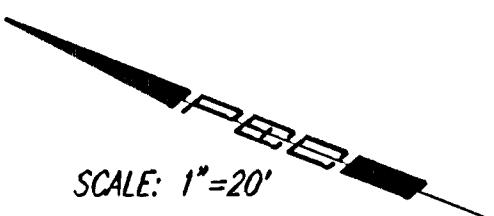

Sheet 33 of 101  
 Date: 03-14-2006 6:54:34 AM by BUS  
 Plot Size: 17.00 x 11.00  
 City: 303A1644851000.SWSLINE-1

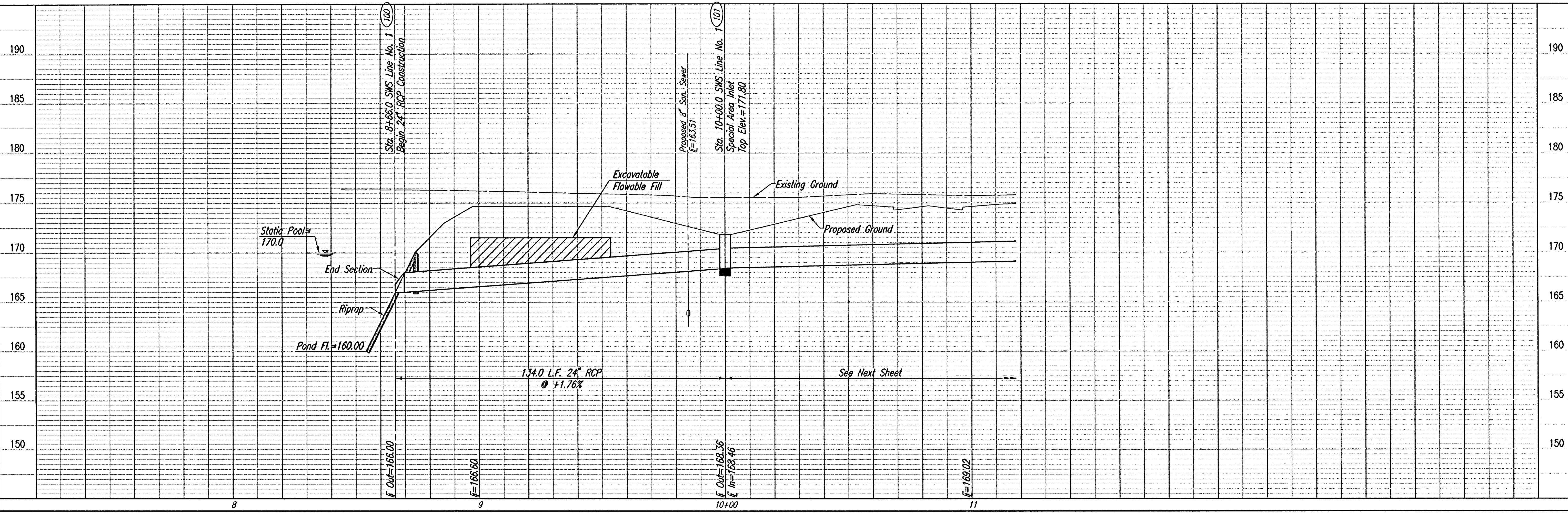

FONTANA ADDITION-PHASE 1  
**SWS LINE NO. 1**  
 JAMES L. ARMOUR, P.E.-CITY ENGINEER  
 CITY OF WICHITA PROJECT NO. 472-84086

Professional Engineering Consultants, P.A.  
 303 S. TOPEKA - WICHITA, KANSAS 67202  
 316-262-2691 • FAX 316-262-3003

Designed By: BLB, BOB  
 Drawn By: BUS  
 Job No.: 35-04485-000  
 Date: SEPTEMBER, 2004