

PLAN AND PROFILE OF PROPOSED

McCORMICK AVENUE STREET IMPROVEMENT FROM LEONINE TO K-42

GENERAL NOTES

UNLESS SHOWN OR STATED OTHERWISE ON THESE DRAWINGS, MATERIALS AND CONSTRUCTION SHALL BE IN ACCORDANCE WITH CITY OF WICHITA CONCRETE PAVEMENT AND ASPHALTIC CONCRETE PAVEMENT SPECIFICATIONS.

CONTRACTOR WILL BE REQUIRED TO PROVIDE A MINIMUM ADVANCE NOTICE OF SEVENTY-TWO (72) HOURS TO UTILITY COMPANIES PRIOR TO STARTING ANY EXCAVATION AS FOLLOWS:

1-800-344-7233
KANSAS ONE-CALL OR 687-2470 (LOCAL WICHITA)

THE CONTRACTOR MUST NOTIFY THE FOLLOWING IN CASE OF AN EMERGENCY:

SBC (TELEPHONE) 800-870-8390
COX COMMUNICATIONS (CABLE) 282-0661
WESTAR (ELECTRIC) 383-8600
KANSAS GAS SERVICE (GAS) 832-3101
CITY OF WICHITA WATER & SEWER MAINT. 262-6000
AQUILA (GAS) 946-0098

THE CONTRACTOR SHALL BE RESPONSIBLE FOR PRESERVING PROPERTY IRONS. THE CONTRACTOR WILL BE REQUIRED TO RE-ESTABLISH ANY PROPERTY IRONS WHICH ARE DAMAGED OR DESTROYED BY HIS CONSTRUCTION OPERATIONS. SUCH IRONS SHALL BE RE-ESTABLISHED BY A LICENSED LAND SURVEYOR IN ACCORDANCE WITH STATE LAWS.

EXISTING UTILITIES AND THEIR LOCATIONS, AS SHOWN ON THE PLANS REPRESENT THE BEST INFORMATION OBTAINABLE FOR DESIGN. LOCATION INFORMATION HAS BEEN OBTAINED FROM THE VARIOUS UTILITY COMPANIES AND IS EITHER FROM COMPANY RECORD DRAWINGS OR COMPANY PROVIDED FIELD LOCATIONS. THE PLAN LOCATIONS SHOWN ARE NOT GUARANTEED. ADDITIONAL EXISTING UTILITIES MAY ALSO BE ENCOUNTERED.

RUBBLE FROM THE REMOVAL OF MISCELLANEOUS STRUCTURES AND EXCESS EXCAVATION WHICH IS TO BE WASTED SHALL BE DISPOSED OF ON SITES TO BE PROVIDED BY THE CONTRACTOR. THESE SITES SHALL BE APPROVED BY THE ENGINEER AS TO SUITABILITY, APPEARANCE AND SITE LOCATION. LOCATIONS THAT, IN THE OPINION OF THE ENGINEER, WILL LEAVE AN UNSIGHTLY APPEARANCE WILL NOT BE APPROVED. ALL DISPOSAL SITES MUST BE APPROVED BY THE KANSAS DEPARTMENT OF HEALTH AND ENVIRONMENT. MATERIAL EITHER STOCKPILED OR DISPOSED OF IN A FLOOD PLAIN WOULD REQUIRE A KANSAS STATE BOARD OF AGRICULTURE PERMIT. ANY MATERIAL DUMPED IN WATERS OF THE UNITED STATES OR WETLANDS IS SUBJECT TO U.S. CORPS OF ENGINEERS PERMITTING REGULATIONS. ANY MATERIAL BURIED OR STOCKPILED BEYOND APPROVED CONSTRUCTION LIMITS WOULD REQUIRE ADDITIONAL ARCHAEOLOGICAL INVESTIGATIONS UNLESS BURIED IN A PREVIOUSLY APPROVED BORROW LOCATION.

A SAW CUT OF AT LEAST ONE-HALF THE DEPTH OF THE EXISTING SURFACE COURSES OR ONE-FOURTH THE DEPTH OF THE EXISTING TOTAL PAVEMENT THICKNESS SHALL BE PROVIDED AT LOCATIONS WHERE PROPOSED CONSTRUCTION ABUTS AN EXISTING SURFACE OR PAVEMENT FOR WHICH PARTIAL REMOVAL OF THAT SURFACE OR PAVEMENT IS REQUIRED. SAW JOINT TO FACILITATE REMOVAL WITHIN THREE (3) FEET OF EXISTING JOINTS WILL NOT BE PERMITTED AND FOR SUCH INSTANCES THE LIMITS OF REMOVAL SHALL EXTEND TO THE EXISTING JOINT.

CONTRACTOR SHALL SEED ALL DISTURBED AREAS. COST SHALL BE CONSIDERED SUBSIDIARY TO SITE RESTORATION. CONTRACTOR SHALL INSTALL 6,700 S.Y. EROSION CONTROL MAT AT BACK OF ALL NEW CURB.

ALL TREES TO BE REMOVED ARE MARKED . COSTS SHALL BE PAID AS SITE CLEARING AND RESTORATION.

CONNECTION OF EXISTING STORM SEWERS, SANITARY SEWERS OR DRAINAGE STRUCTURES TO PROPOSED CONDUITS AND/OR STRUCTURES SHALL INCLUDE ALL MATERIAL, EQUIPMENT AND LABOR. THESE CONNECTIONS SHALL NOT BE PAID FOR DIRECTLY, BUT SHALL BE CONSIDERED SUBSIDIARY TO THE VARIOUS PROPOSED CONDUITS OR STRUCTURES. THIS WORK SHALL BE AS DIRECTED BY THE ENGINEER AND SHALL BE SUBSIDIARY TO THE SPECIFIC STRUCTURE BID ITEMS.

ELEVATIONS ARE IN CITY OF WICHITA DATUM.

SELECT SOIL (TOPSOIL SHALL BE PLACED AT A MINIMUM DEPTH OF 6" OR AS SPECIFIED AT ALL LOCATIONS WITHIN THE RIGHT-OF-WAY OUTSIDE OF PAVEMENT. THE FINISHED GRADE INDICATES THE SURFACE ELEVATION AFTER THE PRESCRIBED SELECT SOIL (TOPSOIL) THICKNESS HAS BEEN PLACED.

ALL GRAVEL OR OTHER SIMILAR DEBRIS LARGER THAN 1/2 INCH IN DIAMETER SHALL BE RAKED UP AND REMOVED DURING FINAL GRADE PREPARATION.

WHERE OFFSITE SELECT SOIL IS NEEDED, IT SHALL BE FERTILE NATURAL TOPSOIL, TYPICAL OF THE LOCALITY, OBTAINED FROM WELL DRAINED AREAS. STOCKPILED TOPSOIL MAY BE USED. IT SHALL BE WITHOUT ADMIXTURE OF SUBSOIL OR SLAG AND SHALL BE FREE OF STONES, LUMPS, STICKS, PLANTS, OR THEIR ROOTS, TOXIC SUBSTANCES OR OTHER EXTRANEIOUS MATTER THAT MAY BE HARMFUL TO PLANT GROWTH OR WOULD INTERFERE WITH FUTURE MAINTENANCE. TOPSOIL PH RANGE SHALL BE 5.5 TO 7.0. TOPSOIL SHALL BE APPROVED BY THE LANDSCAPE ARCHITECT PRIOR TO PLACEMENT.

EQUIPMENT AND CONSTRUCTION MATERIALS SHALL REMAIN OUT OF AND AWAY FROM THE DRIP LINES OF TREES THAT ARE TO REMAIN SO AS TO NOT COMPACT THE ROOT ZONE OR DAMAGE THE TREE. CHEMICAL SPILL DAMAGE SHALL BE PREVENTED BY FILLING GAS TANKS, CLEANING TOOLS & REPAIRING EQUIPMENT WELL OUTSIDE DRIP LINES.

PAVEMENT UNDERDRAIN IS TO BE INSTALLED ON A MINIMUM SLOPE OF 0.5% IN CRESTS AND SAGS OF VERTICAL CURVES WHERE THE STREET SLOPE MAY BE LESS THAN 0.5% THE DEPTH OF THE UNDERDRAIN PIPE IS TO BE ADJUSTED AS REQUIRED TO SATISFY THE MINIMUM SLOPE REQUIREMENT.

NEW STORM SEWER INSTALLED UNDER PROPOSED PAVEMENTS SHALL BE PROTECTED FROM CONSTRUCTION TRAFFIC DURING CONSTRUCTION OPERATIONS.

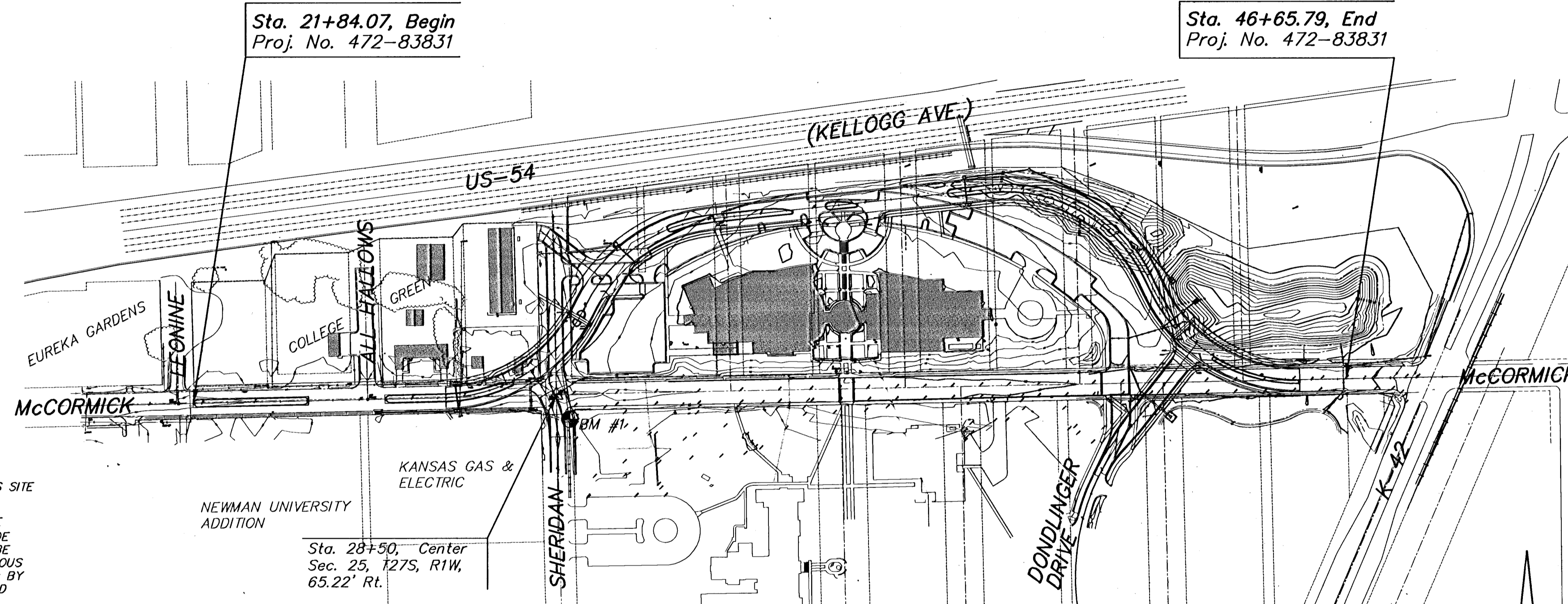

UNLESS INDICATED OTHERWISE ON THE PLANS, THE CITY OF WICHITA WILL SHUT OFF WATER SERVICES IN CONFLICT AND REMOVE WATER METERS, VAULT, LID AND SETTER. FIRE HYDRANTS WILL BE RELOCATED BY THE CITY, AS SHOWN, PRIOR TO CONSTRUCTION. THE CONTRACTOR IS RESPONSIBLE FOR COORDINATING SERVICE REMOVAL.

MANHOLE ELEVATION ADJUSTMENTS LESS THAN 12" SHALL BE ACHIEVED BY ADDING OR REMOVING THE REQUIRED THICKNESSES OF BRICK AND/OR GROUT RINGS. MANHOLES RECEIVING NEW (WIDER) RINGS AND LIDS SHALL BE ADJUSTED TO CONFORM TO THE INCREASED WIDTH, IF NECESSARY.

INSTALL IRRIGATION SLEEVES AS SHOWN ON THE DRAWINGS. LOCATION OF SLEEVES MAY BE ADJUSTED IN THE FIELD TO BETTER FACILITATE THE INSTALLATION AND/OR OPERATION OF THE IRRIGATION SYSTEM AND TO REDUCE THE AMOUNT OF PAVEMENT PATCHING REQUIRED.

EXCESS EXCAVATION THAT IS SUITABLE FOR CONSTRUCTION SHALL BE STOCKPILED IN A LOCATION ON THE NEWMAN UNIVERSITY CAMPUS AS ESTABLISHED BY NEWMAN AND THE CITY. AN ESTIMATED 6,412 C.Y. OF STOCKPILE MATERIAL WILL BE GENERATED DURING CONSTRUCTION PHASE I. UPON THE COMPLETION OF PHASE IV, AN ESTIMATED 2,097 C.Y. WILL REMAIN TO BE WASTED. THESE ESTIMATED VOLUMES ARE BASED ON THE ASSUMPTION THAT CLAY LINER MATERIAL AND SELECT SOIL MATERIAL FOR MEDIANS WILL BE IMPORTED AND THAT MUCK MATERIAL WILL BE WASTED.

FILL USED IN THE RESTORATION OF THE OLD MCCORMICK ALIGNMENT SHALL BE PAID FOR AS "COMPACTED FILL (90% DENSITY)".

EXISTING IRRIGATION LINES DISTURBED BY CONSTRUCTION WILL BE THE RESPONSIBILITY OF NEWMAN UNIVERSITY.

BENCHMARK

BM #1 SHERIDAN AND MCCORMICK
COW BENCH MARK, SE CORNER OF INTERSECTION.
24.00 FT. EAST OF CENTER LINE.
46.30 FT. SOUTH OF CENTER LINE.
8.50 FT. EAST OF BACK OF CURB.
24.00 FT. SOUTH OF BACK OF CURB
ELEV. = 112.36

SCALE: 1" = 150'

LEGEND

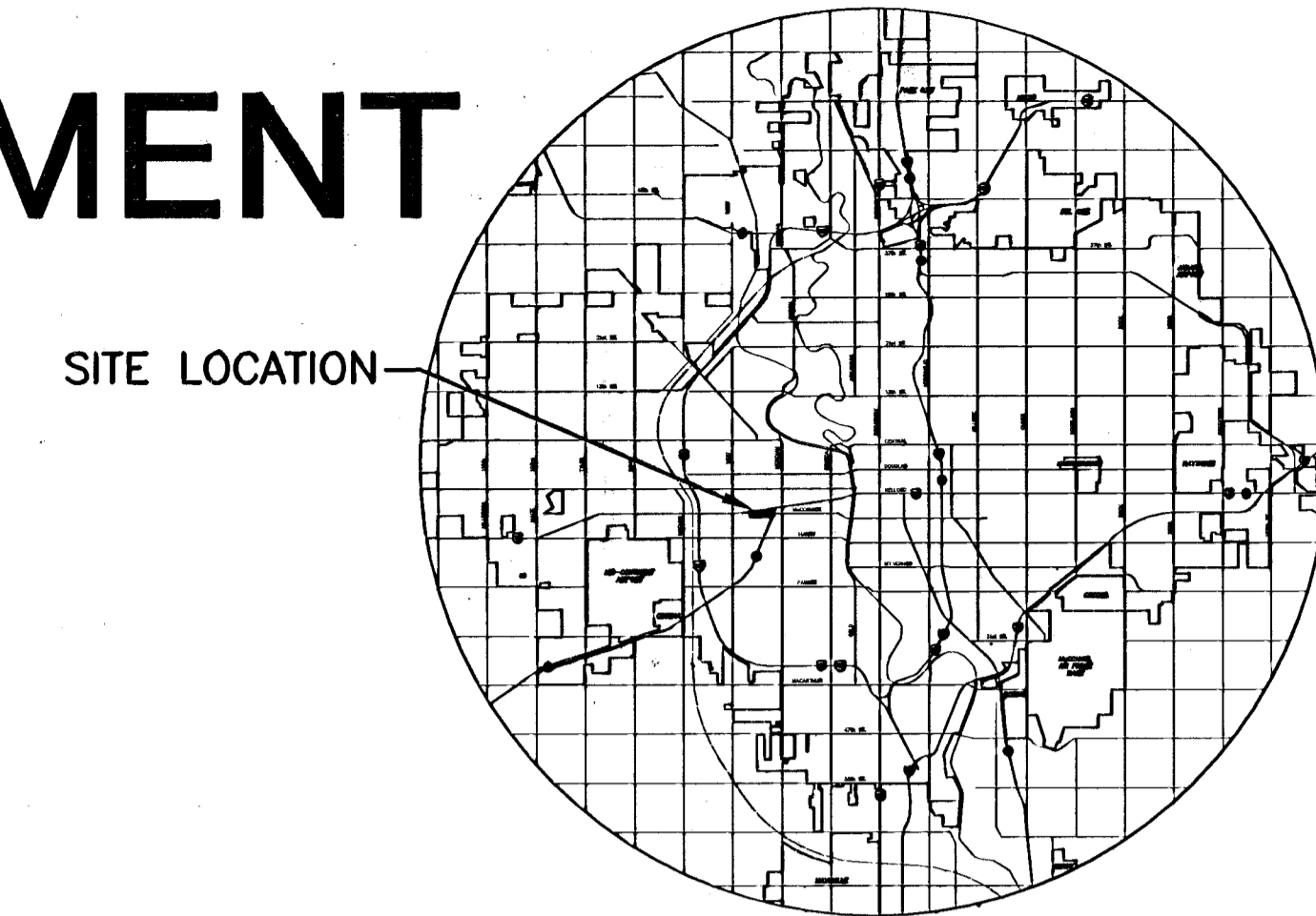

SITE LOCATION

LOCATION MAP

INDEX TO DRAWINGS

SHEET NO	DESCRIPTION
1	TITLE SHEET
2-3	TYPICAL SECTIONS
4-11	PLAN SHEETS
12-16	STORM SEWER PLAN AND PROFILES
17-25	PAVING DETAILS
26-37	STORM SEWER AND DRAINAGE DETAILS
38-39	POND CONSTRUCTION AND RETAINING WALL DETAILS
39A-39B	OLD MCCORMICK ERADICATION PLAN SHEETS
40	MISCELLANEOUS DETAILS
41-44	EROSION CONTROL BMP SHEETS
45-54	LANDSCAPING PLAN AND DETAILS
55-56	STREET LIGHTING PLAN AND DETAILS
57-60	PAVEMENT MARKING AND SIGNING PLAN AND DETAILS
61	CONSTRUCTION SEQUENCE SUMMARY
62-68	TRAFFIC CONTROL PLAN AND DETAILS
69	DRAINAGE SUMMARY SHEET
70-111	CROSS SECTIONS



McCORMICK AVENUE STREET IMPROVEMENT
PROJECT NAME

TITLE SHEET
SHEET TITLE

JRA DESIGN BY.	WNJ DRAWN BY.	JRA CHECKED BY.
AUGUST 2005 DATE	03245 JOB NO.	1 / 111 SHEET OF