

P.C. Sta. 26+65.71
 I. N=1680939.92, E=1636394.27

Note: See sheet 23 for Panel Replacement and full-depth joint Repair details.

P.I. Sta. 28+48.81 (Bk.)=
 P.I. Sta. 28+11.40 (Ahead)
 $\Delta = 62^{\circ}47'40''$
 $T = 183.10'$
 $R = 300.00'$
 $L = 328.79'$
 $E = 51.46'$
 N. C.

Sta. 26+85 McCormick Const.
 Curb Inlet (Type II), 21.70' Lt.
 $L=6'-2\frac{1}{2}''$, $W=3'-4\frac{1}{8}''$
 Inlet Top = 111.39
 See Sht. No. 12 & 30

P.V.I. Elev.=111.45
 No V.C.

Sta. 21+84.07 to Sta. 24+03.62, Const.
 Median Island in existing pavement. Saw Cut and Match Exist. Pavement, 8.00' Lt. & Rt.

Sta. 21+84.07, Begin
 Proj. No.

Sta. 25+49.36 to Sta. 26+65.71, Const.
 Median Island in existing pavement. Saw Cut and Match Exist. Pavement, 8.00' Lt. & Rt.

Sta. 26+69, Lt. Remove and replace a portion of the exist. drive approach as shown with 8" Reinf. Concrete

-0.50%
 (Based on C/L)

P.V.I. Elev.=111.45
 No V.C.

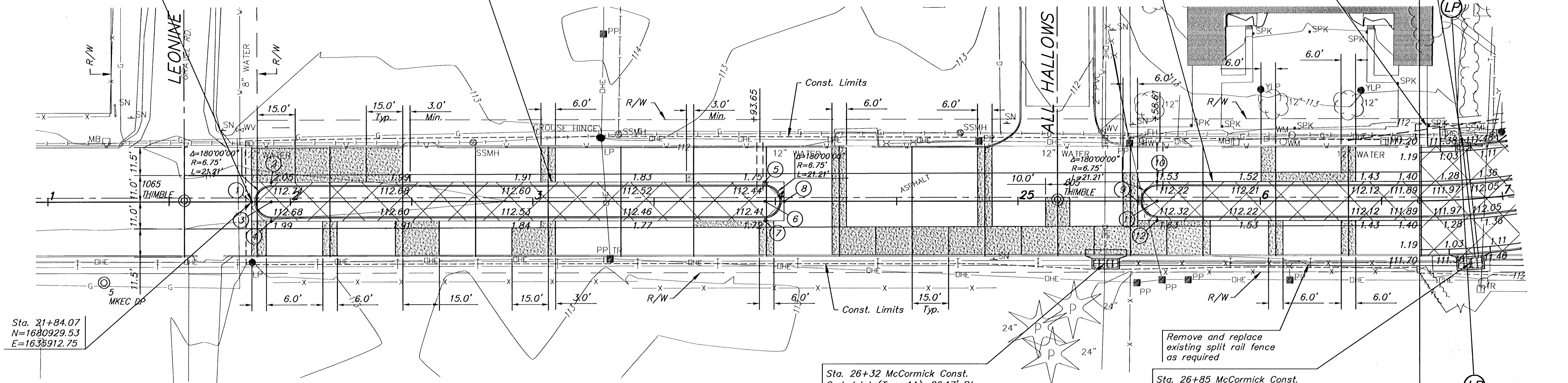

Sta. 21+84.07
 N=1680929.53
 E=1635912.75

Sta. 26+32 McCormick Const.
 Curb Inlet (Type 1A), 26.17' Rt.
 $L=11'-4''$, $W=5'-4''$
 Inlet Top=112.05
 See Sht. No. 12 & 28

Sta. 26+85 McCormick Const.
 Curb Inlet (Type 1A), 26.17' Rt.
 $L=11'-4''$, $W=5'-4''$
 Inlet Top=111.39
 See Sht. No. 12 & 28

-0.50%
 (Based on C/L)

+0.50%
 (Based on C/L)

P.V.I. Elev.=111.45
 No V.C.

C.P. #5 Sta. 21+23.17, 33.11 Rt.
 1. N=1680895.12, E=1635852.60
 2. 5/8" Bar w/red MKEC Cap

UTILITIES

- CATV - Cox Communications (Cable) 262-0661
- E - Westar Energy (Electric) 261-6512
- SWS - City of Wichita Stormwater Utility 268-4071
- SS & W - City of Wichita Water Dept. 262-6000
- T - SBC (Telephone) 800-870-8390

Point No.	MEDIAN LOCATION		Elevation	
	Station	Offset	High Edge	Top Curb
1	21+84.07	0.00' Rt.	112.16	112.83
2	21+92.07	8.00' Lt.	112.05	112.74
3	21+92.07	0.00' Rt.	Radius Point	
4	21+92.07	8.00' Rt.	111.99	112.68
5	23+95.62	8.00' Lt.	111.75	112.44
6	23+95.62	0.00' Rt.	Radius Point	
7	23+95.62	8.00' Rt.	111.72	112.41
8	24+03.62	0.00' Rt.	111.84	112.51
9	25+49.36	0.00' Rt.	111.70	112.37
10	25+57.36	8.00' Lt.	111.53	112.22
11	25+57.36	0.00' Rt.	Radius Point	
12	25+57.36	8.00' Rt.	111.63	112.32

LEGEND

- Drive, Pavement and/or Sidewalk Removal
- Panel Replacement, Partial Panel Replacement, & full-depth joint repair
- Install 2-6" PVC (Sch. 40) Irrigation Sleeves, 2.5' apart extending 2' beyond Back of Curb

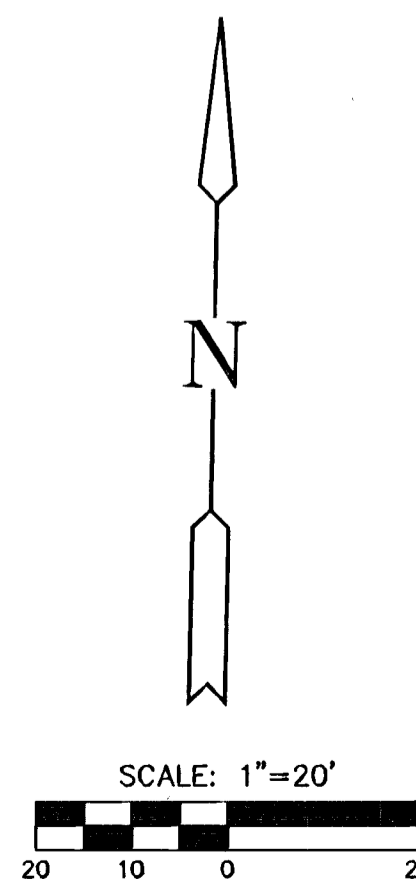

MKEC
ENGINEERING CONSULTANTS
411 N. WEBB ROAD
WICHITA, KS. 67208
314-684-9600

McCORMICK AVENUE STREET IMPROVEMENTS
PROJECT NAME

McCORMICK - STA. 21+00 TO STA. 27+00
SHEET TITLE

JRA DESIGN BY. WNW DRAWN BY. KJS CHECKED BY.

AUGUST 2005 DATE 03245 JOB NO. 4 / 111 SHEET/OF