

P.T. Sta. 45+77.53  
 1. N=1680972.44, E=1638019.71

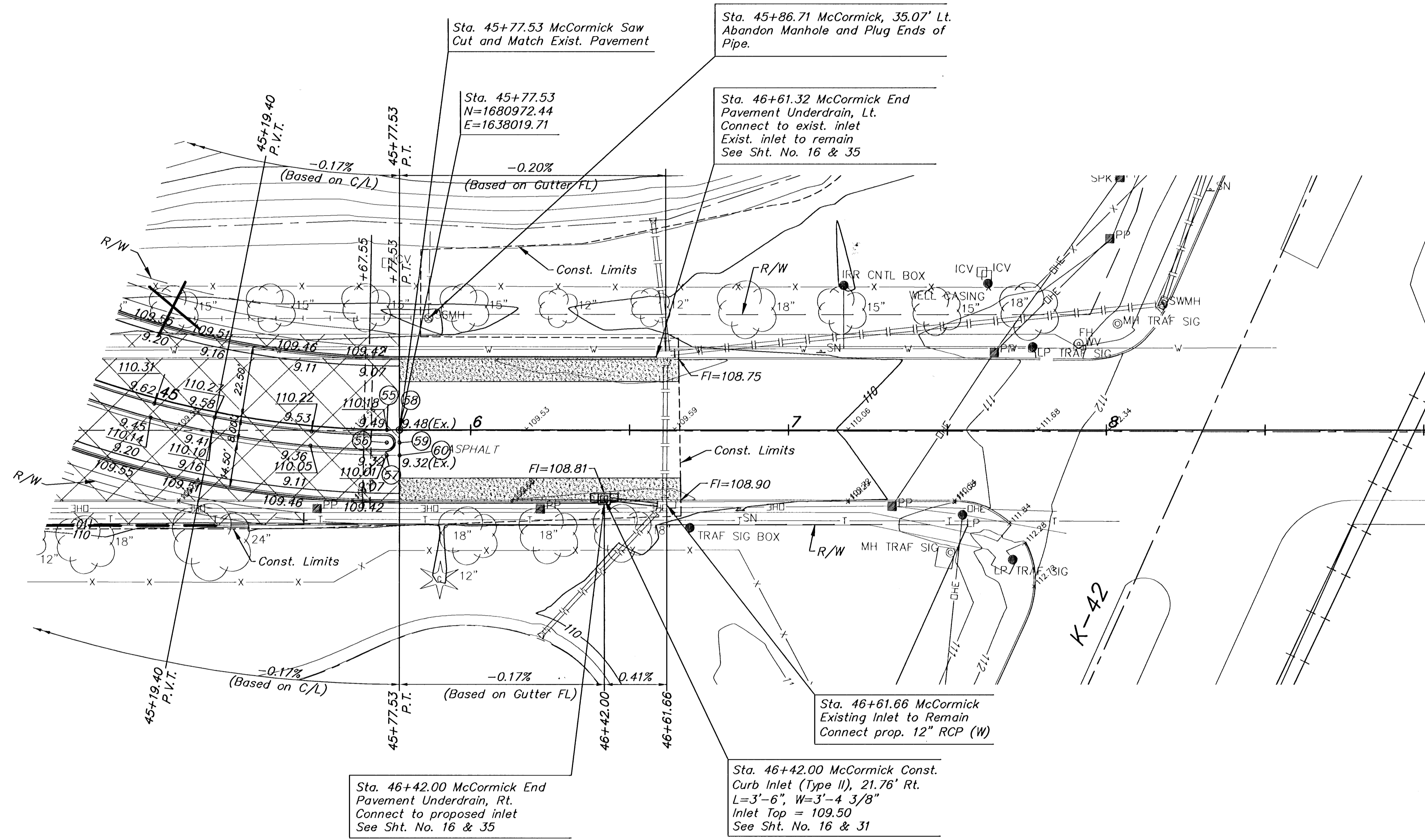
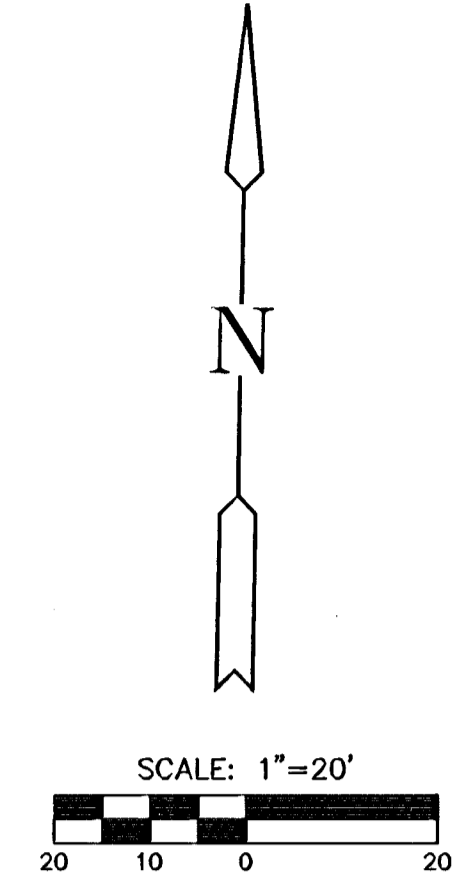

- E 1/4 Cor. Sec. 25, T27S, R1W  
 Thimble at corner  
 1. Chiseled "X" Top of Curb 67.39' NE  
 2. Chiseled "X" Top of Curb 65.75' SE  
 3. Chiseled "X" Top of Curb 89.56' SW  
 4. Chiseled "X" Top of Curb 86.71' NW  
 5. N=1680996.41, E=1639248.71

**UTILITIES**

- CATV - Cox Communications (Cable) 262-0661
- E - Westar Energy (Electric) 261-6512
- SWS - City of Wichita Stormwater Utility 268-4071
- SS & W - City of Wichita Water Dept. 262-6000
- T - SBC (Telephone) 800-870-8390

MEDIAN LOCATION				
Point No.	Station	Offset	Elevation	
55	45+73.59	0.00' Rt.	High Edge	Top Curb
56	45+73.59	4.00' Rt.	109.49	110.18
57	45+73.59	8.00' Rt.	109.32	110.01
58	45+77.53	0.00' Rt.	109.48(Ex.)	
59	45+77.53	4.00' Rt.	109.40(Ex.)	
60	45+77.53	8.00' Rt.	109.32(Ex.)	

**LEGEND**

- Drive, Pavement and/or Sidewalk Removal
- Panel Replacement, Partial Panel Replacement, & full-depth joint repair
- Install 2-6" PVC (Sch. 40) Irrigation Sleeves, 2.5' apart extending 2' beyond Back of Curb

**MCCORMICK AVENUE STREET IMPROVEMENTS**  
PROJECT NAME

**MCCORMICK - STA. 45+00 TO STA. 49+00**  
SHEET TITLE

**JRA** DESIGN BY. **WNJ** DRAWN BY. **JRA** CHECKED BY.

**AUGUST 2005** DATE. **03245** JOB NO. **8 / 111** SHEET/TOT

411 N. WEBB ROAD  
WICHITA, KS. 67206  
316-684-9600