

PLAN

DETAIL 'A'

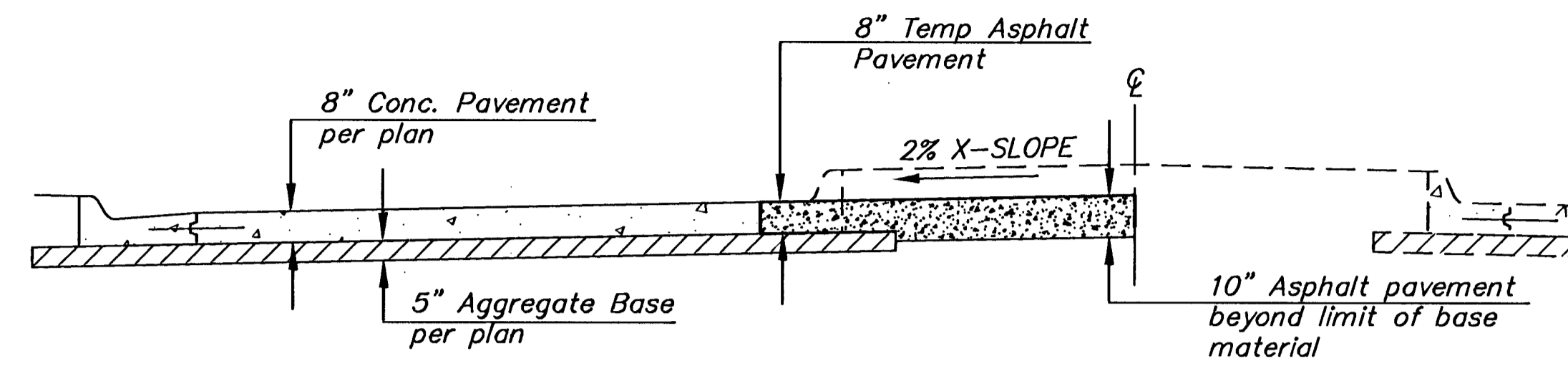

SECTION B-B

| PHASE | HANDLING OF TRAFFIC | MAJOR CONSTRUCTION ITEMS | REMARKS |
|-------|---|---|--|
| I | 1 lane of traffic each way on south lanes of existing McCormick between All Hallows and K-42 highway | Construct new McCormick between Stations 28+00 and 44+00. North half of new McCormick to be constructed between Stations 26+65.71 and 28+00 and between Stations 44+00 and 45+77.53. | Median island between Stations 26+65.71 and 28+00 will not be constructed in this phase. See detail A below for temporary asphalt placement. Access maintained to east parking lot. Temporary access to west parking lot provided off McCormick using temporary asphalt entrance pavement. Access to Hilary Apartments off of All Hallows only. |
| II-A | Traffic moved to new McCormick alignment constructed in phase I and on north lanes of existing McCormick west and east of new alignment. | Construct remaining portion of McCormick between Stations 44+00 and 45+77.53 and improvements to Dondlinger Drive. Construct entrance pavement between Dondlinger Drive and existing McCormick including drainage improvements. | Access maintained to east parking lot. Permanent access to west parking lot and Hilary apartments off of new McCormick restored. Access to McCormick from Dondlinger Drive eliminated. Campus traffic to use Sheridan Street. |
| II-B | Traffic maintained on new McCormick alignment constructed in phase I and on north lanes of existing McCormick west and east of new alignment. | Construct remaining portion of McCormick between Stations 26+65.71 and 28+00 and improvements to Sheridan Street. Construct entrance pavement between Sheridan and existing McCormick. | Access maintained to east parking lot. Temporary access to west parking lot provided off McCormick using temporary asphalt entrance pavement. Access to Hilary Apartments off of All Hallows only. Access to McCormick from Sheridan Street eliminated. Campus and Sheridan traffic to use Dondlinger Drive. |
| III | Traffic moved entirely to new McCormick alignment. Local traffic control shall be used to manage traffic through construction. | Construct median island between Stations 21+80 and 24+00. Construct remaining portion of median island Stations 25+50 and 28+00. Complete all contract work not previously constructed. Construct pavement repairs to existing portions of McCormick. | |
| IV | Local traffic control only required where construction abuts Dondlinger Drive. | Demolish existing portions of McCormick between Sheridan Street and Dondlinger Drive and restore old right-of-way. | Fill Dirt obtained from Excavation Stockpile in Phase I. See General Note on Title Sheet. |

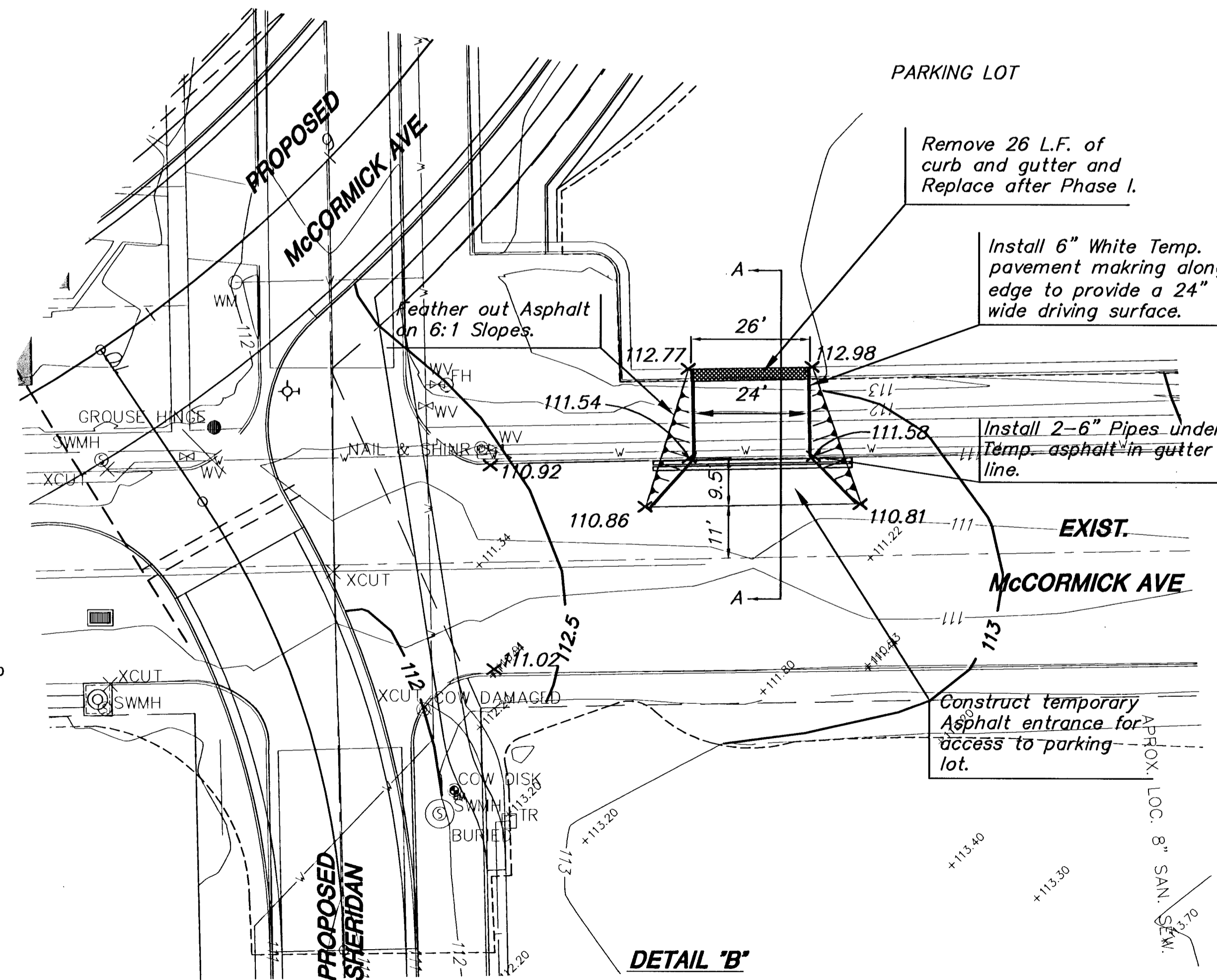
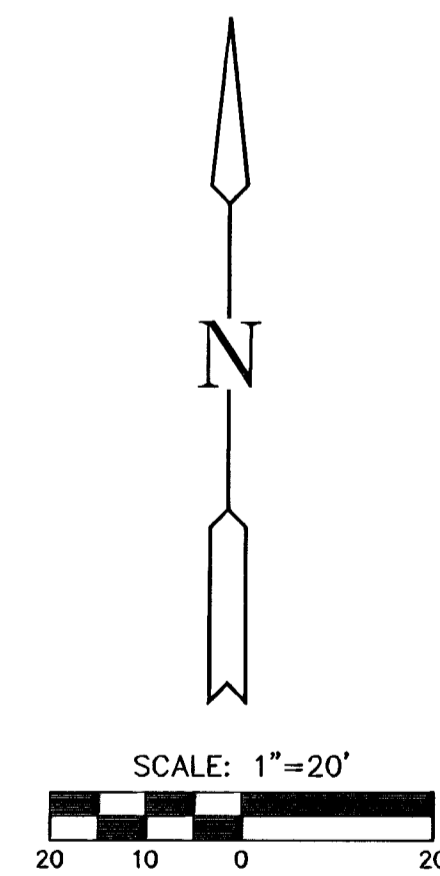

DETAIL 'B'

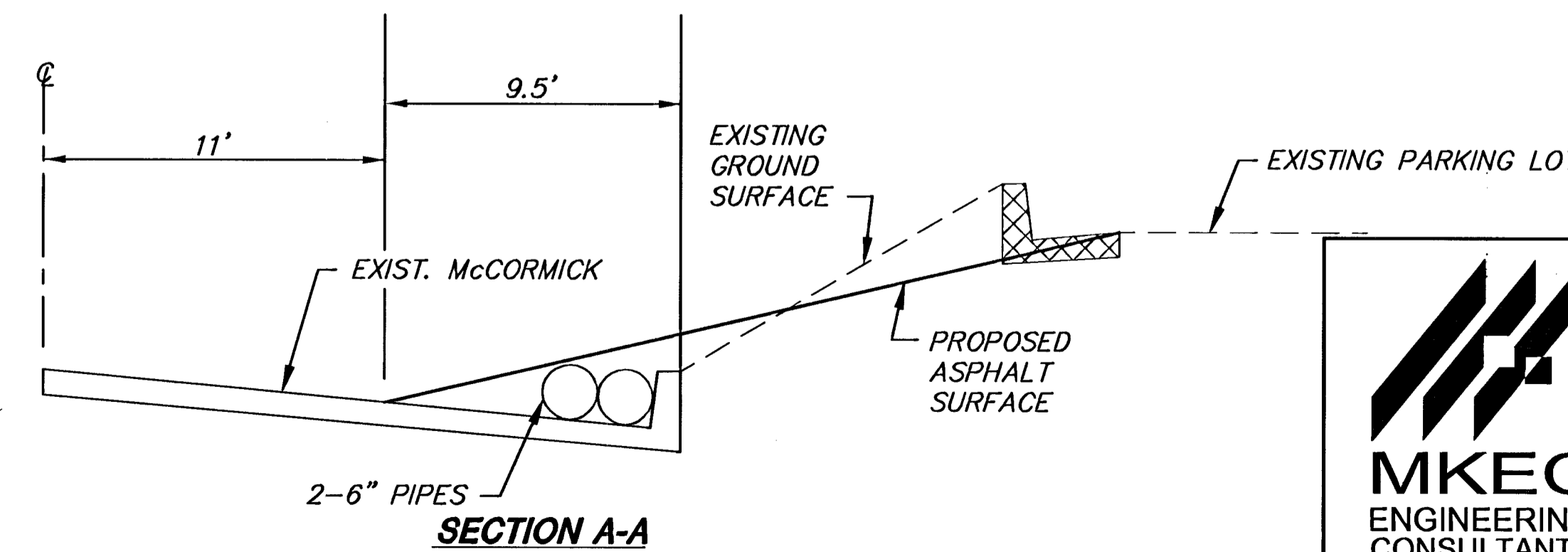

SECTION A-A



MCCORMICK AVENUE STREET IMPROVEMENTS
PROJECT NAME

CONSTRUCTION SEQUENCE SUMMARY
SHEET TITLE

| | | |
|---------------------|------------------|----------------------|
| JRA DESIGN BY: | DPG DRAWN BY: | JRA CHECKED BY: |
| AUGUST 2005 DATE | 03245 JOB NO. | 61 / 111 SHEET/OF |