

INDEX OF SHEETS

- 1 Cover Sheet
- 2 37" BK-BK Detail
- 3-7 Paving Plans
- 8 Conc. Pavement Detail
- 9 Wheelchair Ramp Details
- 10 Railroad Crossing Details
- 11 Driveway Detail
- 12 Valley Gutter Detail
- 13-14 Joint Plans
- 15 Water Line Improvements
- 16 Water Details
- 17-18 Sanitary Improvements
- 19-23 SWS Plans
- 24-29 SWS Details
- 30 Pedestrian Signal Improvements
- 31-37 Signal Details
- 38 Street Marking & Sign Plans
- 39 Sign Details
- 40-42 Construction Phasing & Traffic Control
- 43-44 Erosion Plan & Details
- 45-51 Cross Sections
- 52 Control & Coordinate Map
- 53-58 Landscape Plans

GENERAL NOTES

1. Contractor will be required to provide notice to utility companies a minimum of twenty-four (24) hours prior to any excavation, as follows:
 Kansas One-Call 687-2470
 The Contractor must notify the following in case of an emergency:
 Cox Communications 262-4270
 or 263-2061
 Westar Energy/
 Kansas Gas & Electric Company 1-888-492-4950
 Southwestern Bell Telephone Company 1-571-2611
 City of Wichita Water Department 268-4908
 City of Wichita Sewer Department 268-4071
 Aquila Natural Gas 941-1808
 or 1-800-303-0357
2. Exist. utilities and their locations, as shown on the plans, represent the best information obtainable for design. Location information has been obtained from the various utility companies and is either from company record drawings or company-provided field locations. The Contractor will be required to work around existing utilities which do not conflict with proposed construction.
3. The Contractor to verify utility locations prior to construction of this project.
4. Utility service and installation shall be coordinated with the respective utility owners. Contacts are:
 Kansas Gas Service Jim Coe 832-3126
 Westar Energy Miles Copps 261-6251
 Aquila Networks Calvin Briggs 942-8811
 Wichita Water & Sewer Bill Perkins 268-4555
 Southwestern Bell Jim Toben 268-2759
 Cox Communications Brian Ring 262-4270
5. All lawn/turf areas disturbed by construction of proposed improvements shall be restored with sod. All sod work shall be in accordance with the City of Wichita standard specifications and the City of Wichita administrative regulation No. AR78 which governs cleanup and replacement following construction. All costs for this work shall be subsidiary to the lump sum price bid for "Site Restoration."
6. Traffic affected by the construction of this project shall be handled in accordance with the latest edition of the Manual on Uniform Traffic Control Devices.
7. Areas over excavated in pavement removal shall be filled to subgrade elevation and compacted to 95% Standard Density.
8. Properties within the project may have underground irrigation systems (lawn sprinklers) which conflict with new construction. Contractor shall remove such components as needed during construction of the project. The irrigation system shall be reinstalled in like kind before project completion. Any irrigation system modifications required because of project improvements shall be coordinated with the property owner. Portions of underground irrigation systems not in conflict with new construction shall be protected from damage and shall remain in place. All work related to underground irrigations/sprinklers shall be subsidiary to Site Restoration.
9. The contractor shall be responsible for preserving property irons. The contractor will be required to re-establish any property irons which are damaged or destroyed by his construction operations. Such irons shall be re-established by a licensed land surveyor in accordance with state laws.
10. Construction shall be in accordance with the City of Wichita standard construction practices.
11. It is the contractor's responsibility to visit this site to better understand the extent of site clearing and restoration to be performed. Site Clearing and Restoration shall include all costs for removal of items which a pay item is not provided.
12. Temporary Pavement required for adjacent street and business access shall be subsidiary to the "Traffic Control" bid item.
13. Section line, base line is equivalent to center line of pavement improvements.
14. Pedestrian Crossing Signals and a Paved Surface are to be Maintained at all times. Maintain One Entrance to School at all Times.

HARRY STREET IMPROVEMENTS

FROM K-42 TO MERIDIAN

CITY OF WICHITA PROJECT NUMBER 472-84001

COW OCA #: 706900

WICHITA, KANSAS

JIM ARMOUR PE, CITY ENGINEER

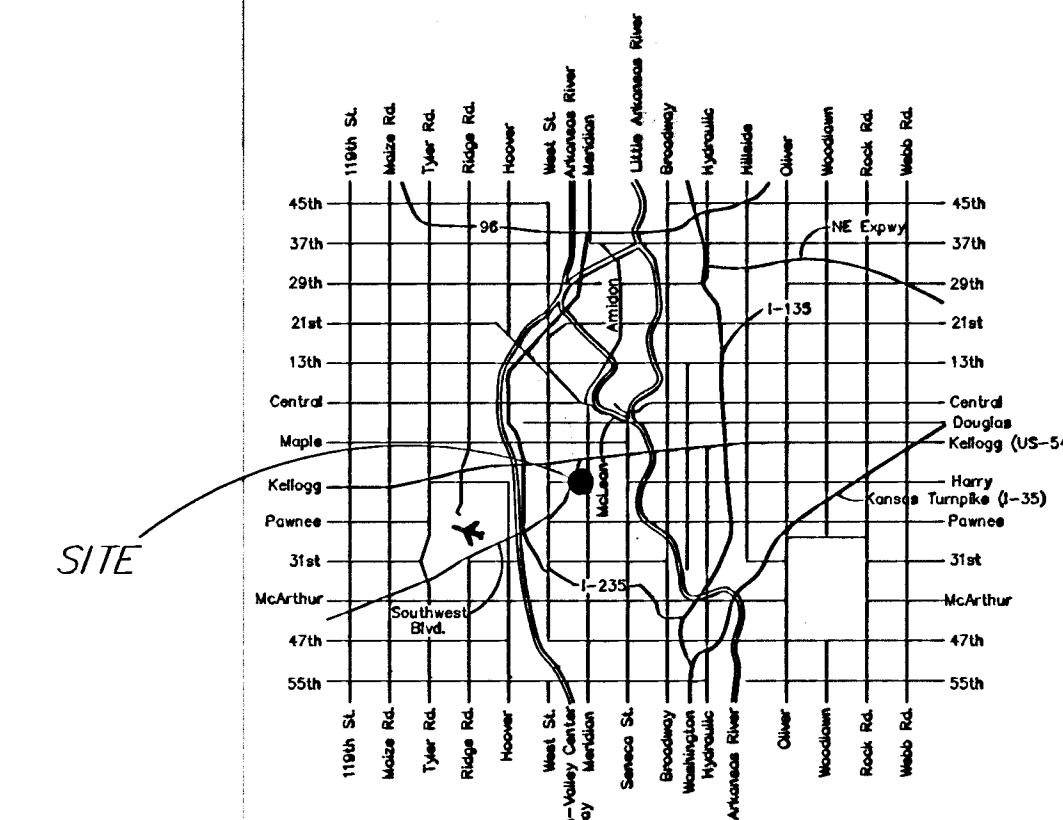

LOCATION MAP

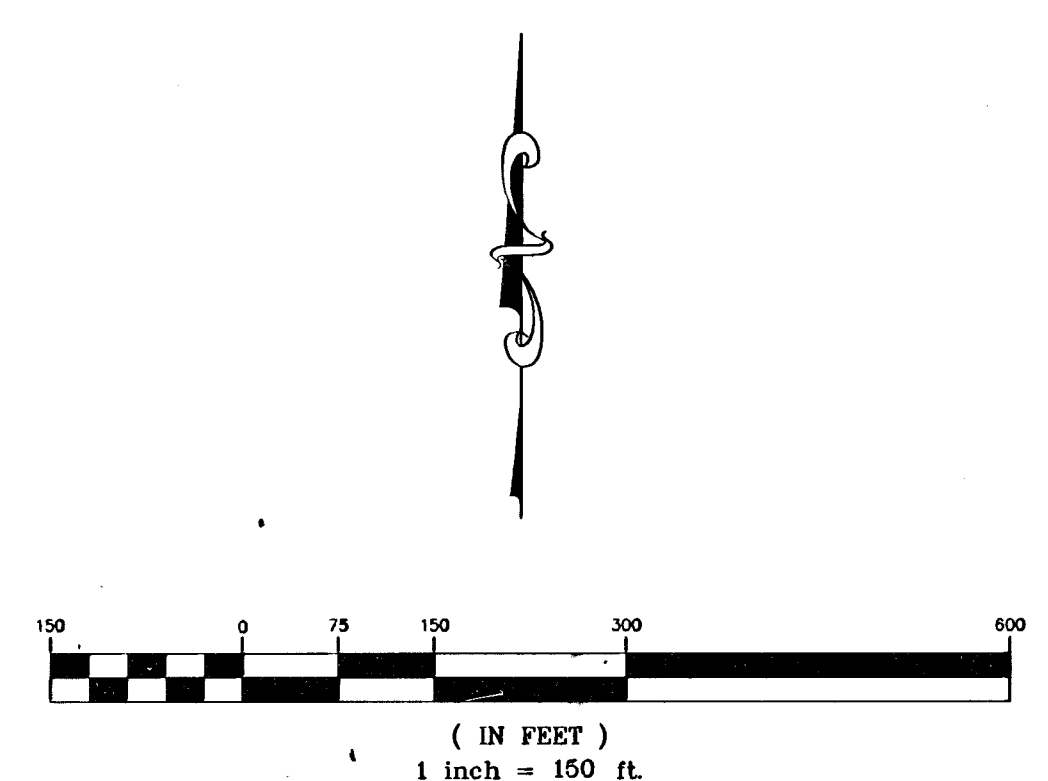
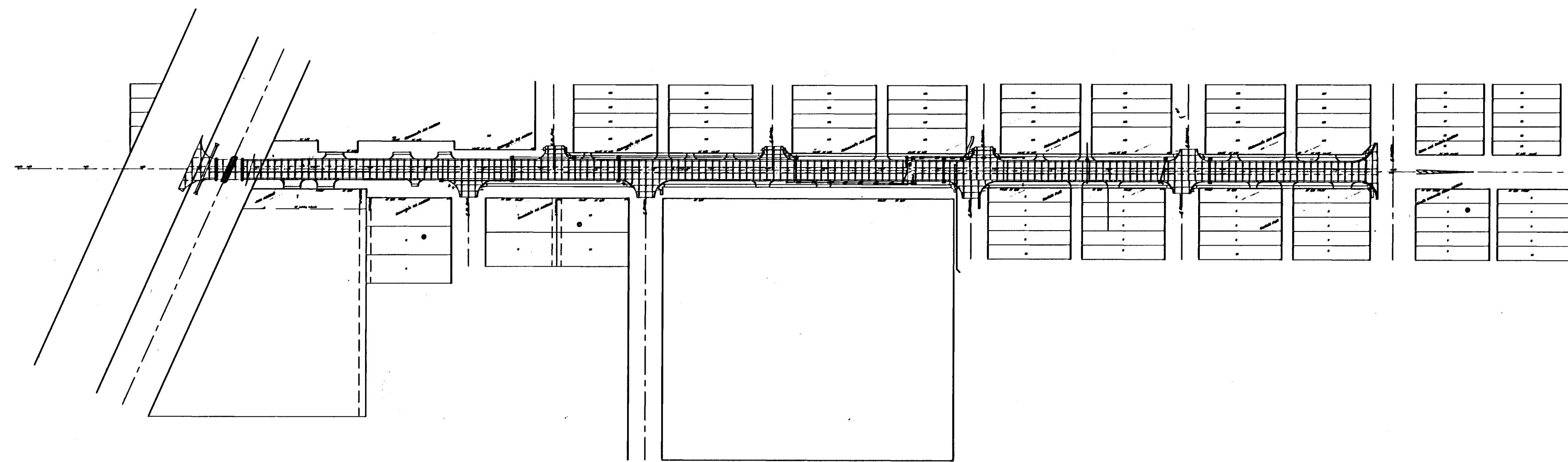

Control Points	Station	Offset	North	East	Description
1	13+43.36	49.99' Rt	4,925.74	9,838.63	1/2" IP SW Corn. St. Pau & Harry
2	14+90.78	34.92' Lt	5,010.13	9,986.34	SRE NW Corn. St. Paul & Harry
3	15+29.37	50.08' Rt	4,924.99	10,024.64	1/2" IP LL Between St. Paul & Gordon
4	16+55.78	50.00' Rt	4,924.63	10,151.05	1/2" IP SW Corn. Gordon & Harry
5	25+98.83	29.94' Rt	4,941.33	11,094.16	1/2" IP SW Corn. Richmond & Harry
6	28+10.10	29.97' Lt	5,001.30	11,105.54	4RE NW Corn Richmond & Harry
7	28+29.99	30.06' Lt	5,000.59	11,325.86	SRE SW Corn Lot 283 Richmond 2nd Add.
8	30+00	0.00	4,969.93	11,495.43	3/4" Sect. Corner in Int. Meridian & Harry

SUMMARY OF QUANTITIES	QUANTITY	UNIT
Concrete Pavement (8") (Rein.)	7,436	sf
Reinforced Crushed Rock Base (9")	10,163	sf
Opt. Unclassified Excav. Base	500	cy
Rein. Conc. Valley Gutter (8")	1,088	sf
Mod. State Type I Curb	3,417	lf
Mono. Edge Curb	556	lf
Sidewalk Concrete (4")	11,759	sf
Wheelchair Ramp (30 st)	18	ea
Inlet Hookup	22	ea
Brick Paver Crosswalk	192	sf
Rein. Conc. Driveway (8")	6,710	sf
Concrete Railroad Approach	144	sf
Excavation	5,514	cy
Fill	39	cy
Sawed Cut (Full Depth)	466	lf
MH Adjusted	4	ea
Sediment Barrier Inlet	22	ea
Back of Curb Protection	3,734	lf
Pavement Removal	8,235	sf
Railroad Header Removal	2	ea
Sidewalk, Drive, &/or Parking Removed	20,166	sf
SWS Pipe Removed 0"-20"	272	lf
SWS Pipe Removed 20"-48"	580	lf
MH Removed	3	ea
SS Pipe Removed 0"-20"	72	lf
Inlet Removed	15	ea
Site Clearing & Restoration	2,499	sf
Project Sod	20	ea
Landscape Plants	1	LS
Street Signage	1	LS
Pavement Marking	1	LS
Traffic Manhole Adjust	1	ea
Traffic Signalization	1	LS
Traffic Control	1	LS
SWS Pipe RCP 15"	455	lf
SWS Pipe RCP 18"	120	lf
SWS Pipe HERCP 24"X38"	587	lf
Inlet Curb 1A (L=5' W=3')	6	ea
Inlet Curb 1 (L=5' W=3')	7	ea
Inlet Curb 2 (L=6'2" W=5')	8	ea
Inlet Curb 2 (L=6'2" W=3'4" 3/8")	1	ea
HERCP 24"X38" Endsection	2	ea
SS Pipe PVC 8" (C900)	72	lf
Concrete Encase SS Line	40	lf
WV Pipe 08"	190	lf
12"X8" Topping Valve Assy	1	ea
WV Valve Adjustment	11	ea
Relocate Water Meter	4	ea
WV Site Clearing & Restoration	1	LS
4" Custom Domestic Service Line	1	ea

BENCHMARKS:
 BM1: COW Disk, Bl Sta 9+17 23' RT
 In N side cnc base RR Signal Light S
 Side of Harry, west of tracks.
 Elev. = 112.42 City Datum
 BM2: COW Disk, Bl Sta 30+60 29' RT
 SE corn of int. of Harry & Meridian.
 Elev. 106.34 City Datum



November 2005



516 S. Market,
 Wichita, KS 67202 316/264-0242