

Legend

- Longitudinal Joint
- Contraction Joint
- Expansion Joint*

*Expansion Joint to be placed at not greater than 300' intervals per City Spec. Recommended locations are noted on plan.

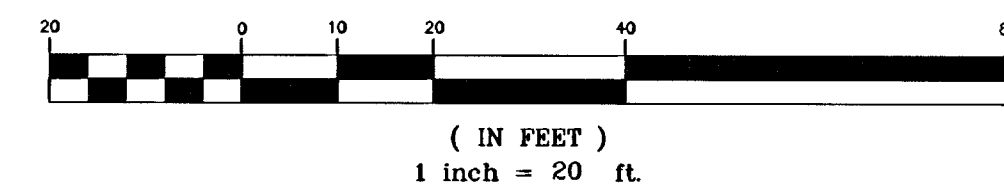
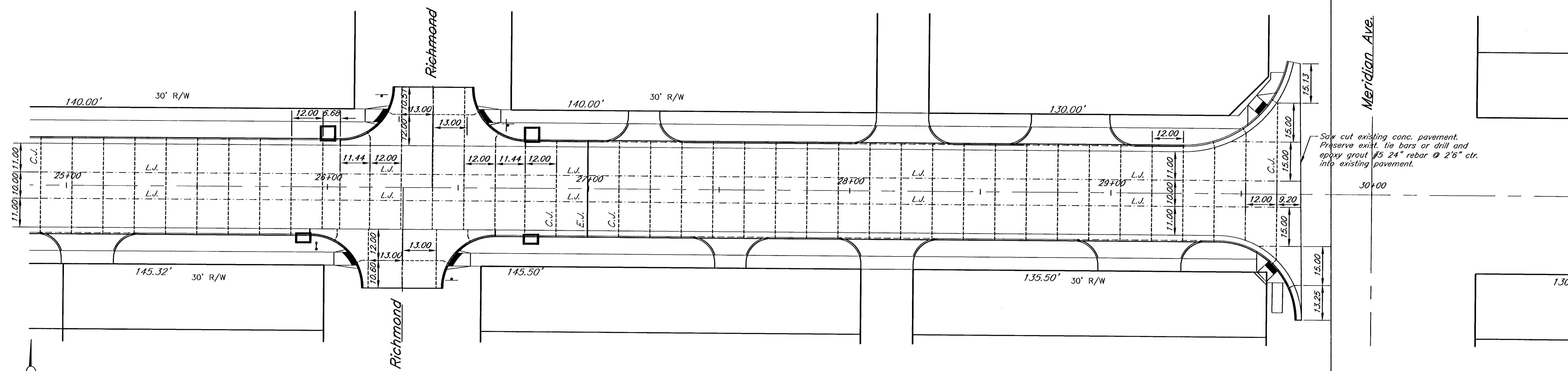

Harry Street, Meridian to K-42
Contraction & Expansion Joint Plan
 Wichita, KS

PROJECT NUMBER 472-84001 OCA#: 706900			
KEM NO. 04050	FILE Joints	DATE 2/04	SHEET 14
DESIGN PB	DRAWN PB	REVISED 11/21/05	OF 58

kemiller engineering
 516 S. Market, Wichita, KS 67202 316/264-0242