

FHWA REGION NO.	STATE	PROJECT NO.	FISCAL YEAR	SHEET NO.	TOTAL SHEETS
7	KANSAS	87N-0348-01	2007	01	135

STP-N34(801)

STATE OF KANSAS  
DEPARTMENT OF TRANSPORTATION

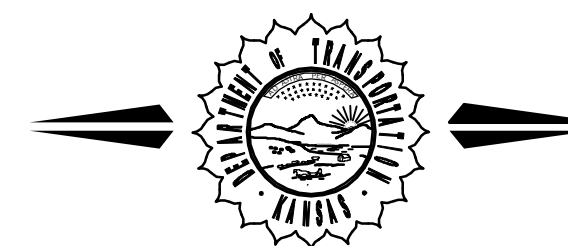

CONSTRUCTION PLANS FOR PROPOSED  
**29TH STREET NORTH**  
FROM 119TH STREET WEST to MAIZE ROAD  
FEDERAL AID URBAN SYSTEM PROJECT

FOR  
THE CITY OF WICHITA,  
SEDGWICK COUNTY, KANSAS  
Jim Armour, P.E., City Engineer  
City Project No. 472-83982 & 472-83752  
O.C.A. Nos. 706919,766131,766132,766133,766134

May 2007

**FINAL PLANS**

SITE

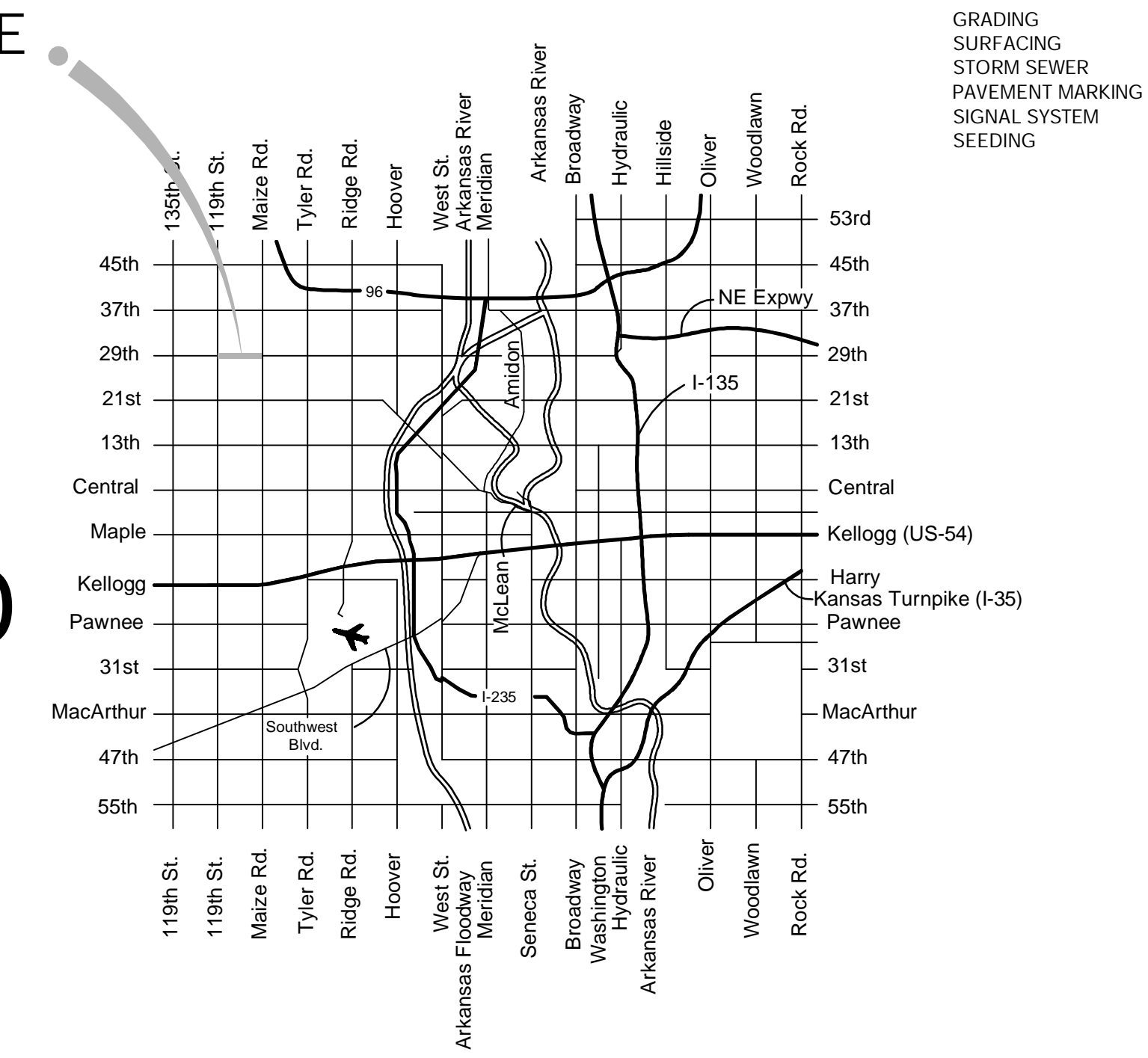

VICINITY MAP

Index

- 1 Title Sheet
- 2 Key Sheet
- 3 General Notes
- 4-5 Typical Sections
- 6 Standard Pavement Detail
- 7-17 29th Street North Paving Plans
- 18-19 119TH Street Paving Plans
- 20-22 Maize Road Paving Plans
- 23 Standard Drive Detail
- 24 Covington Drive Detail
- 25 Cardington Valley Gutter Detail
- 26 Parkdale Valley Gutter Detail
- 27 Maize Intersection Detail
- 28 119th Intersection Detail
- 29 Standard Wheelchair Ramp Detail
- 29a Storm Water Sewer Key Sheet
- 30-39 Storm Water Sewer Plans
- 40-46 Storm Water Sewer Details
- 47 Offsite Drainage Ditch Plan
- 48 Offsite Drainage Ditch Details
- 49 Handrail Details
- 50 Drainage Plan
- 51 Erosion Control Plan
- 52-55 Erosion Control Details
- 56 Fire Hydrant Relocation Plan
- 57 Water Assembly Detail
- 58-73 Marking and Signing Plan
- 74 29th and 119th Intersection Signal Plan
- 75 29th and 119th Intersection Wiring Plan
- 76 29th and Maize Signal Modification Plan
- 77-78 Marking and Signing Details
- 79-84 Construction Sequencing Plan
- 85 Construction Sequencing Detail Sheet
- 86-89 Traffic Control Details
- 90 Summary of Quantities
- 91 Recapitulation of Quantities
- 92 Seeding and Sodding Plan
- 93-108 Landscaping Plan
- 109-130 29th Street Cross Sections
- 131-133 119th Street Cross Sections
- 134-135 Offsite Drainage Ditch Cross Sections

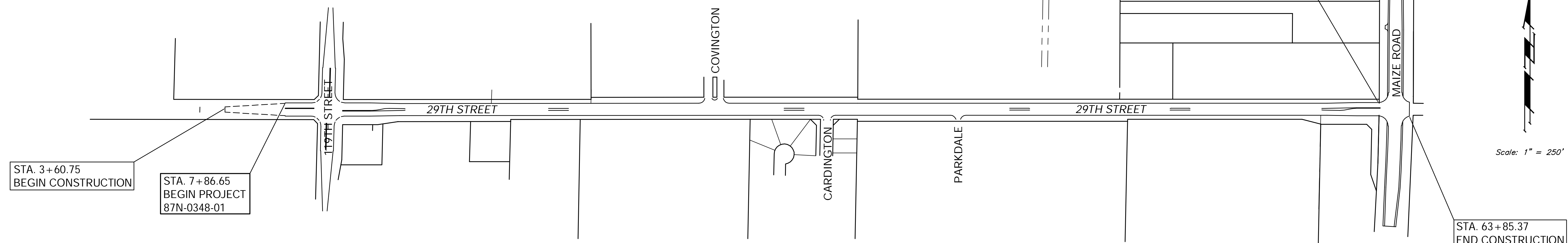

PROJECT AREA

DESIGN DATA

AADT (2000)	10,000
AADT (2030)	15,000
DHV	8%
T	3%
V	40mph
C of A	N/A
Clear Zone	6'

Gross Length of Project	5,452.5 ft.
Exceptions	0.000 ft.
Additions	0.000 ft.
Net Length of Project	5,452.5 ft.
Net Length of Bridges	0.000 ft.
Net Length of Road	5,452.5 ft.

APPROVED - DATE

JIM ARMOUR, P.E., CITY ENGINEER  
CITY OF WICHITA, KANSAS

