

PROVIDE FOUR (4) HOSE BIBS EQUALLY SPACED ALONG RIVER EDGE SIDEWALK

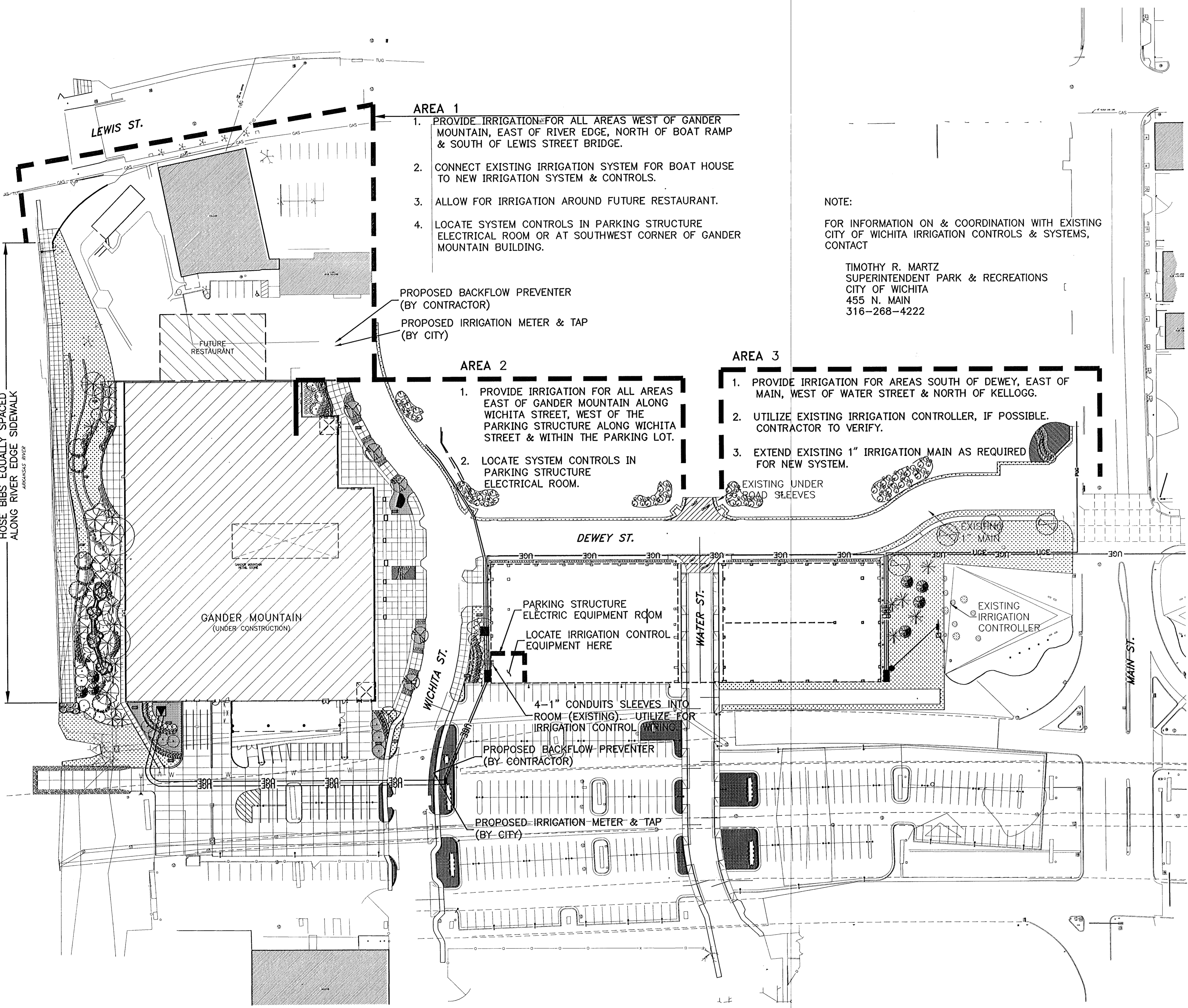

- AREA 1**
1. PROVIDE IRRIGATION FOR ALL AREAS WEST OF GANDER MOUNTAIN, EAST OF RIVER EDGE, NORTH OF BOAT RAMP & SOUTH OF LEWIS STREET BRIDGE.
 2. CONNECT EXISTING IRRIGATION SYSTEM FOR BOAT HOUSE TO NEW IRRIGATION SYSTEM & CONTROLS.
 3. ALLOW FOR IRRIGATION AROUND FUTURE RESTAURANT.
 4. LOCATE SYSTEM CONTROLS IN PARKING STRUCTURE ELECTRICAL ROOM OR AT SOUTHWEST CORNER OF GANDER MOUNTAIN BUILDING.

PROPOSED BACKFLOW PREVENTER (BY CONTRACTOR)
 PROPOSED IRRIGATION METER & TAP (BY CITY)

- AREA 2**
1. PROVIDE IRRIGATION FOR ALL AREAS EAST OF GANDER MOUNTAIN ALONG WICHITA STREET, WEST OF THE PARKING STRUCTURE ALONG WICHITA STREET & WITHIN THE PARKING LOT.
 2. LOCATE SYSTEM CONTROLS IN PARKING STRUCTURE ELECTRICAL ROOM.

PARKING STRUCTURE ELECTRIC EQUIPMENT ROOM
 LOCATE IRRIGATION CONTROL EQUIPMENT HERE

4-1" CONDUITS SLEEVES INTO ROOM (EXISTING) - UTILIZE FOR IRRIGATION CONTROL WIRING
 PROPOSED BACKFLOW PREVENTER (BY CONTRACTOR)
 PROPOSED IRRIGATION METER & TAP (BY CITY)

- AREA 3**
1. PROVIDE IRRIGATION FOR AREAS SOUTH OF DEWEY, EAST OF MAIN, WEST OF WATER STREET & NORTH OF KELLOGG.
 2. UTILIZE EXISTING IRRIGATION CONTROLLER, IF POSSIBLE. CONTRACTOR TO VERIFY.
 3. EXTEND EXISTING 1" IRRIGATION MAIN AS REQUIRED FOR NEW SYSTEM.

EXISTING UNDER ROAD SLEEVES
 EXISTING 1" MAIN
 EXISTING IRRIGATION CONTROLLER

NOTE:
 FOR INFORMATION ON & COORDINATION WITH EXISTING CITY OF WICHITA IRRIGATION CONTROLS & SYSTEMS, CONTACT

TIMOTHY R. MARTZ
 SUPERINTENDENT PARK & RECREATIONS
 CITY OF WICHITA
 455 N. MAIN
 316-268-4222

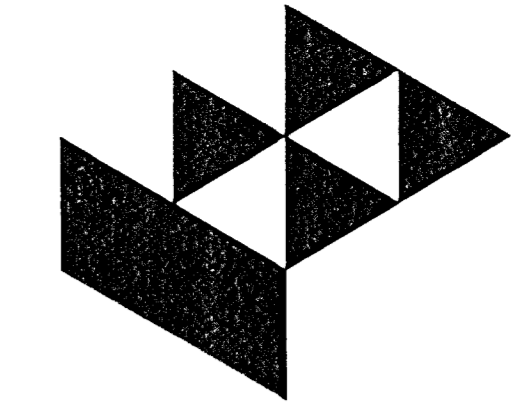
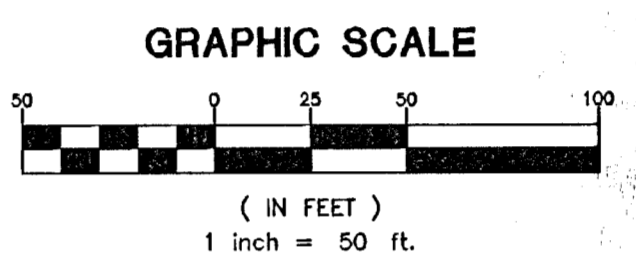

GossenLivingston
 Architecture
 420 South Emporia
 Wichita, KS 67202
 Tel: (316) 265-9267
 Fax: (316) 265-5646
 Email: architect@glj.com

© 2005 Gossen Livingston Associates, Inc.
 The drawing and all information herein is the exclusive property of Gossen Livingston Associates, Inc. and is not to be copied or used in any way without the express written consent of Gossen Livingston Associates, Inc. All drawings, specifications, ideas, designs and arrangements appearing herein constitute the original and unpublished work of:
 Gossen Livingston Associates, Inc.



Johnson & Associates, Inc.
 100 E. California Ave. - Third Floor
 Oklahoma City, OK 73104
 (405) 235-8075 FAX (405) 235-8078

Certificate of Authorization #E-1128 EXP. DATE: 12-31-2005

WICHITA WATERWALK

PUBLIC IMPROVEMENTS PHASE 1A

2005 THE UNIVERSITY OF OKLAHOMA ARCHITECTURAL RECORDS, 207 W. WALKER STREET, OKLAHOMA CITY, OK 73104-1000, 405-541-1234

Mark	Date	Description

OVERALL IRRIGATION PLAN

Job No.	L3.0
Date	06-16-05
Drawn	BC
Checked	PB
of 2 Dwg. 19 of 23	