

FHWA REGION NO.	STATE	PROJECT NO.	YEAR	SHEET NO.	TOTAL SHEETS
7	KANSAS	87 N-0137-01	99	52	94

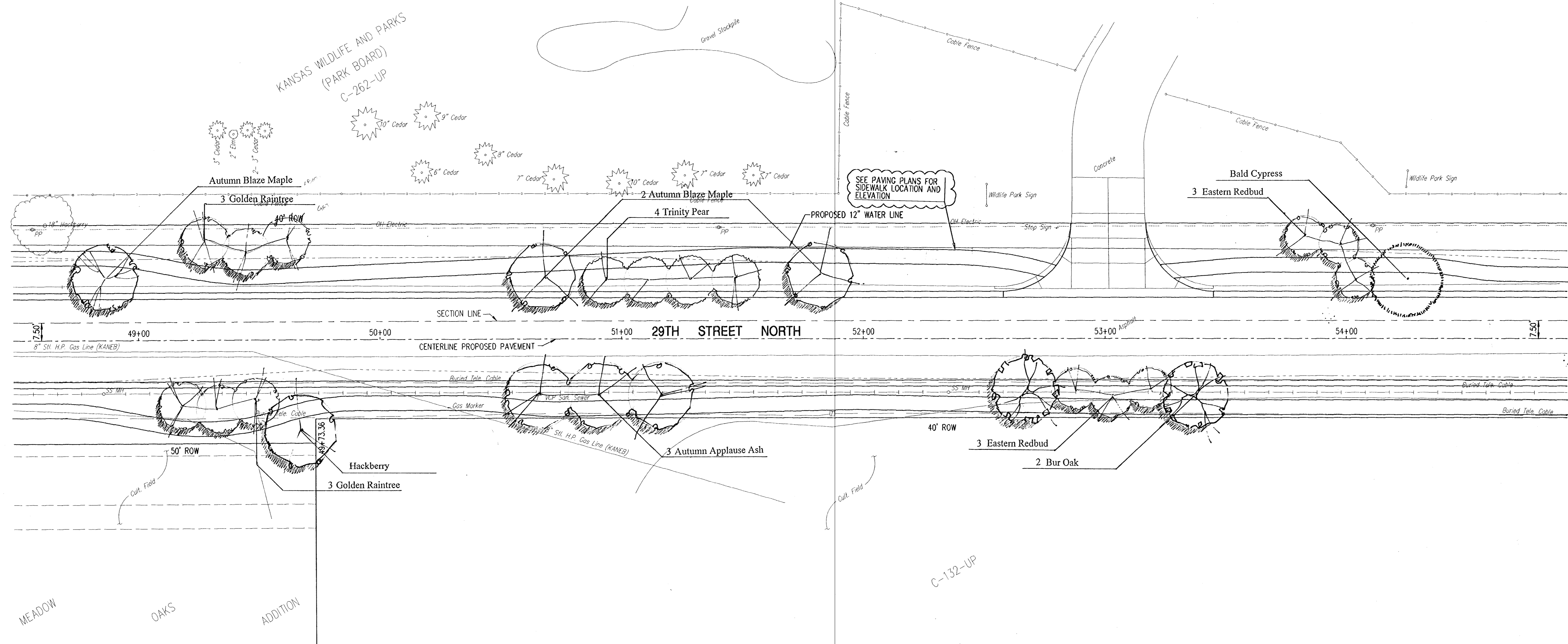
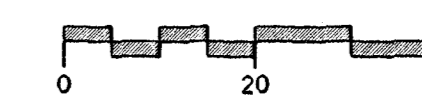

Bid Items (per sheet)

Qty	Botanical Name	Common Name	Size
3	Acer fremanii 'Autumn Blaze'	'Autumn Blaze' Maple	2.5"
3	Fraxinus americana	'Autumn Applause' Ash	2.5
2	Quercus macrocarpa	Bur Oak	2.5
1	Celtis occidentalis	Hackberry	2.0
1	Taxodium distichum	Bald Cypress	3.0
6	Cercis canadensis	Eastern Redbud	1.5
6	Koeleruteria paniculata	Goldenrain Tree	1.5
4	Pyrus calleryana	'Trinity' Pear	1.5
Seeding Turf type tall fescue			0.34 acres

YOUNG & ASSOCIATES, P.A.
 CIVIL AND ENVIRONMENTAL ENGINEERS
 100 South Georgia
 Derby, Kansas, 67037
 Tel: (316) 788-2552
 Fax: (316) 788-4408

City of Wichita
 Sedgwick County, Kansas

**CL STA. 49+00 TO 54+50
 LANDSCAPE PLAN**

29th Street North from Oliver Street to Woodlawn Avenue
 Street, Decel Lane, and Storm Drainage Improvements

Project No.: 96-035-002 Design:
 Date: January 1998 Tech:

Sheet No. 52 of 94

DATE: 1-17-98 DRAWN: J.E. CHECKED: J.E. SCALE: 1"=20'
 BY: J.E. DATE: 1-17-98