

- NOTES:
- SEE LS SERIES SHEETS FOR TOWER AND SIDEWALK CONSTRUCTION, DETAILS AND PATTERNS.
 - ALL STATIONING, RADII, PAVEMENT WIDTHS AND OFFSETS ARE MEASURED TO THE HIGH EDGE OF CURB, UNLESS NOTED OTHERWISE. ELEVATIONS ARE HIGH EDGE AND TOP OF CURB.
 - ENTRANCE CONSTRUCTION PER APPLICABLE DETAIL SHEETS. CONCRETE THICKNESS SHALL BE 6" MIN. OVER 6" CRUSHED ROCK ON GEOGRID REINFORCEMENT. PROVIDE SIDEWALK AT EACH ENTRANCE WITH 1% TO 2% PER FOOT SLOPE TOWARDS STREET.
 - BRONZE PLAQUE: COORDINATE REMOVAL AND REPLACEMENT WITH SALVATION ARMY, MAJOR DALLAS RABY OR MARK SCHWEIZER, 263-2769.

- WETZEL MONUMENT: COORDINATE REMOVAL AND REPLACEMENT WITH CITY OF WICHITA, MONTY ROBSON, 268,4460.
- EXISTING SIDEWALK, CURB, AND GUTTER TO REMAIN, MATCH NEW CONSTRUCTION WITH EXISTING.
- ADJUST EXISTING INLET TOP TO MATCH GUTTER FLOWLINE.
- MAIL BOXES SHALL REMAIN IN SERVICE DURING CONSTRUCTION OPERATIONS. TEMPORARY LOCATIONS SHALL BE COORDINATED WITH U.S. POSTAL SERVICE DOWNTOWN SUPERVISOR 262-6245. COST SUBSIDIARY TO CONC. SIDEWALK REMOVAL.

REMOVE FLAGPOLE, BRICK WALL, CURBED ISLAND, AND ELECTRICAL SYSTEM (COORDINATE WITH KG&E FOR REMOVAL OF POWER SUPPLY AND METER).

REMOVE EXIST. CURB & GUTTER & MONOLITHIC PAV'T.

REMOVE EXIST. SIDEWALK

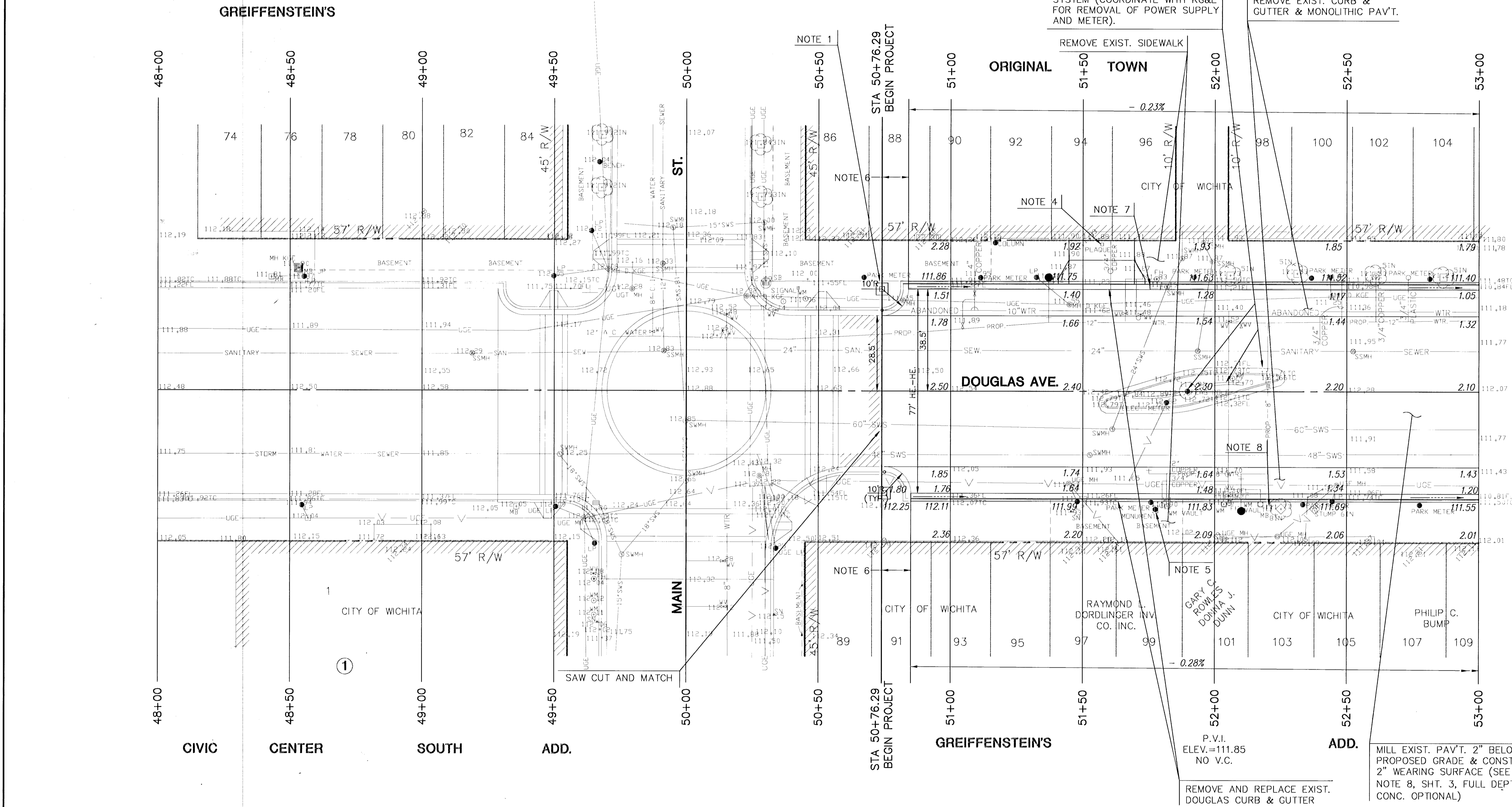

SCALE: 1"=20'

Dimension Changes, Douglas Avenue

Sta. 50+85R to Sta. 53+10R
Sta. 58+26R to Sta. 60+55R
Sta. 54+55R to Sta. 56+78R

Sheets 7, 8, & 9

Plans show 38.5' centerline-H.E. Change to 37.5' centerline-H.E. South curb to clear street light foundations, and as approved by the Engineer. Adjust locations of curb inlets Lines 1B, 2B and 3D accordingly.

Sheet 12

Adjust line 1B, 2B and 3D curb inlet locations and RCP length accordingly.

Sheets LS 1.01, 1.02, 1.03 & 5.01

SideWalk width south side of Douglas, adjust accordingly.

DRIVE ENTRANCES - SEE GENERAL NOTES				
LOCATION MAIN ST.	TYPE	W	WG	NOTES
51+57 LT.	FULL RAMP COMMERCIAL	25'	MATCH EXIST.	SEE NOTE 3

REVISED 4/99

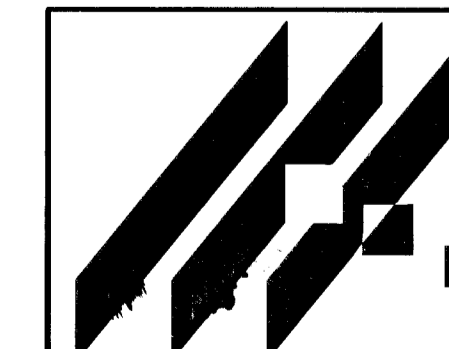

STREETSCAPES
PROJECT NAME

DOUGLAS AVE. STA. 48+00 TO 53+00
SHEET TITLE

MID-KANSAS ENGINEERING CONSULTANTS, INC.
411 N. WEBB ROAD
WICHITA, KS. 67206
316-684-9600

DCH
DESIGN BY:

WNJ
DRAWN BY:

RLB
CHECKED BY:

OCT. 1995
DATE

92010
JOB NO.

7 / 61
SHEET/OF