

PAVING PLANS
KRUG SOUTH ADDITION
PHASE 1

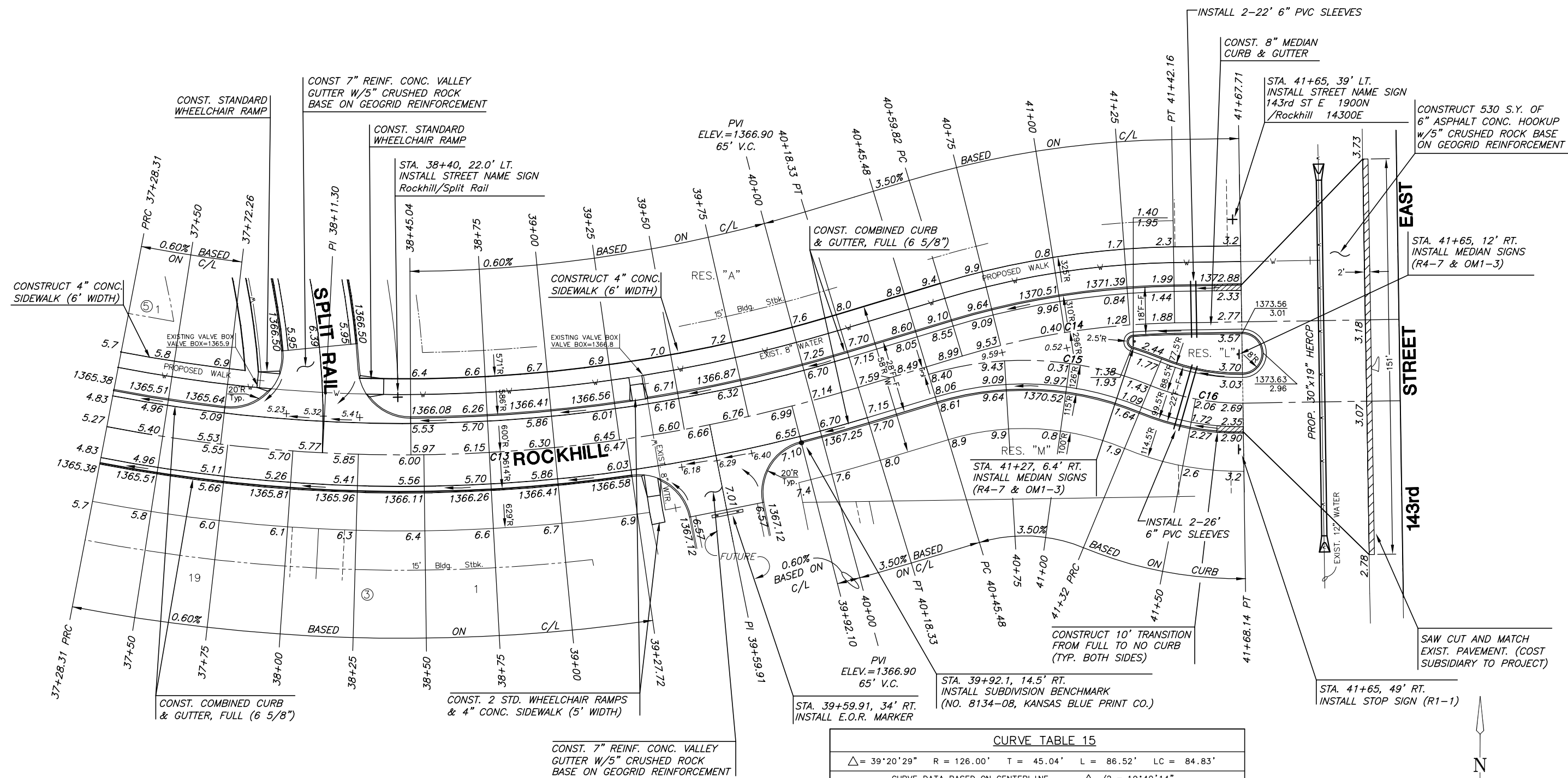

CURVE TABLE 13

$\Delta = 27^{\circ}41'39''$ R = 600.00' T = 147.90' L = 290.01' LC = 287.20'

CURVE DATA BASED ON CENTERLINE $\Delta / 2 = 13^{\circ}50'50''$

STATION	ARC	8' Off LtCb	8' Off RtCb	DEFLECTION	TOTAL DEFLECTION
37+28.31	-	-	-	00°00'00"	00°00'00"
37+50.00	21.69'	20.89'	22.48'	01°02'08"	01°02'08"
37+75.00	25.00'	24.08'	25.91'	01°11'37"	02°13'45"
38+00.00	25.00'	24.08'	25.91'	01°11'37"	03°25'23"
38+25.00	25.00'	24.08'	25.91'	01°11'37"	04°37'00"
38+50.00	25.00'	24.08'	25.91'	01°11'37"	05°48'37"
38+75.00	25.00'	24.08'	25.91'	01°11'37"	07°00'14"
39+00.00	25.00'	24.08'	25.91'	01°11'37"	08°11'51"
39+25.00	25.00'	24.08'	25.91'	01°11'37"	09°23'29"
39+50.00	25.00'	24.08'	25.91'	01°11'37"	10°35'06"
39+75.00	25.00'	24.08'	25.91'	01°11'37"	11°46'43"
40+00.00	25.00'	24.08'	25.91'	01°11'37"	12°58'20"
40+18.32	18.32'	17.65'	18.99'	00°52'29"	13°50'49"

Def/Ft = 2.86479 Min.

CURVE TABLE 14

$\Delta = 15^{\circ}56'19''$ R = 296.00' T = 41.44' L = 82.34' LC = 82.08'

CURVE DATA BASED ON CENTERLINE $\Delta / 2 = 07^{\circ}58'10''$

STATION	ARC	8' Off LtCb	8' Off RtCb	DEFLECTION	TOTAL DEFLECTION
40+59.82	-	-	-	00°00'00"	00°00'00"
40+75.00	15.18'	16.31'	14.05'	01°28'09"	01°28'09"
41+00.00	25.00'	26.85'	23.14'	02°25'11"	03°53'20"
41+25.00	25.00'	26.85'	23.14'	02°25'11"	06°18'30"
41+42.16	17.16'	18.43'	15.88'	01°39'39"	07°58'10"

Def/Ft = 5.80700 Min.

CURVE TABLE 15

$\Delta = 39^{\circ}20'29''$ R = 126.00' T = 45.04' L = 86.52' LC = 84.83'

CURVE DATA BASED ON CENTERLINE $\Delta / 2 = 19^{\circ}40'14''$

STATION	ARC	8' Off LtCb	8' Off RtCb	DEFLECTION	TOTAL DEFLECTION
40+45.48	-	-	-	00°00'00"	00°00'00"
40+75.00	29.52'	33.89'	25.01'	06°42'42"	06°42'42"
41+00.00	25.00'	28.72'	21.20'	05°41'03"	12°23'45"
41+25.00	25.00'	28.72'	21.20'	05°41'03"	18°04'48"
41+311.00	7.00'	8.05'	5.94'	01°35'26"	19°40'15"

Def/Ft = 13.64185 Min.

CURVE TABLE 16

$\Delta = 23^{\circ}24'09''$ R = 88.50' T = 18.33' L = 36.15' LC = 35.90'

CURVE DATA BASED ON CENTERLINE $\Delta / 2 = 11^{\circ}42'04''$

STATION	ARC	8' Off LtCb	8' Off RtCb	DEFLECTION	TOTAL DEFLECTION
41+32.00	-	-	-	00°00'00"	00°00'00"
41+50.00	18.00'	14.11'	21.83'	05°49'36"	05°49'36"
41+68.15	18.15'	14.23'	22.01'	05°52'28"	11°42'05"

Def/Ft = 19.42230 Min.

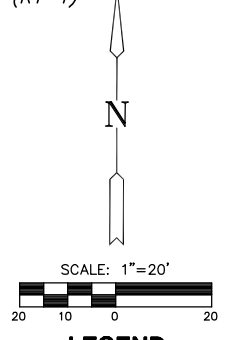

NOTE:
TOP OF CURB ELEVATIONS SHOWN
ARE FOR FULL CURB. CONSTRUCT
CURB AND GUTTER AS NOTED.

ROCKHILL
SHEET TITLE
472-84521
PROJECT NUMBER

DESIGN BY
DFL
DRAWN BY
KKL
CHECKED BY
GJA

ISSUED
July 2007
REVISED

SHEET NO.
15 of 55