

C CURVE DATA						
A=12°20'13" D=2°51'53.2" R=2000.00' L=430.64' T=216.16' E=11.65'						
CURVE DATA BASED ON C radius Δ/2=6°10'6.5"						
C STATION	C ARC LENGTH	FACE CURB LENGTH		CHORD LENGTH		C TOTAL DEFLECTION
		LEFT CURB	RIGHT CURB	8' OFF LEFT FACE CURB	8' OFF RIGHT FACE CURB	
123+92.44						0°00'00.0"
124+00.00	7.56'	7.51'	7.61'	7.48'	7.64'	0°06'29.8"
124+25.00	25.00'	24.82'	25.18'	24.72'	25.27'	0°21'29.2"
124+50.00	25.00'	24.82'	25.18'	24.72'	25.27'	0°49'28.2"
124+75.00	25.00'	24.82'	25.18'	24.72'	25.27'	0°11'05.73"
125+00.00	25.00'	24.82'	25.18'	24.72'	25.27'	0°21'29.2"
125+25.00	25.00'	24.82'	25.18'	24.72'	25.27'	0°53'55.6"
125+50.00	25.00'	24.82'	25.18'	24.72'	25.27'	0°15'24.8"
125+75.00	25.00'	24.82'	25.18'	24.72'	25.27'	0°36'53.9"
126+00.00	25.00'	24.82'	25.18'	24.72'	25.27'	0°58'23.1"
126+25.00	25.00'	24.82'	25.18'	24.72'	25.27'	0°21'29.2"
126+50.00	25.00'	24.82'	25.18'	24.72'	25.27'	0°42'58.2"
126+75.00	25.00'	24.82'	25.18'	24.72'	25.27'	0°04'27.4"
127+00.00	25.00'	24.82'	25.18'	24.72'	25.27'	0°25'56.6"
127+25.00	25.00'	24.82'	25.18'	24.72'	25.27'	0°47'25.8"
127+50.00	25.00'	24.82'	25.18'	24.72'	25.27'	0°08'55.0"
127+75.00	25.00'	24.82'	25.18'	24.72'	25.27'	0°30'24.2"
128+00.00	25.00'	24.82'	25.18'	24.72'	25.27'	0°51'53.4"
128+23.08	23.08'	22.92'	23.24'	22.83'	23.33'	0°19'50.1"
TOTAL	430.64'	427.63'	433.66'			06°10'06.5"

C CURVE DATA						
A=27°13'2" D=38°11'49.9" R=150.00' L=71.25' T=36.31' E=4.33'						
CURVE DATA BASED ON C radius Δ/2=13°36'31"						
C STATION	C ARC LENGTH	FACE CURB LENGTH		CHORD LENGTH		C TOTAL DEFLECTION
		LEFT CURB	RIGHT CURB	8' OFF LEFT FACE CURB	8' OFF RIGHT FACE CURB	
128+23.08						0°00'00.0"
128+25.00	1.92'	2.10'	1.74'	2.20'	1.64'	0°22'1"
128+50.00	25.00'	27.33'	22.67'	28.63'	21.31'	0°46'28.7"
128+75.00	25.00'	27.33'	22.67'	28.63'	21.31'	0°46'28.7"
128+94.33	19.33'	21.14'	17.53'	22.15'	16.49'	0°41'30.3"
TOTAL	71.25'	77.9'	64.6'			13°36'31.0"

WATER VALVE BOX ELEVATIONS			
STREET	STATION	OFFSET	PROPOSED ELEVATION
CORTINA	Sta. 125+28.73	22.0' Rt.	177.9
CORTINA	Sta. 129+07.56	22.0' Rt.	173.6

SCALE: 1"=20'

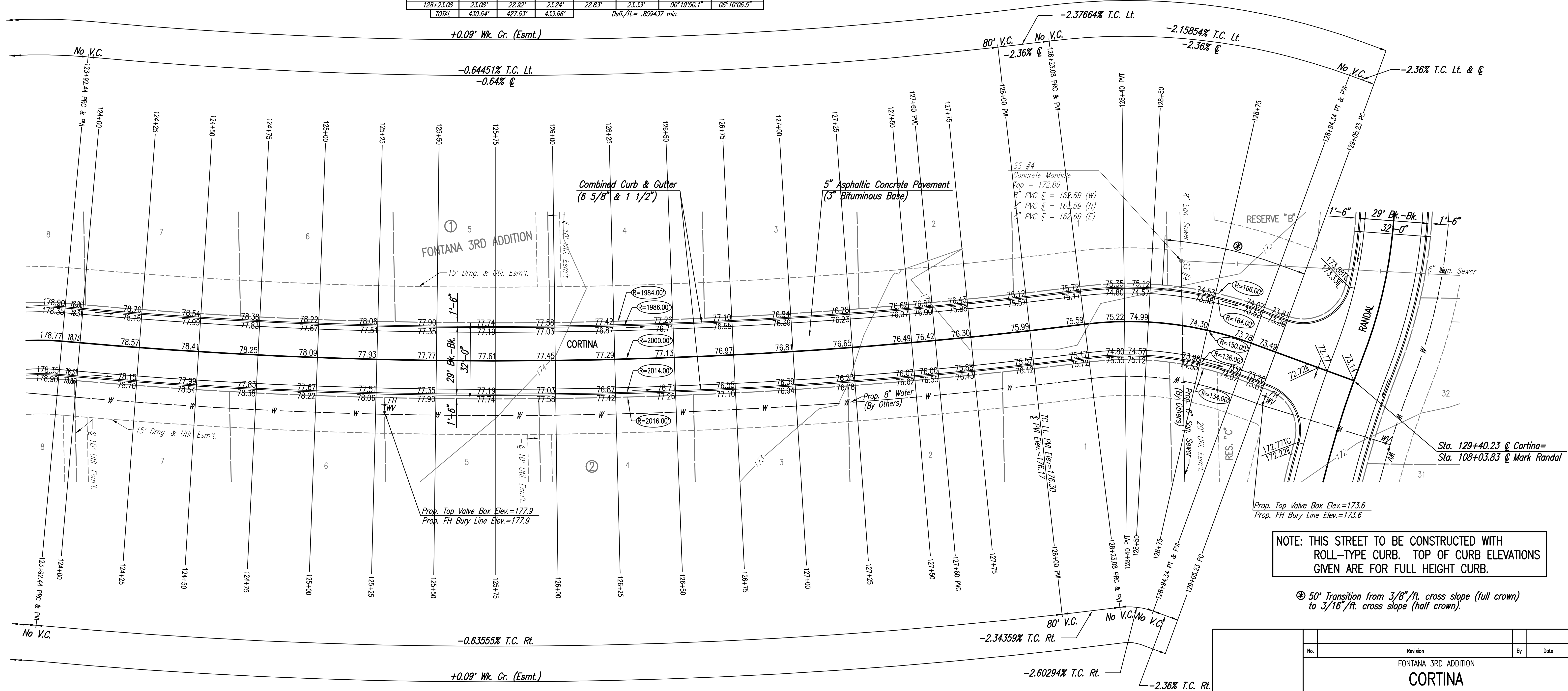

NOTE: THIS STREET TO BE CONSTRUCTED WITH ROLL-TYPE CURB. TOP OF CURB ELEVATIONS GIVEN ARE FOR FULL HEIGHT CURB.

50' Transition from 3/8"/ft. cross slope (full crown) to 3/16"/ft. cross slope (half crown).

No.	Revision	By	Date
	FONTANA 3RD ADDITION		
CORTINA			
STA. 124+00 TO STA. 129+00 JAMES L. ARMOUR, P.E. - CITY ENGINEER CITY OF WICHITA PROJECT NO. 472-84091			
Professional Engineering Consultants, P.A.			
303 S. TOPEKA • WICHITA, KANSAS 67202 316-262-2691 • FAX 316-262-3003			
Designed by	BDB, BMM	Job No.	35-06611-000
Drawn by	BJS, TAT, BMM	Date	November 2006
			Sheet 12 of 58

Served 06-05-2007 6:40:32 AM by BJS
 Plot Scale 1:20 06-11-2007 9:59:38 AM by BJS
 J:\SENTOUT\2006\06611\2007-06-05 to Wichita\Street\DWG\12-STR-CORTINA