

FABRIC BASE REINFORCEMENT SHALL BE 8 X 1100 AS MANUFACTURED BY TENSAR CORPORATION OR APPROVED EQUAL. FABRIC BASE REINFORCEMENT SHALL BE INSTALLED IN ACCORDANCE WITH MANUFACTURER'S RECOMMENDATIONS. CRUSHED ROCK SHALL BE UNIFORMLY GRADED.

PER CENT OF AGGREGATE RETAINED	
2-1/2"	0
3/4"	20 to 80
# 4	50 to 87
# 40	80 to 94
# 200	90 to 98

ROCK QUALITY SHALL CONFORM TO THE REQUIREMENTS SPECIFIED BY K.D.O.T. 1990 EDITION STANDARD SPECIFICATION SUBSECTION 1102 FOR DURABILITY CLASS L.

ROCK BASE IS TO BE COMPACTED AND SMOOTHED WITH A STEEL FACED ROLLER PRIOR TO PLACEMENT OF ASPHALT. TACK COAT WILL NOT BE APPLIED TO ROCK BASE.

REINFORCED CRUSHED ROCK BASE WILL BE PAID FOR AT THE SQUARE YARD PRICE FOR 4" THICKNESS.

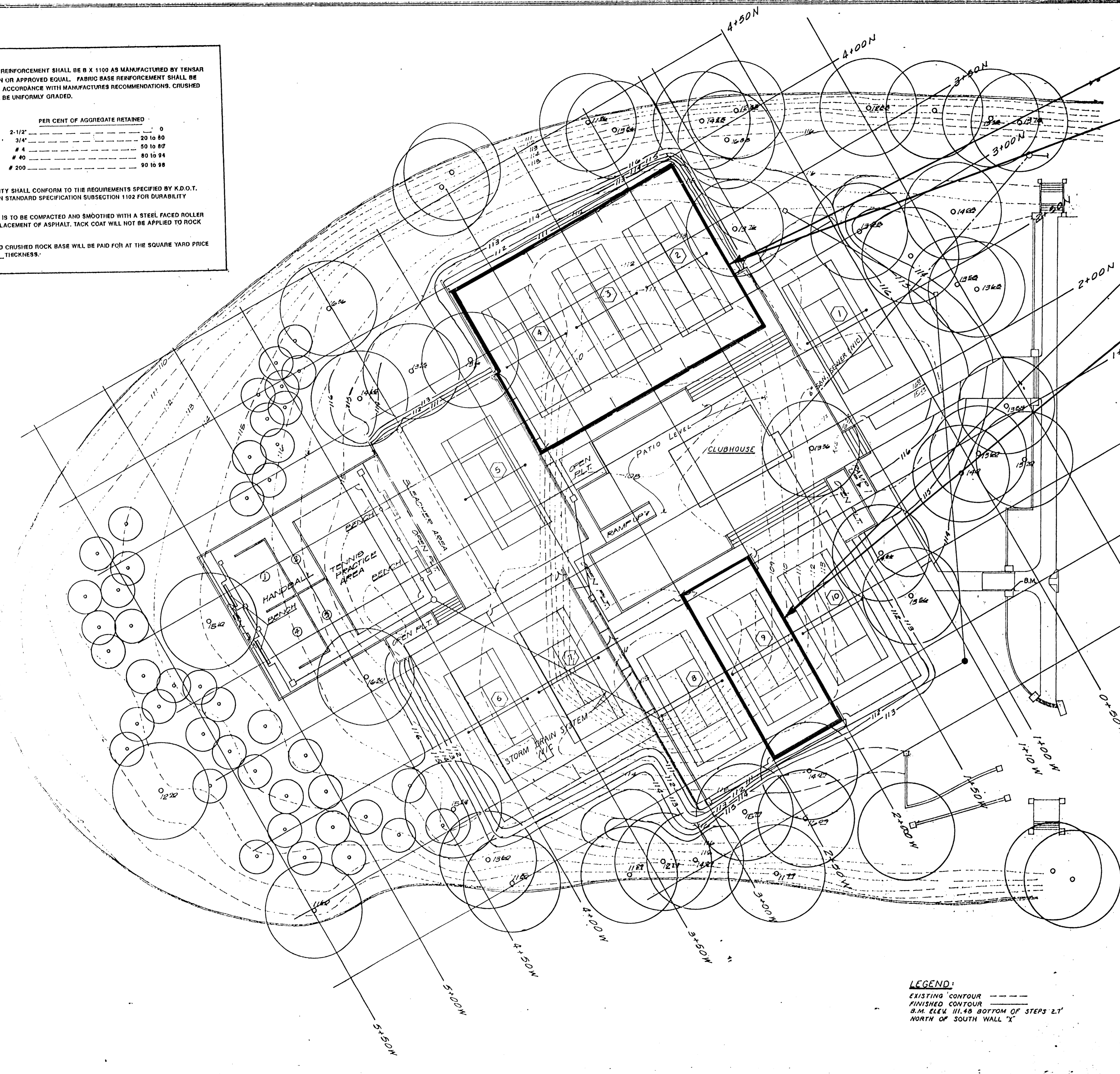

**BASE BID**

REMOVE EXISTING ASPH. PAVEMENT INSIDE OF THE FENCE IN COURTS 2,3,4. CONSTRUCT 3" ASPH. ON 4" REINFORCED CRUSHED ROCK. INSTALL 3" DIA PERFORATED PIPE.

**ADD ALTERNATE #1**

ADD EXTRA 1" ASPH. TO THE BASE BID. THE COST OF EXTRA EXCAVATION FOR THIS ADDITIONAL 1" ASPH. IS SUBSIDIARY TO THE OTHER BID ITEMS.

**ADD ALTERNATE #2**

SAW CUT, REMOVE EXISTING ASPH. PAVEMENT IN COURT 9. CONSTRUCT 3" ASPH. ON 4" REINFORCED CRUSHED ROCK.

**ADD ALTERNATE #3**

ADD EXTRA 1" ASPH. TO THE ADD ALTERNATE #2. THE COST OF EXTRA EXCAVATION FOR THIS ADDITIONAL 1" ASPH. IS SUBSIDIARY TO THE OTHER BID ITEMS.

**LEGEND:**  
 --- EXISTING CONTOUR  
 — FINISHED CONTOUR  
 S.M. ELEV. 111.48 BOTTOM OF STEPS 2.1' NORTH OF SOUTH WALL 'X'

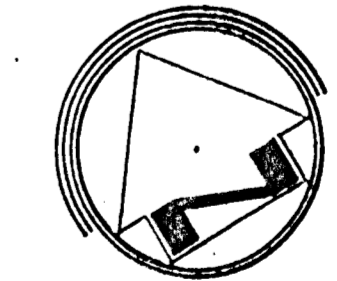

GENERAL PLAN	
SOUTH RIVERSIDE PARK	
INDEX # 785469	
BOARD OF PARK COMMISSIONERS WICHITA, KANSAS	
DATE 5-23-75	DRAWN BY KRE:KTM
SCALE 1"=30'-0"	SHEET 2 OF 6