

NOTE: Kansas Gas Service will relocate a portion of their existing lines prior to construction. Contractor shall be responsible for confirming that the relocation work has been completed prior to beginning work.

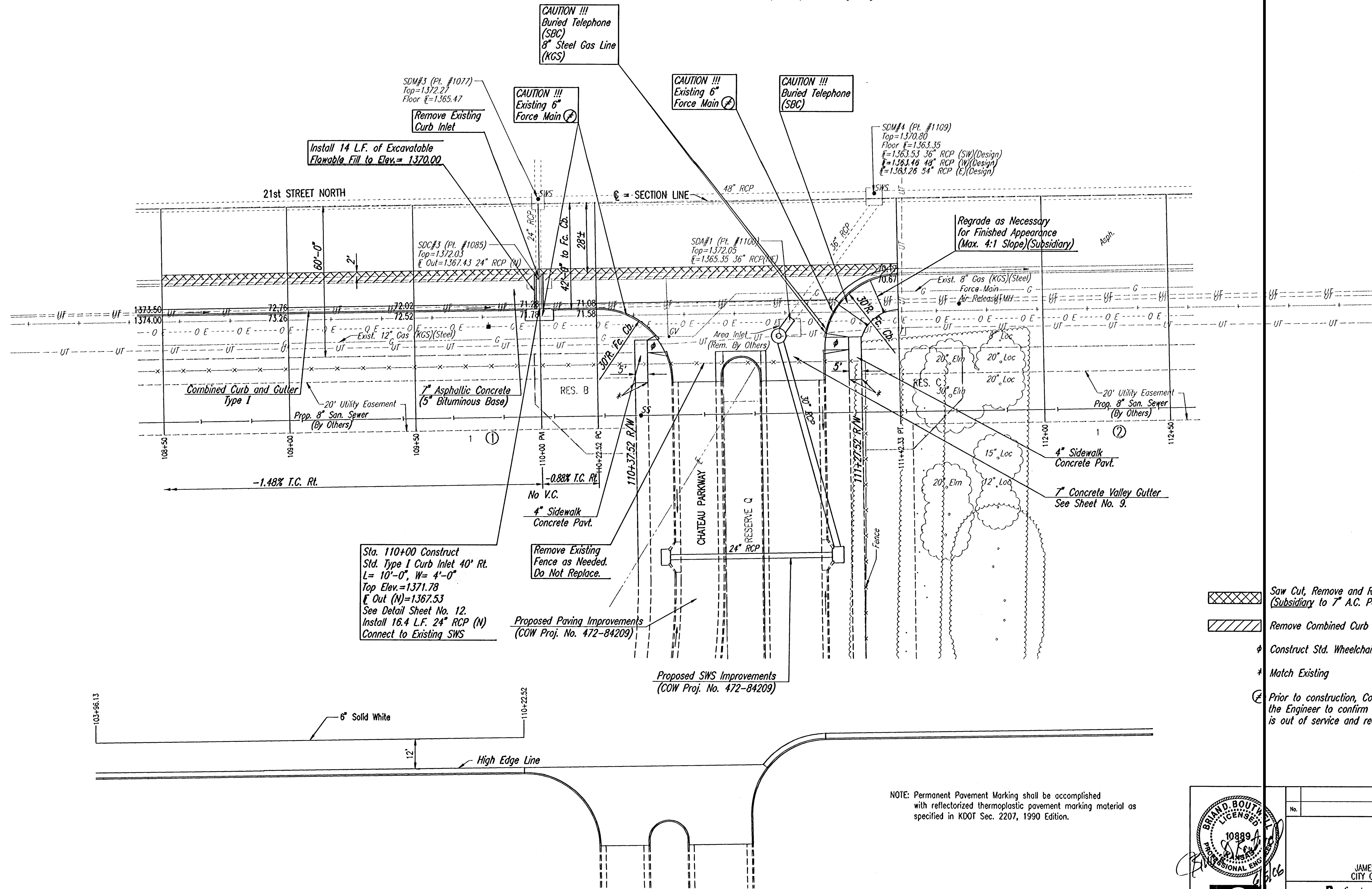
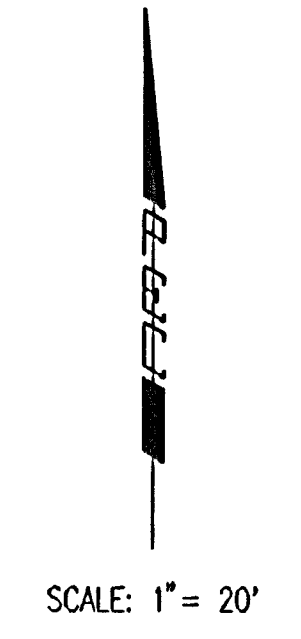

Sta. 110+00 Construct
Std. Type I Curb Inlet 40" RT.
L= 10'-0", W= 4'-0"
Top Elev.=1371.78
E Out (N)=1367.53
See Detail Sheet No. 12
Install 16.4 L.F. 24" RCP (N)
Connect to Existing SWS

Proposed Paving Improvements
(COW Proj. No. 472-84209)

Proposed SWS Improvements
(COW Proj. No. 472-84209)

NOTE: Permanent Pavement Marking shall be accomplished with reflectorized thermoplastic pavement marking material as specified in KDOT Sec. 2207, 1990 Edition.

MARKING PLAN

- Saw Cut, Remove and Replace Asphalt Surface (Subsidiary to 7" A.C. Pavt.)
- Remove Combined Curb and Gutter
- Construct Std. Wheelchair Ramp
- Match Existing
- Prior to construction, Contractor shall contact the Engineer to confirm that the force main is out of service and ready to be abandoned.

Solved 06-05-2006 9:06:08 AM by BJS
 Plot Date 11-20-06 05:20:06 9:07:54 AM by BJS
 C:\000\04688\003\04688-C-SPR106-50-112-50

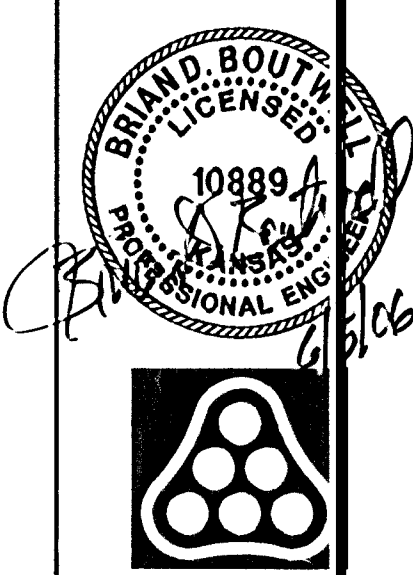

No.	Revision	By	Date
OAK CREEK - PHASE 1 21ST ST. N. DECEL LANE PAVING PLAN 108+60 TO 112+50 JAMES L. ARMOUR, P.E. - CITY ENGINEER CITY OF WICHITA PROJECT NO. 472-84206 Professional Engineering Consultants, P.A. 303 S. TOPEKA • WICHITA, KANSAS 67202 316-262-2691 • FAX 316-262-3003			
Designed by	BDB, BLB	Job No.	35-04688-003
Drawn by	BJS, JMU	Date	October 2004
			Sheet 6 of 28