

PLAN NOTES

1. E.C. SHALL COORDINATE ALL WORK WITH IRRIGATION CONTRACTOR.
2. E.C. SHALL USE EXISTING 6" SLEEVES BETWEEN ISLANDS AND CURB. E.C. SHALL REWORK THE EXISTING 6" SLEEVES TO ALLOW 36"-48" COVER.
3. E.C. SHALL MAINTAIN A MIN. COVER OF 36" OVER ALL U.G. CONDUITS. E.C. SHALL INCREASE CONDUIT COVER WITHIN THE STREET ISLANDS TO 48" MIN. TO CLEAR THE IRRIGATION AND TREE PLANTING EXCAVATION. MAINTAIN 12" CLEARANCE UNDER ALL IRRIGATION PIPING.
4. E.C. SHALL PROVIDE 1ea. 15 AMP 120 VOLT UNSWITCHED CIRCUIT TO THE IRRIGATION CONTROLLER. IRRIGATION CONTROL PROVIDED AND MOUNTED BY IRRIGATION CONTRACTOR.

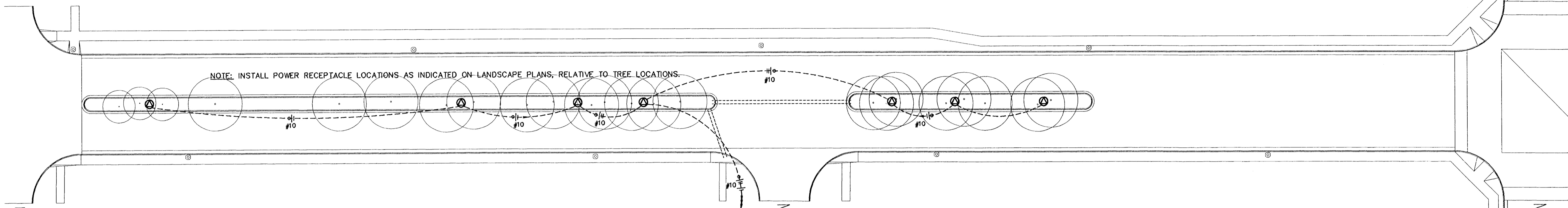

3ea. 20A 120V
CIRCUITS FROM
METER PEDESTAL

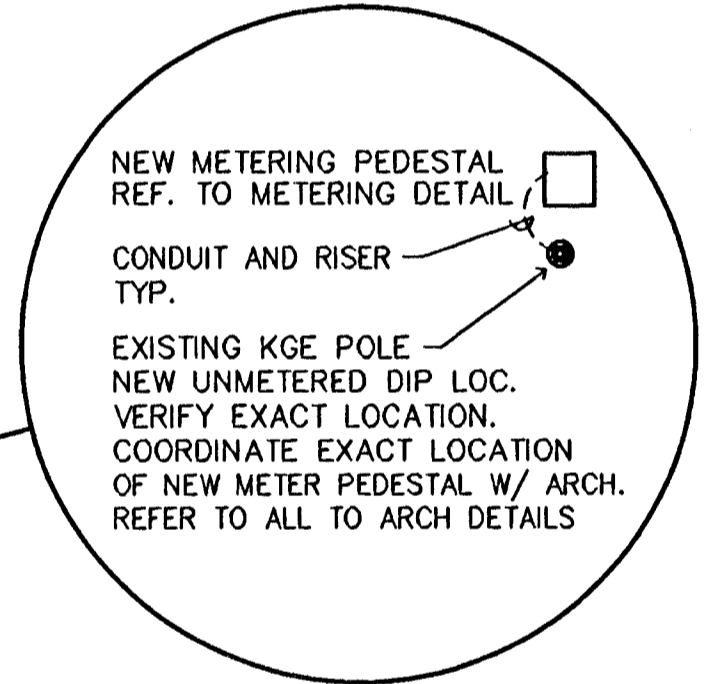

ELECTRICAL PLAN NO. 1
1" = 30'

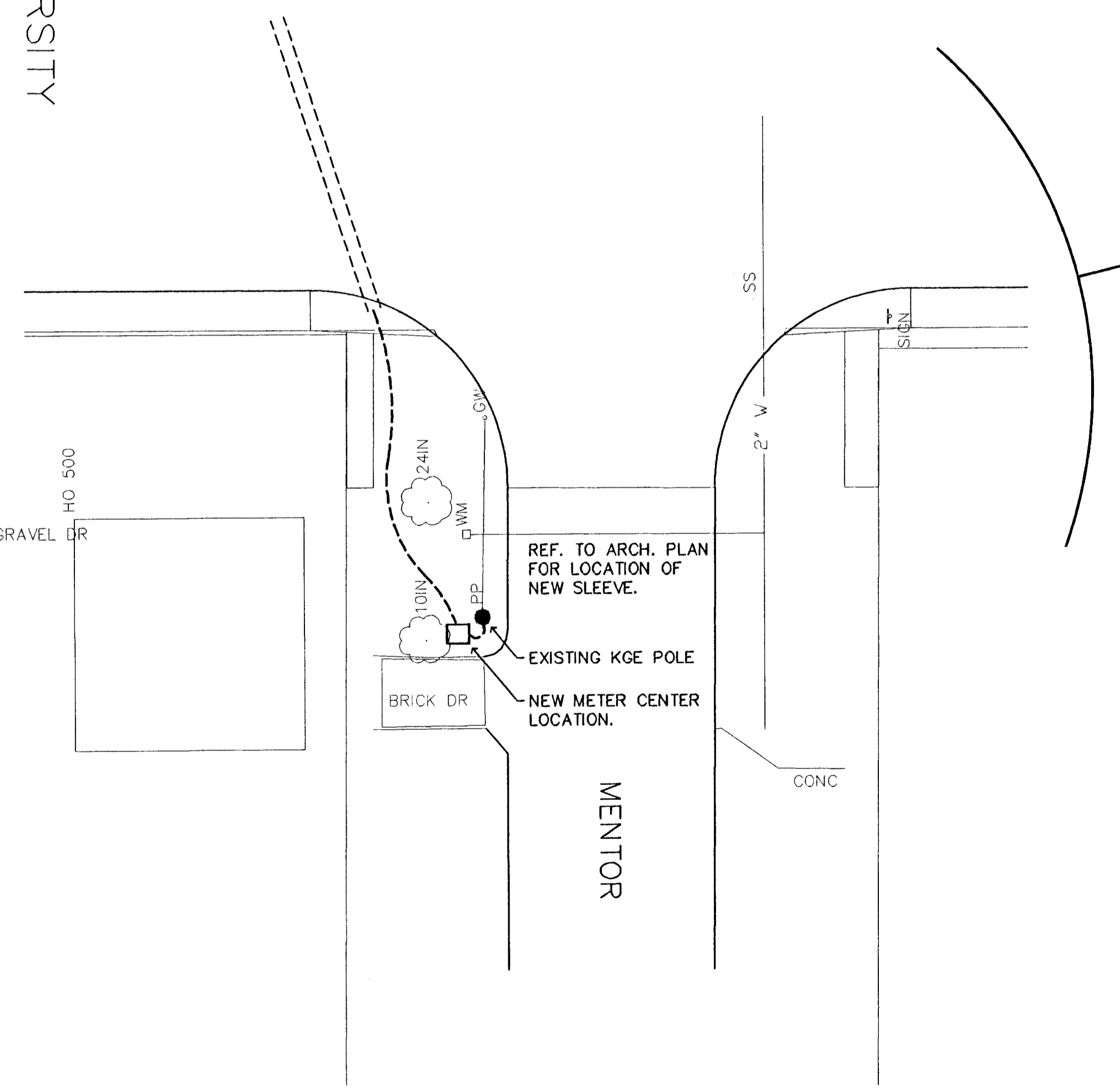
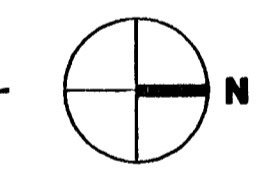

METER CENTER #1

ELECTRICAL KEY PLAN

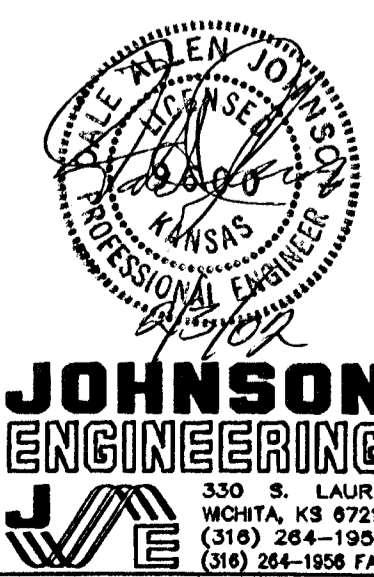
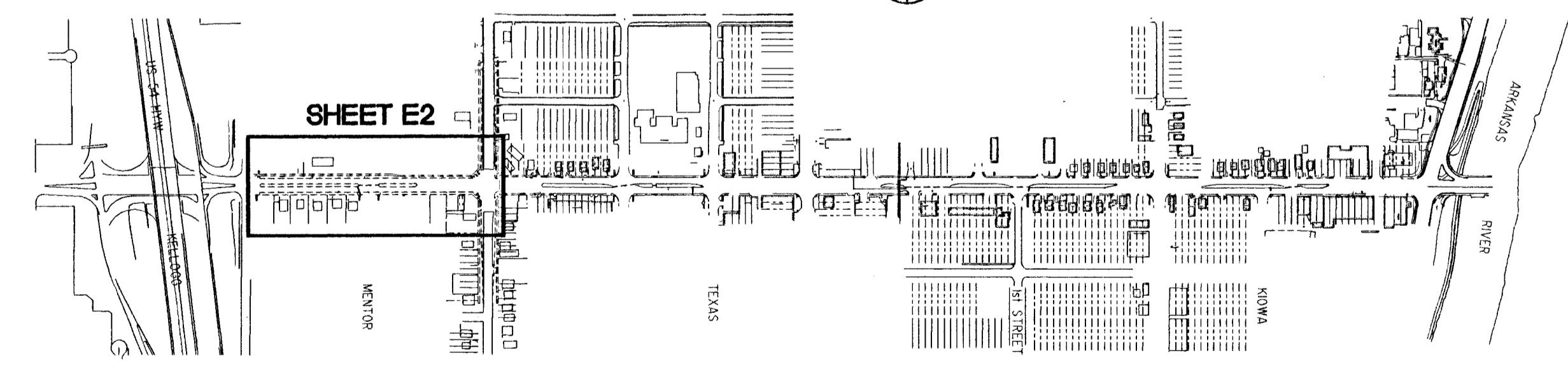

JOHNSON ENGINEERING
ENGINEERING CONSULTANTS
411 N. WEBB ROAD
WICHITA, KS. 67206
316-684-9600



SENECA STREET
PROJECT NAME

ELECTRICAL PLAN NO. 1
SHEET TITLE

DAJ DESIGN BY	DAJ DRAWN BY	DAJ CHECKED BY
2/3/03 DATE	E2 DRAWING NAME	E2 / 5 SHEET / OF