

BENCHMARKS:
 BM #1: Cross on South West Corner of Lot 25 Block H, The Fairmont Addition.
 Elev. = 204.61 (City Datum)
 BM #2: "D" Cut on Curb at North East Entrance to Church of the Magdalen 2nd Addition.
 Elev. = 190.48 (City Datum)

P.V.I. Elev. = 201.70
 No V.C.
 Sta 2+19.38-PT
 Sta 2+44.26

P.V.I. Elev. = 201.40
 No V.C.
 Sta 1+65.60-PC
 Sta 1+65.60-PC

P.V.I. Elev. = 199.65
 30' V.C.
 Sta 0+00
 Sta 0+49.99

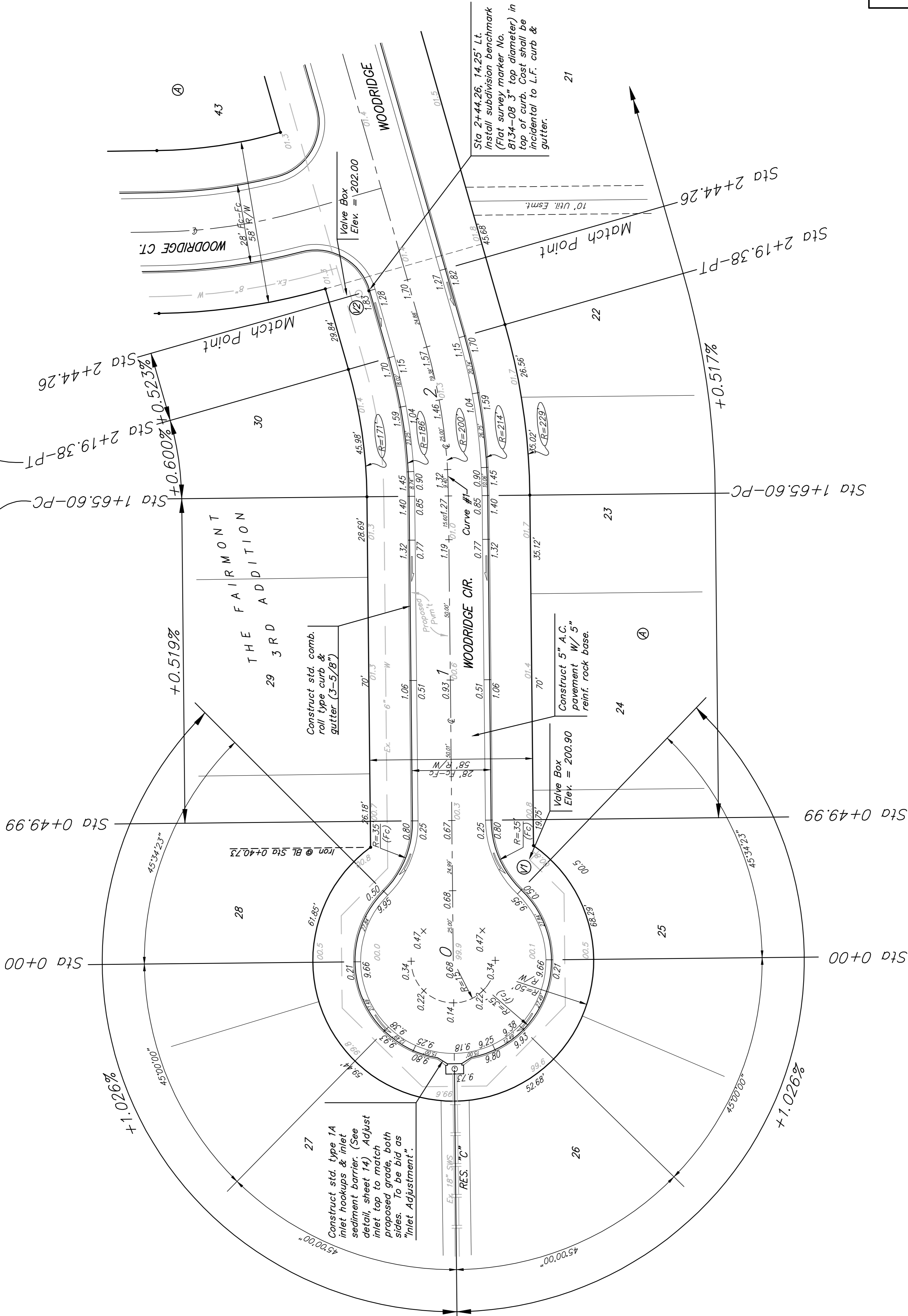

Curve #1
 Curve Data Based on Centerline

Station	Arc	Defl.	T. Defl.
1+65.60	9.40'	8.37'	10.43'
1+75.00	25.00'	22.24'	27.73'
2+00.00	19.38'	17.24'	21.50'
2+19.38			7*42'12"

FACE	CHORD	LENGTHS
B' Lt.	B' Rt.	
0700.00"	0700.00"	
1204.77"	1204.77"	
3344.51"	3344.51"	
2463.33"	2463.33"	

Rad. = 200' Delta = 15° 24' 25" Tangent = 27.05'
 Arc = 53.78' L.C. = 53.62' Del/FT. = 8.59443 Min.

NOTE:
 ROLL TYPE CURB & GUTTER TO BE CONSTRUCTED ON THE PAVEMENT SHOWN ON THIS SHEET. TOP OF CURB ELEVATIONS ARE GIVEN FOR FULL HEIGHT CURB.

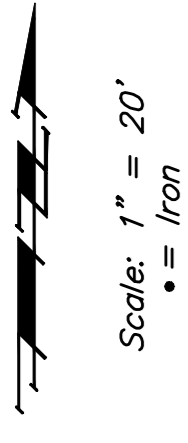

THE FAIRMONT 3RD ADD. - PH. II

WOODRIDGE
 Sta 0+00 TO STA 2+44.26

Engineering Company, P.C., 115 Elm St., Suite 6711, Providence, RI 02903
 ENGINEERING | SURVEYING | PLANNING | LANDSCAPE ARCHITECTURE

PROJECT NUMBER: 472-24137
 DESIGN AID
 APPROVED
 SCALE Noted
 SHEET

DRAWN TMS
 DATE 3/07
 REVISIONS:

5 OF 20

The Fairmont 3rd Set