

$\Delta = 29^{\circ}40'20''$ $L = 146.04'$ $R = 282.00'$ $T = 74.70'$

STATION	CL ARC	CHORD LENGTH		RT. DEFLECTION	TOTAL DEFLECTION
		8' LT.	8' RT.		
15+70.69 P.C.	4.31'	3.92'	4.31'	00.00'	0'26'16"
16+00.00	25.00'	22.73'	24.99'	00.00'	2'32'23"
16+25.00	25.00'	22.73'	24.99'	00.00'	2'32'23"
16+50.00	25.00'	22.73'	24.99'	00.00'	2'32'23"
16+75.00	25.00'	22.73'	24.99'	00.00'	2'32'23"
16+75.51	7.51'	6.83'	7.51'	00.00'	0'45'47"
16+75.00	17.49'	15.91'	17.49'	00.00'	1'46'36"
16+82.51	7.51'	6.83'	7.51'	00.00'	0'45'47"
17+00.00	17.49'	15.91'	17.49'	00.00'	1'46'36"
17+07.51	7.51'	6.83'	7.51'	00.00'	0'45'47"
17+16.73 P.T.	9.22'	8.39'	9.22'	00.00'	0'58'12"

DEFLECTION/FOOT = 0.101588262 DEGREES 6.095295693 MINUTES

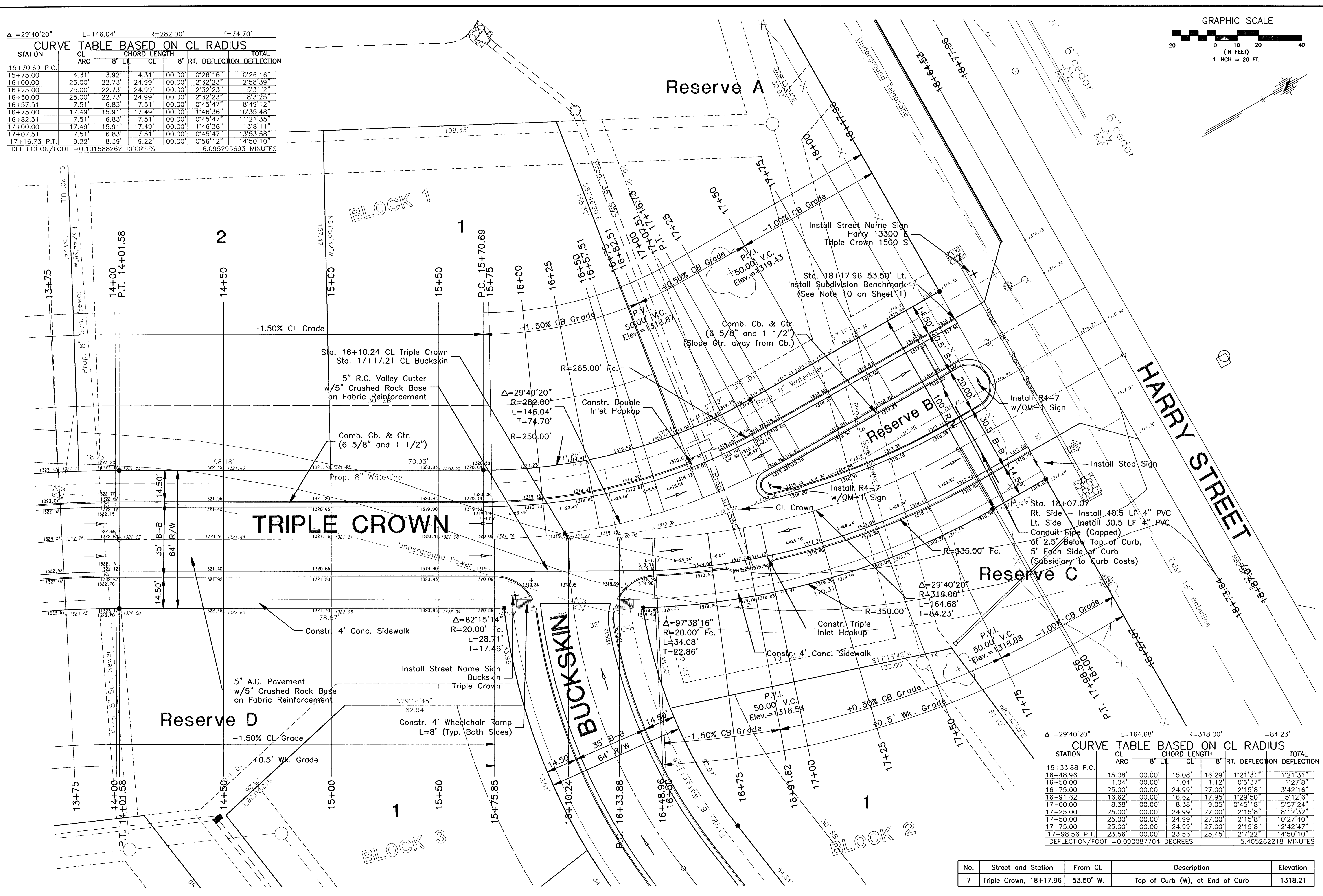
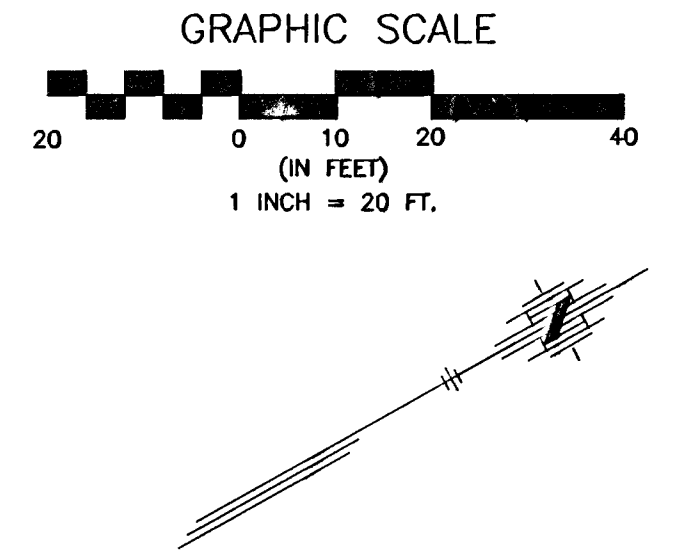

$\Delta = 29^{\circ}40'20''$ $L = 164.68'$ $R = 318.00'$ $T = 84.23'$

STATION	CL ARC	CHORD LENGTH		RT. DEFLECTION	TOTAL DEFLECTION
		8' LT.	8' RT.		
16+33.88 P.C.	15.08'	00.00'	15.08'	16.29'	1'21'31"
16+48.96	1.04'	00.00'	1.04'	1.12'	0'5'37"
16+50.00	25.00'	00.00'	24.99'	27.00'	2'15'8"
16+75.00	25.00'	00.00'	24.99'	27.00'	2'15'8"
16+91.62	16.62'	00.00'	16.62'	17.95'	1'29'50"
17+00.00	8.38'	00.00'	8.38'	9.05'	0'45'18"
17+25.00	25.00'	00.00'	24.99'	27.00'	2'15'8"
17+50.00	25.00'	00.00'	24.99'	27.00'	2'15'8"
17+75.00	25.00'	00.00'	24.99'	27.00'	2'15'8"
17+98.56 P.T.	23.56'	00.00'	23.56'	25.45'	2'7'22"

DEFLECTION/FOOT = 0.090087704 DEGREES 5.405262218 MINUTES

No.	Street and Station	From CL	Description	Elevation
7	Triple Crown, 18+17.96	53.50' W.	Top of Curb (W), at End of Curb	1318.21

DESIGNED BY: J. Dickman
 DRAWN BY: J. Dickman
 P.O. BOX NO.: 16944
 DATE: March 2002

POE & ASSOCIATES OF KANSAS, INC.
 CONSULTING ENGINEERS
 5940 E. Central, Suite 200 • Wichita, KS 67208-0242
 Phone 316.685-4114 • FAX 316.685-4444

EQUINE ESTATES - PHASE 1
 STREET IMPROVEMENTS
 TRIPLE CROWN
 CITY OF WICHITA, KANSAS
 MICHAEL E. LINDBERGH, P.E. - CITY ENGINEER
 C.O.M. Project # 472-53424 O.C.A. # 785705

FINAL

11 of 112

G:\APPROVAL\PLANS\BASE-ST.dwg Thu Mar 28 13:55:28 2002 James Ubart - Poe & Associates of Kansas, Inc.