

G:\APPS\DWG\PROJECTS\BASE-ST.dwg Thu Mar 26 15:16:50 2003 James Uberty - Poe & Associates of Kansas, Inc.

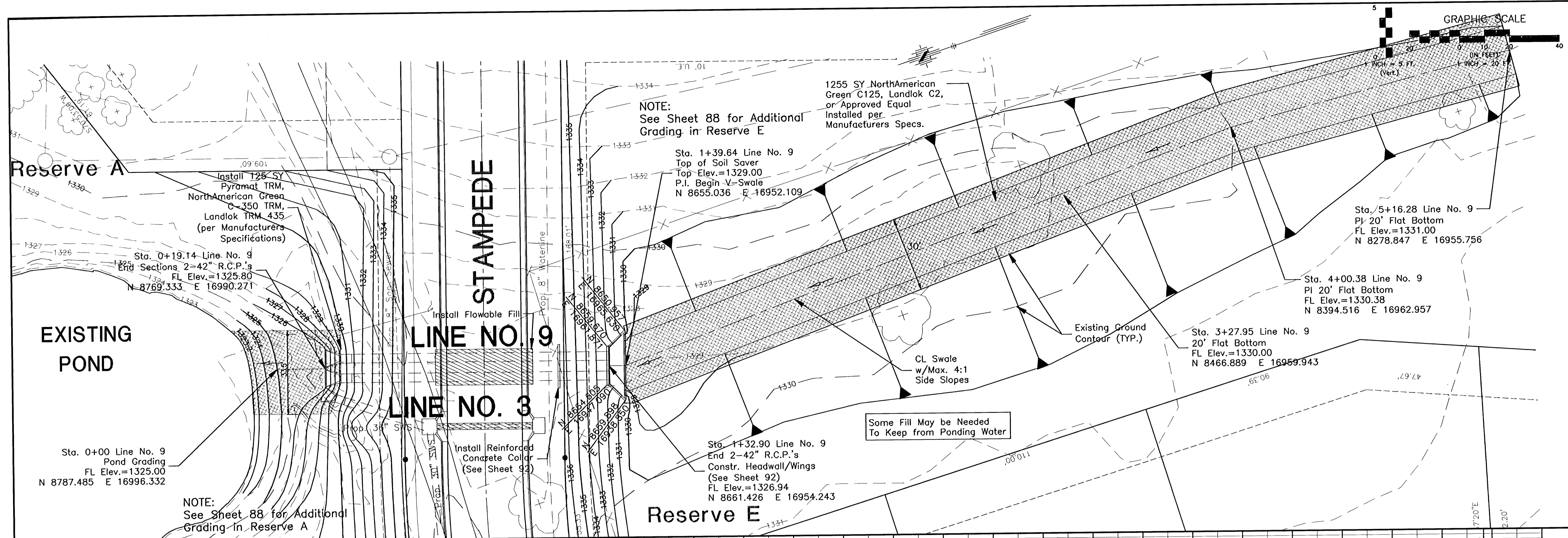

Station	Line No. 9	Line No. 3	LINE NO. 9	Line No. 9
0+00	Sta. 0+00 Line No. 9 Pond Grading FL=1325.00			
0+19.14	Sta. 0+19.14 Line No. 9 End Sections 2'-42" R.C.P.'s FL=1325.80			
0+63.40	Sta. 0+63.40 Line No. 9 Prop. 8" Sanitary Sewer FL=1326.09			
1+02.40	Sta. 1+02.40 Line No. 9 Prop. 8" Waterline FL=1324.24			
1+08.60	Sta. 1+08.60 Line No. 9 Prop. 8" Waterline FL=1324.24			
1+13.00	Sta. 1+13.00 Line No. 9 Install Reinf. Conc. Collar FL=1326.70			
1+32.90	Sta. 1+32.90 Line No. 9 End 2'-42" R.C.P.'s Constr. Headwall/Wings (See Sheet 92) FL=1326.94			
1+39.64	Sta. 1+39.64 Line No. 9 Top of Soil Saver Top Elev.=1329.00 P.I. Begin V-Swale N 8655.036 E 16952.109			
3+27.95	Sta. 3+27.95 Line No. 9 20' Flat Bottom FL Elev.=1330.00 N 8466.889 E 16959.943			
4+00.38	Sta. 4+00.38 Line No. 9 20' Flat Bottom FL Elev.=1330.38 N 8394.516 E 16962.957			
5+16.28	Sta. 5+16.28 Line No. 9 20' Flat Bottom FL Elev.=1331.00 N 8278.847 E 16955.756			

DESIGNED BY: J. Uberty / J. Dickman
 DRAWN BY: J. Dickman
 POE JOB NO.: 1694A
 DATE: March 2002

FINAL

POE & ASSOCIATES OF KANSAS, INC.
 CONSULTING ENGINEERS
 5940 E. Central, Suite 200 • Wichita, KS 67208-6142
 Phone 316.685-4114 • FAX 316.685-4444

EQUINE ESTATES - PHASE 1
 STORM WATER SEWER
 LINE NUMBER 9

CITY OF WICHITA, KANSAS
 MICHAEL E. LINDBERGH, P.E. - CITY ENGINEER
 C.O.W. Proj# 472-83424 O.C.A.# 785705

Sheet 28 of 112