

Field Bend and/or Cut Reinforcing Steel as Req'd for Clearance Around Pipes. No Deduction in Steel Quantities has been Made for Pipe Openings

BILL OF MATERIAL			
Bar	Number	Size	Length
a1	21	#4	5'-9"
d1	8	#4	11'-3"
d2	4	#4	3'-6"
h1	6	#4	9'-9"
h2	2	#4	6'-0"
h3	2	#4	1'-0"
v1	10	#4	4'-3"
v2	10	#4	5'-9"
v3	6	#4	3'-3"
v4	6	#4	4'-3"
w1	2	#4	10'-3"
*Concrete			13.1 C.Y.
Reinf. Steel			310 Lbs.
Struct. Steel			375 Lbs.

*No deduction for grate recess.

GENERAL NOTES

Concrete used for shaping shall be concrete pavement slab. Bevel all exposed edges with a 3/4" triangular moulding. The pipe shown on this sheet may or may not indicate that the pipe installed will be reinforced concrete, steel, or aluminum.

Payment shall be per each for "Special Inlet". This price shall be full compensation for all labor and materials necessary to complete the work.

Floor of inlet shall be shaped as shown. All reinforcing steel shall have 1 1/2" minimum cover. All slips of reinforcing steel shall have a minimum overlap of 16 inches.

Steel for grates shall be fabricated from standard or commercial grade structural steel and black steel pipe. The unit shall be hot dipped, galvanized after fabrication, in accordance with ASTM A123 except the weight of coating shall average not less than 2.0 ounces per square foot of actual surface and no individual test shall show less than 1.8 ounces of coating per square foot of actual surface area.

All welds required in the construction of grate shall be 1/4" continuous butt-welds.

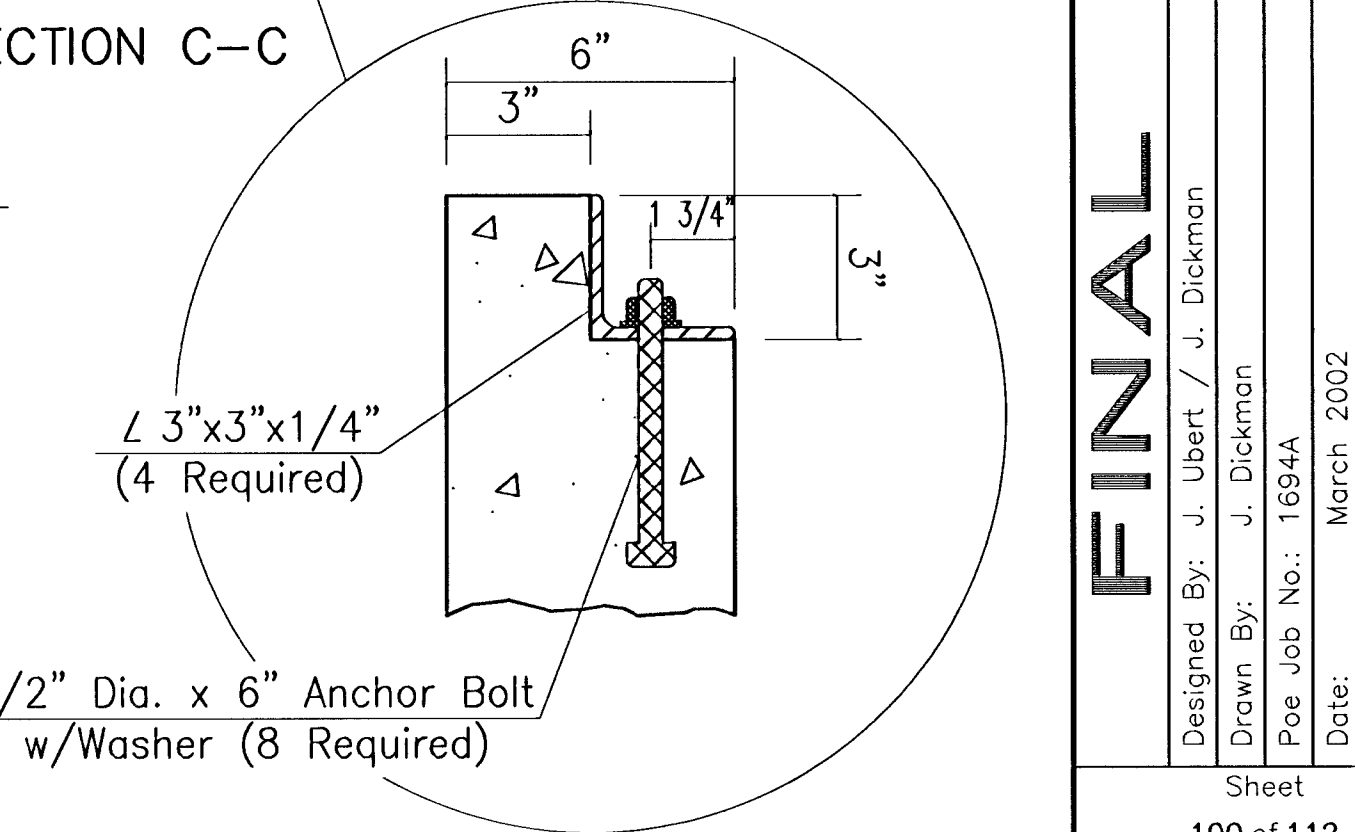

6:\APP5\OCA\PSA\BASE-ST.dwg Thu Mar 21 14:31:45 2002 Bernhard Kullila - POE & ASSOCIATES OF KANSAS INC.

EQUESTRIAN ESTATES - PHASE 1
 STREET IMPROVEMENTS
 SPECIAL INLET
 CITY OF WICHITA, KANSAS
 MICHAEL E. LINDBERGH, P.E. - CITY ENGINEER
 C.O.W. Project # 472-83424 O.C.A. # 76705

POE & ASSOCIATES OF KANSAS, INC.
 CONSULTING ENGINEERS
 5940 E. Central, Suite 200 Wichita, KS 67208-4342
 Phone 316-685-4174 FAX 316-685-4444

FINAL
 Designed By: J. Ubert / J. Dickman
 Drawn By: J. Dickman
 P.O. Job No.: 1694A
 Date: March, 2002

Sheet
 100 of 112