

$\Delta = 46^{\circ}13'21''$ $L = 413.85'$ $R = 513.00'$ $T = 218.93'$

STATION	CHORD LENGTH		TOTAL DEFLECTION	
	8' LT.	8' RT.	DEFLECTION	DEFLECTION
4+94.85 P.C.				
5+00.00	5.15'	5.39'	5.15'	4.91'
5+25.00	25.00'	26.14'	25.00'	23.85'
5+50.00	25.00'	26.14'	25.00'	23.85'
5+75.00	25.00'	26.14'	25.00'	23.85'
6+00.00	25.00'	26.14'	25.00'	23.85'
6+25.00	25.00'	26.14'	25.00'	23.85'
6+42.03	17.03'	17.81'	17.03'	16.25'
6+50.00	7.97'	8.34'	7.97'	7.60'
6+75.00	25.00'	26.14'	25.00'	23.85'
7+00.00	25.00'	26.14'	25.00'	23.85'
7+25.00	25.00'	26.14'	25.00'	23.85'
7+50.00	25.00'	26.14'	25.00'	23.85'
7+75.00	25.00'	26.14'	25.00'	23.85'
8+00.00	25.00'	26.14'	25.00'	23.85'
8+25.00	25.00'	26.14'	25.00'	23.85'
8+50.00	25.00'	26.14'	25.00'	23.85'
8+75.00	25.00'	26.14'	25.00'	23.85'
9+00.00	25.00'	26.14'	25.00'	23.85'
9+08.70 P.T.	8.70'	9.10'	8.70'	8.31'
DEFLECTION/FOOT = .055843840 DEGREES				3.350630381 MINUTES

$\Delta = 63^{\circ}31'38''$ $L = 174.96'$ $R = 157.80'$ $T = 97.70'$

STATION	CHORD LENGTH		TOTAL DEFLECTION	
	8' LT.	8' RT.	DEFLECTION	DEFLECTION
9+08.70 P.C.				
9+16.73	8.03'	6.73'	8.03'	9.33'
9+25.00	8.27'	6.93'	8.27'	9.61'
9+50.00	25.00'	20.94'	24.97'	29.01'
9+75.00	25.00'	20.94'	24.97'	29.01'
10+00.00	25.00'	20.94'	24.97'	29.01'
10+25.00	25.00'	20.94'	24.97'	29.01'
10+31.84	6.84'	5.73'	6.84'	7.94'
10+38.88	7.04'	5.90'	7.04'	8.18'
10+50.00	11.12'	9.32'	11.12'	12.91'
10+75.00	25.00'	20.94'	24.97'	29.01'
10+83.66 P.T.	8.66'	7.28'	8.66'	10.06'
DEFLECTION/FOOT = .181545562 DEGREES				10.892733748 MINUTES

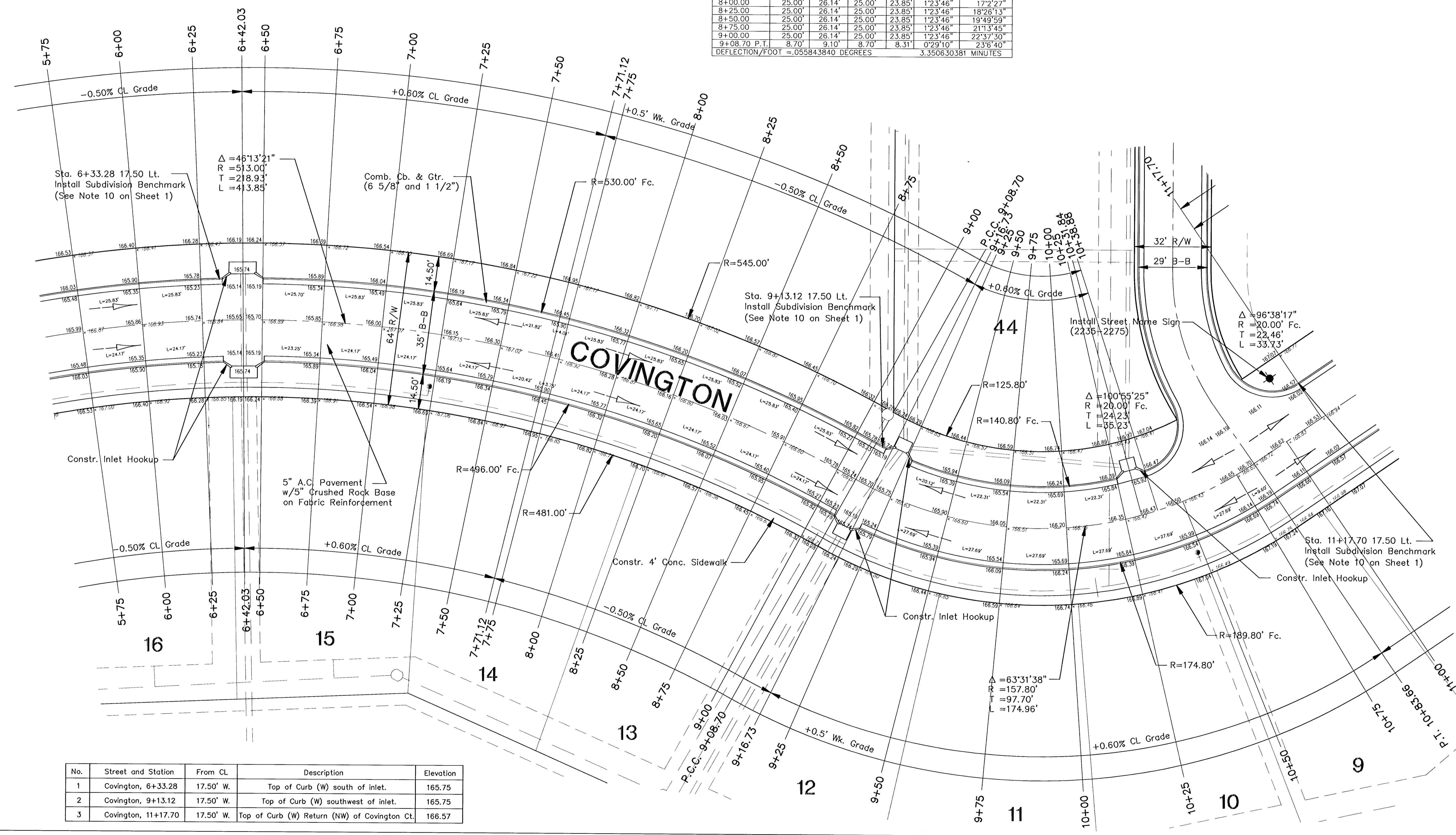

No.	Street and Station	From CL	Description	Elevation
1	Covington, 6+33.28	17.50' W.	Top of Curb (W) south of inlet.	165.75
2	Covington, 9+13.12	17.50' W.	Top of Curb (W) southwest of inlet.	165.75
3	Covington, 11+17.70	17.50' W.	Top of Curb (W) Return (NW) of Covington Cl.	166.57

THE LOCHS AT ABERDEEN
STREET IMPROVEMENTS
COVINGTON
CITY OF WICHITA, KANSAS
MICHAEL E. LINDBERGH, P.E. - CITY ENGINEER
Proj.# 472-83359 O.C.A.#

POE & ASSOCIATES OF KANSAS, INC.
CONSULTING ENGINEERS
5940 E. Central, Suite 200 • Wichita, KS 67208-4242
Phone 316/685-4114 • FAX 316/685-4444

PE

Engineer: J. Ubert
Drawn By: B. Kulla
Poe Job No.: 1656B
Date: May 2001

10/1/01 JMU
10/1/01 JMU
Revised Curve Tables

5 of 58

G:\APPS\UDA\1656B\base.dwg Tue Oct 02 09:00:37 2001 James Ubert - Poe & Associates of Kansas, Inc.