

$\Delta = 27^{\circ}53'14''$ $L = 36.50'$ $R = 75.00'$ $T = 18.62'$

CURVE TABLE BASED ON CL RADIUS						
STATION	CL ARC	CHORD LENGTH		8' RT. DEFLECTION		TOTAL
		8' LT.	CL	8' RT.	DEFLECTION	DEFLECTION
0+51.96 P.C.	23.04'	29.83'	22.95'	16.06'	8'48"2"	8'48"2"
0+75.00	13.46'	17.48'	13.45'	9.41'	5'8"35"	13'56"37"
DEFLECTION/FOOT = .381971863 DEGREES		22.918311805 MINUTES				

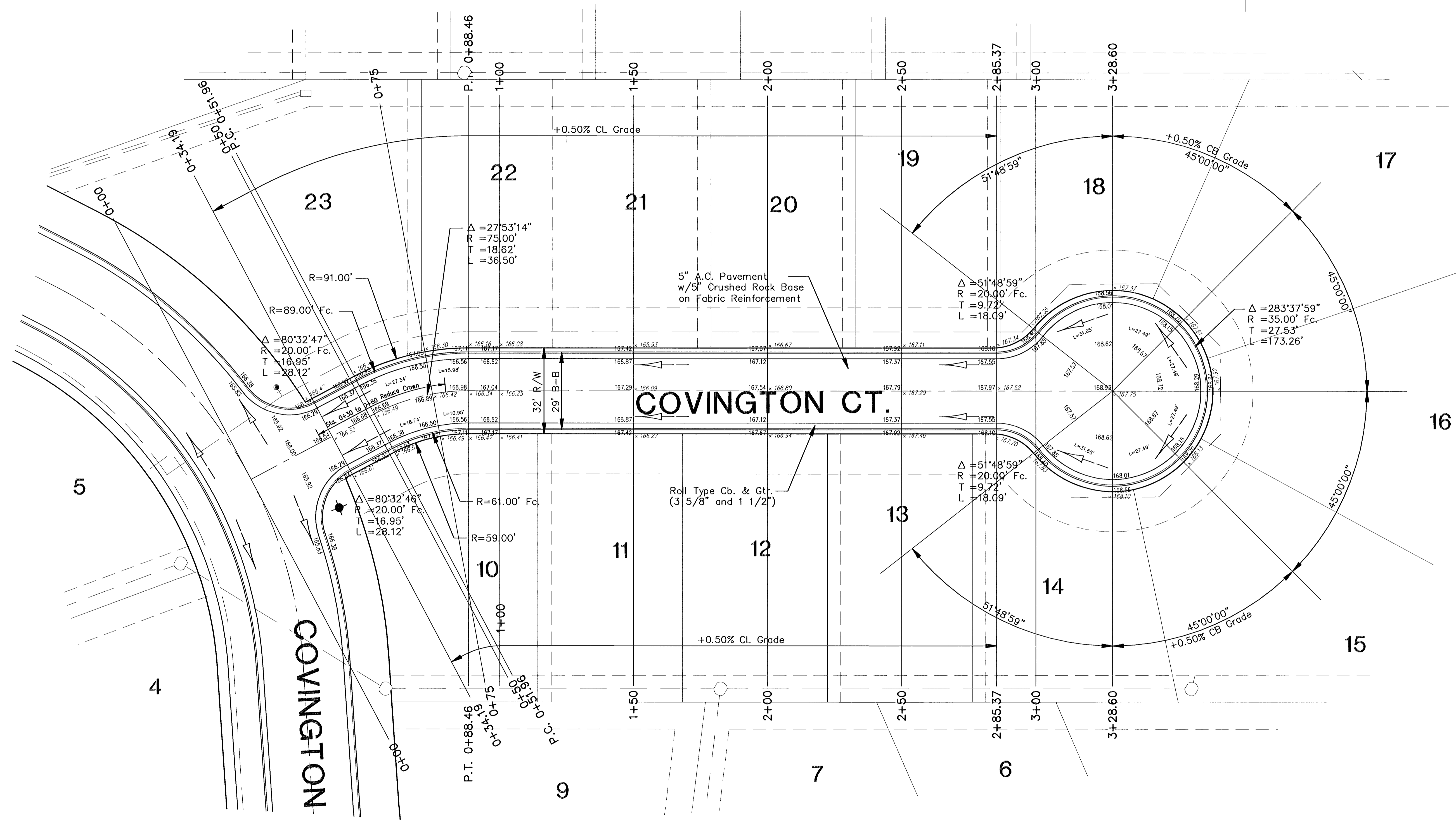
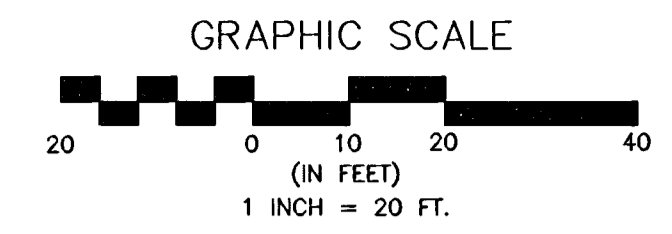

No.	Date	By	Approved	Revision
1	10/1/01	JMU	JMU	Revised Curve Tables

THE LOOKS AT ABERDEEN
STREET IMPROVEMENTS
COVINGTON COURT
CITY OF WICHITA, KANSAS
MICHAEL E. LINDBERGH, P.E. - CITY ENGINEER
Proj.# 472-83359 O.C.A.# 765681

POE & ASSOCIATES OF KANSAS, INC.
CONSULTING ENGINEERS
5940 E. Central, Suite 200 ■ Wichita, KS 67208-4242
Phone 316/685-4114 ■ FAX 316/685-4444

FINAL
Engineer: J. Ubert
Drawn By: B. Kulla
Poe Job No.: 16568
Date: May 2001

NOTE:
All top of curb grades are to top of combined curb and gutter. 0.25' must be subtracted from top of curb elevations for top of roll curb.

6: \APPS\DATA\16568\16568.dwg Tue Oct 02 11:03:54 2001 James Ubert - Poe & Associates of Kansas, Inc.