

$\Delta = 67'40.2''$ $L = 118.10'$ $R = 100.00'$ $T = 67.03'$

STATION	CL ARC	CHORD LENGTH			TOTAL DEFLECTION	
		8' LT.	CL	8' RT.	DEFECTION	DEFLECTION
0+41.10 P.C.						
0+50.00	8.90'	10.90'	8.90'	6.90'	2'32.59"	2'32.59"
0+75.00	25.00'	30.55'	24.93'	19.32'	7'9.43"	9'42.42"
1+00.00	25.00'	30.55'	24.93'	19.32'	7'9.43"	16'52.25"
1+25.00	25.00'	30.55'	24.93'	19.32'	7'9.43"	24'2.8"
1+29.71	4.71'	5.77'	4.71'	3.65'	1'20.58"	25'23.6"
1+41.89	12.18'	14.91'	12.17'	9.43'	3'29.22"	28'52.27"
1+50.00	8.11'	9.93'	8.11'	6.28'	2'19.24"	31'11.51"
1+59.20 P.T.	9.20'	11.27'	9.20'	7.13'	2'38.10"	33'50.1"
DEFLECTION/FOOT = .286478898 DEGREES					17.188733854 MINUTES	

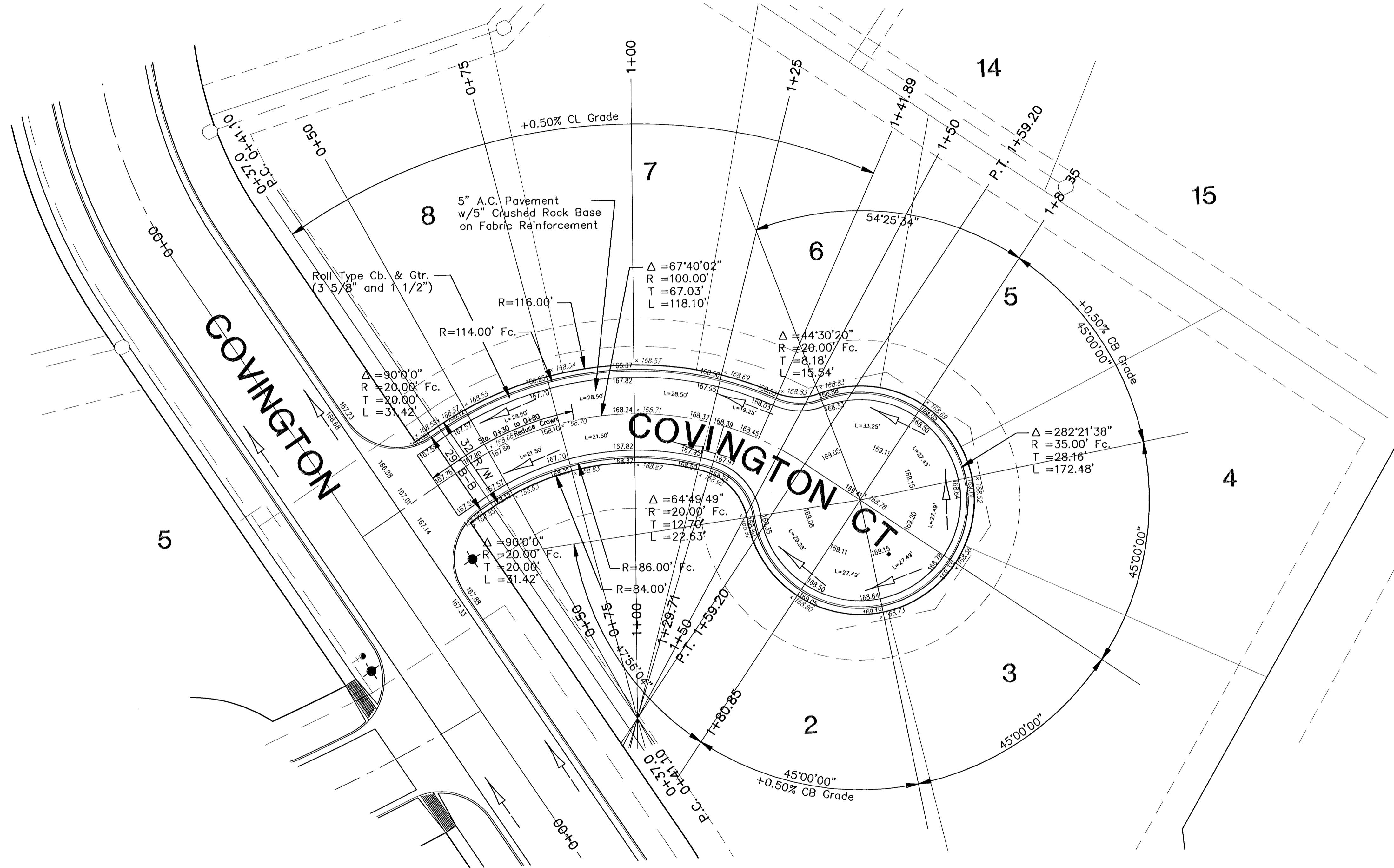
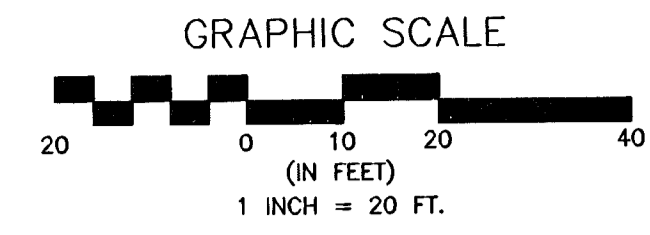

No.	Date	By	Appraised	Revision
1	10/7/01	JMU		Revised Curve Tables

THE LOCHS AT ABERDEEN
STREET IMPROVEMENTS
COVINGTON COURT
CITY OF WICHITA, KANSAS
MICHAEL E. LINDBLAK, P.E., CITY ENGINEER
Proj.# 472-83359 C.C.A.# 765681

POE & ASSOCIATES OF KANSAS, INC.
CONSULTING ENGINEERS
5940 E. Central, Suite 200 ■ Wichita, KS 67208-4242
Phone 316/685-4114 ■ FAX 316/685-4444

FINAL
Engineer: J. Ubert
Drawn By: B. Kullie
Poe Job No.: 1655B
Date: May 2001

NOTE:
All top of curb grades are to top of combined curb and gutter. 0.25' must be subtracted from top of curb elevations for top of roll curb.