

$\Delta = 11^{\circ}39'31''$      $L = 105.81'$      $R = 520.00'$      $T = 53.09'$

STATION	CL ARC	CHORD LENGTH		8' RT.	DEFLECTION	TOTAL DEFLECTION
		8' LT.	CL			
0+00.00 P.C.						
0+25.00	25.00'	26.08'	25.00'	23.92'	1'22'38"	1'22'38"
0+33.22	8.22'	8.58'	8.22'	7.86'	0'27'10"	1'49'49"
0+41.62	8.40'	8.76'	8.40'	8.04'	0'27'46"	2'17'35"
0+50.00	8.38'	8.74'	8.38'	8.02'	0'27'42"	2'45'17"
0+61.08	11.08'	11.56'	11.08'	10.60'	0'36'38"	3'21'54"
0+63.91	2.83'	2.95'	2.83'	2.71'	0'9'21"	3'31'15"
0+75.00	11.09'	11.57'	11.09'	10.61'	0'36'39"	4'7'55"
1+00.00	25.00'	26.08'	25.00'	23.92'	1'22'38"	5'30'33"
1+05.81 P.T.	5.81'	6.06'	5.81'	5.56'	0'19'12"	5'49'46"
DEFLECTION/FOOT = .055092096 DEGREES				3.305525741 MINUTES		

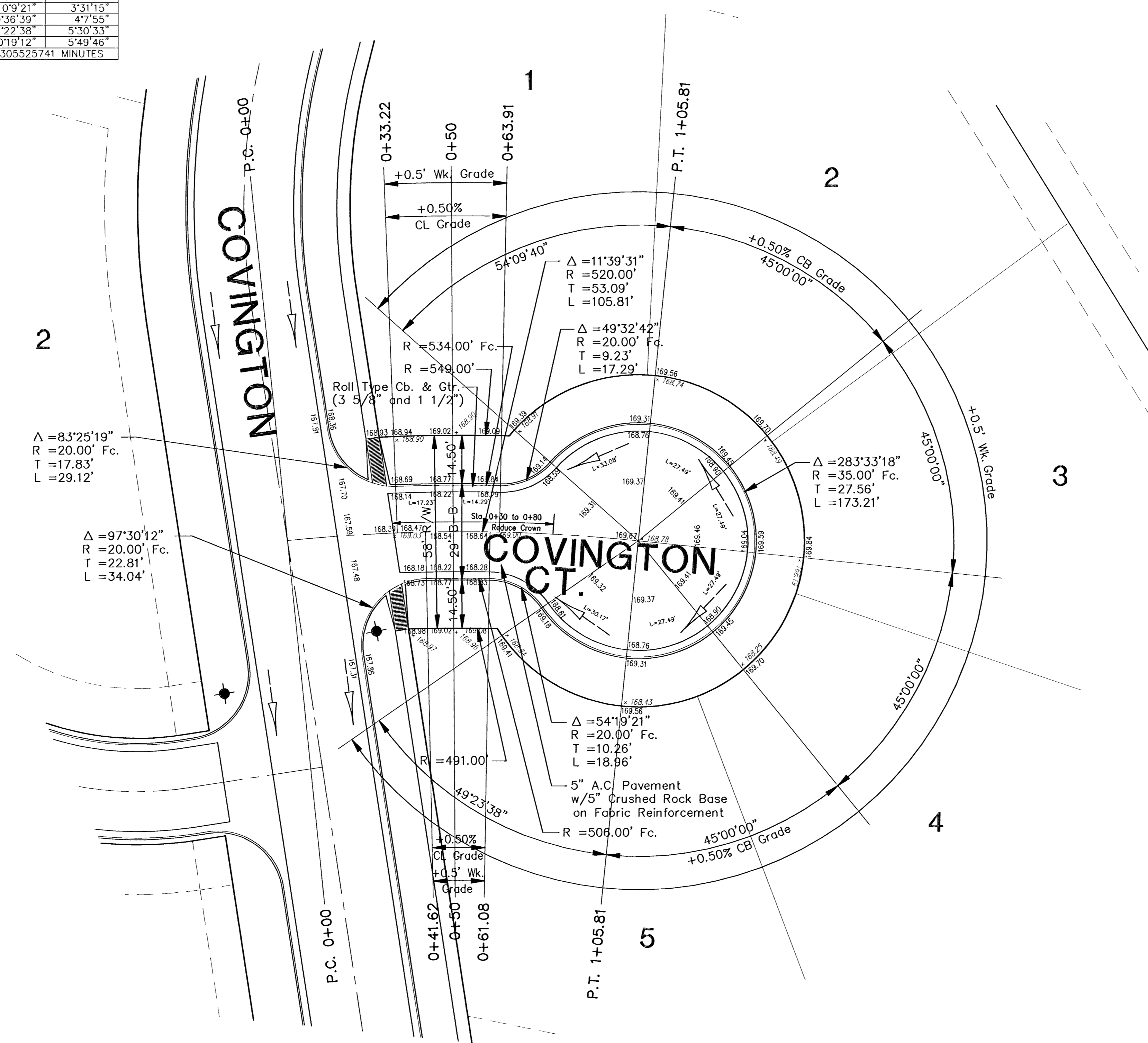
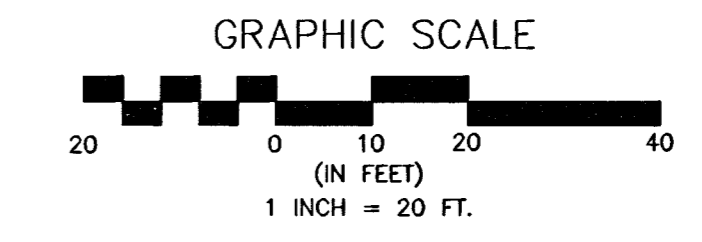

THE LOCHS AT ABERDEEN  
STREET IMPROVEMENTS  
COVINGTON COURT  
CITY OF WICHITA, KANSAS  
MICHAEL E. LINDBERGH, P.E. - CITY ENGINEER  
Proj.# 472-63359 O.C.A.#

POE & ASSOCIATES OF KANSAS, INC.  
CONSULTING ENGINEERS  
5940 E. Central, Suite 200 ■ Wichita, KS 67208-4242  
Phone 316/685-4114 ■ FAX 316/685-4444

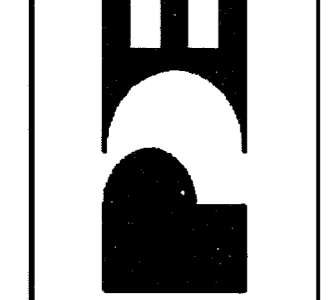

**FINAL**

Engineer: J. Ubert  
Drawn By: B. Kulla  
Poe Job No.: 1656B  
Date: May 2001

NOTE:  
All top of curb grades are to top of combined curb and gutter. 0.25' must be subtracted from top of curb elevations for top of roll curb.