

DEETER #2433 GRATE

24" x 24" Frame and Grate Detail

NOTE: Grates shall be imprinted on the top surface with "CITY OF WICHITA" using letters at least 1" in height. Other marking methods may be approved by the engineer.

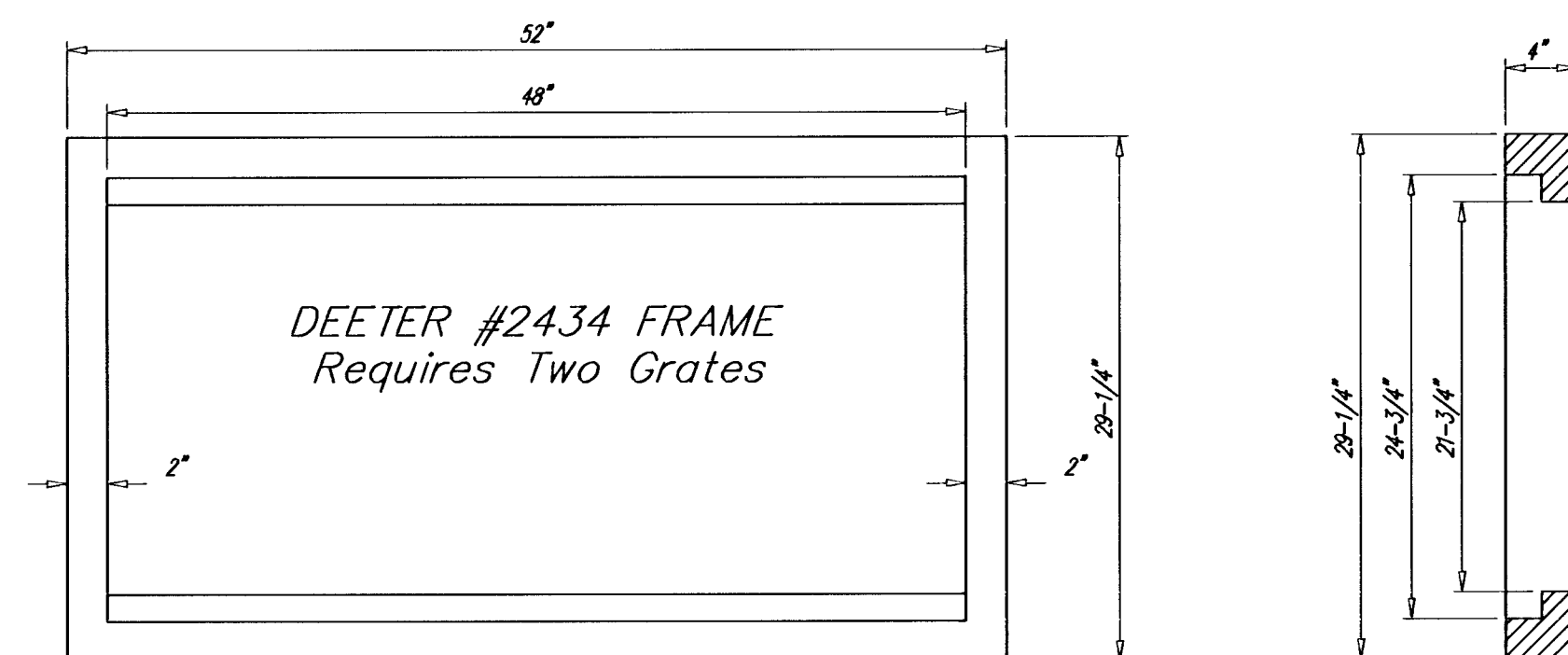

Double 24" x 24" Frame Detail

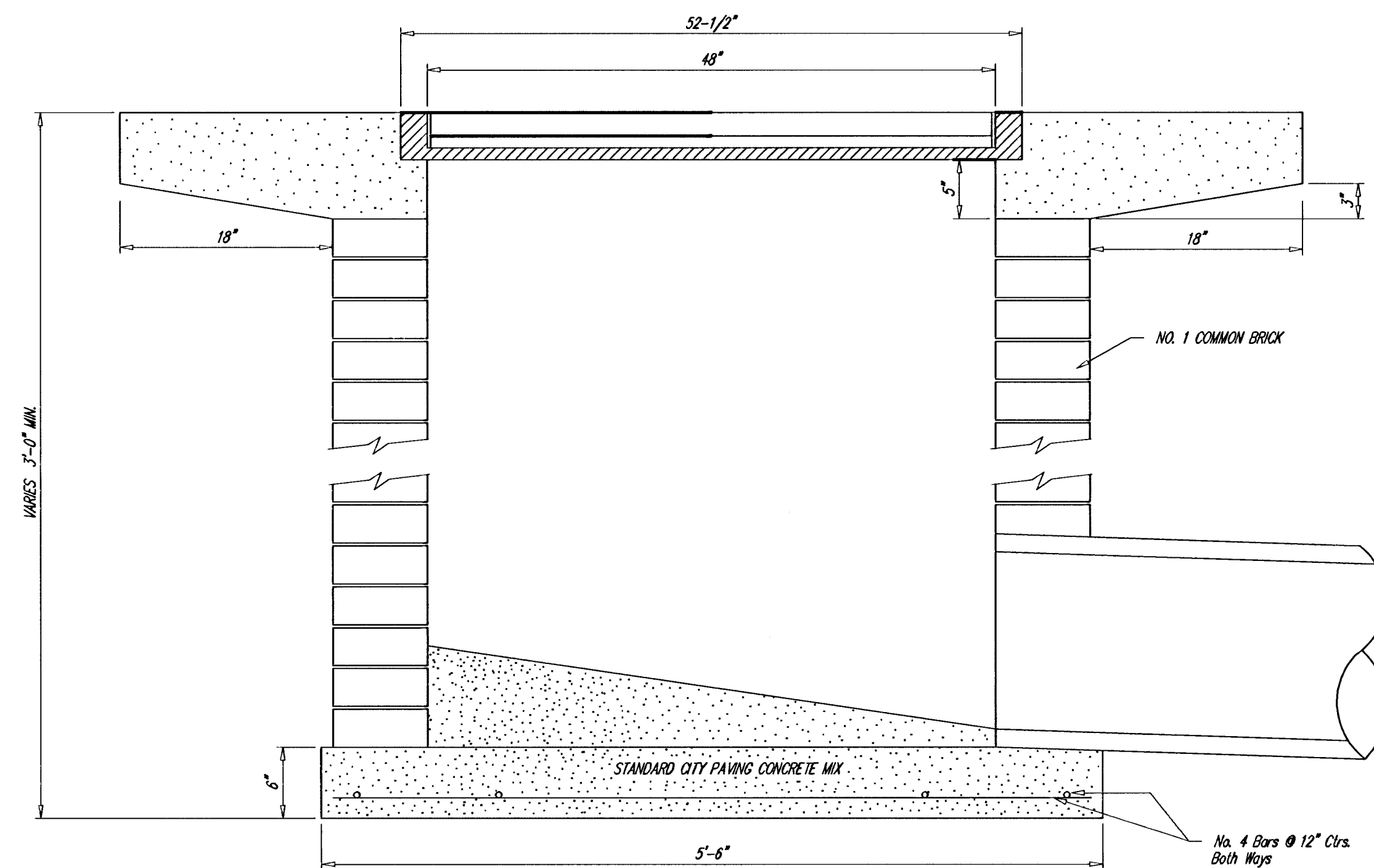
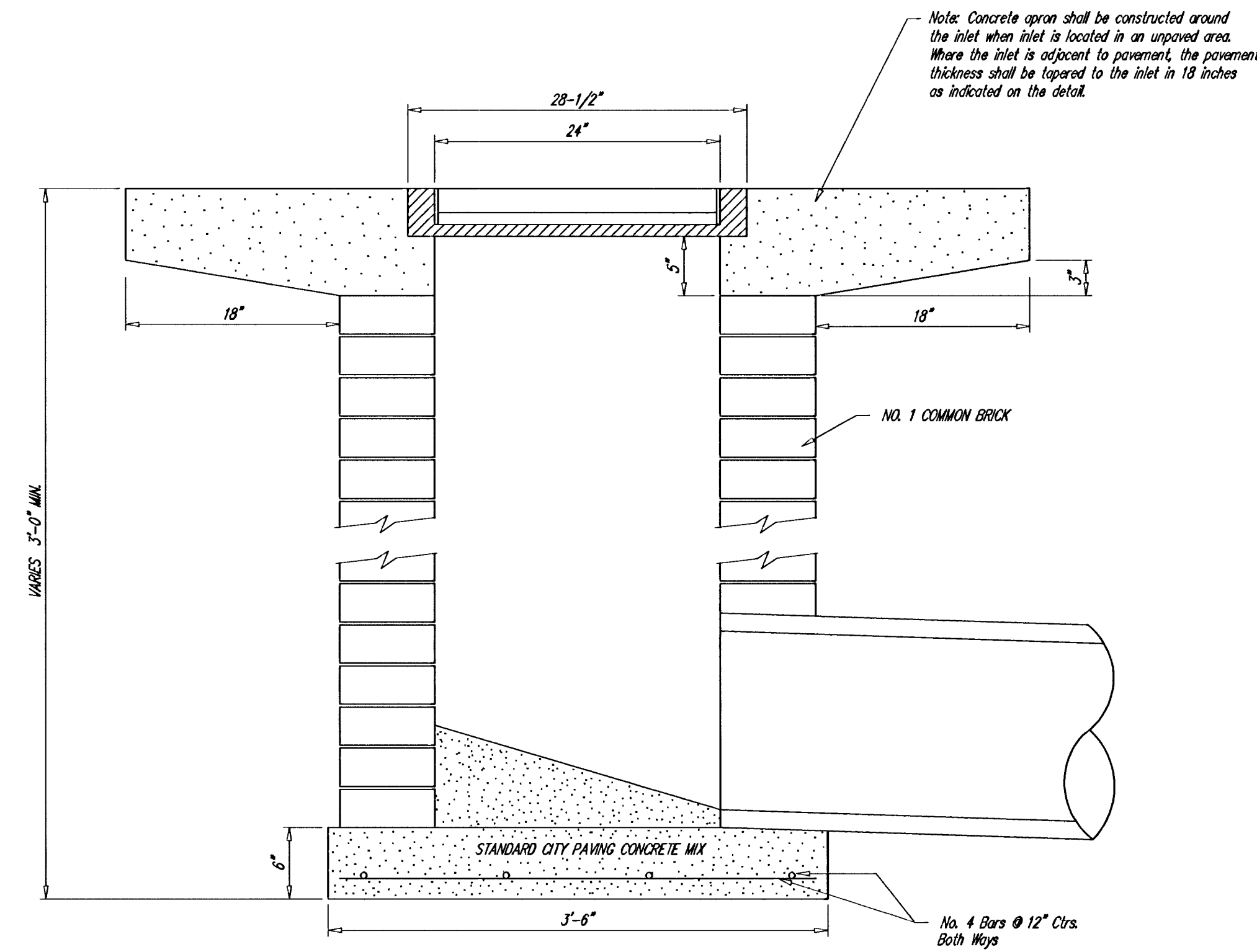
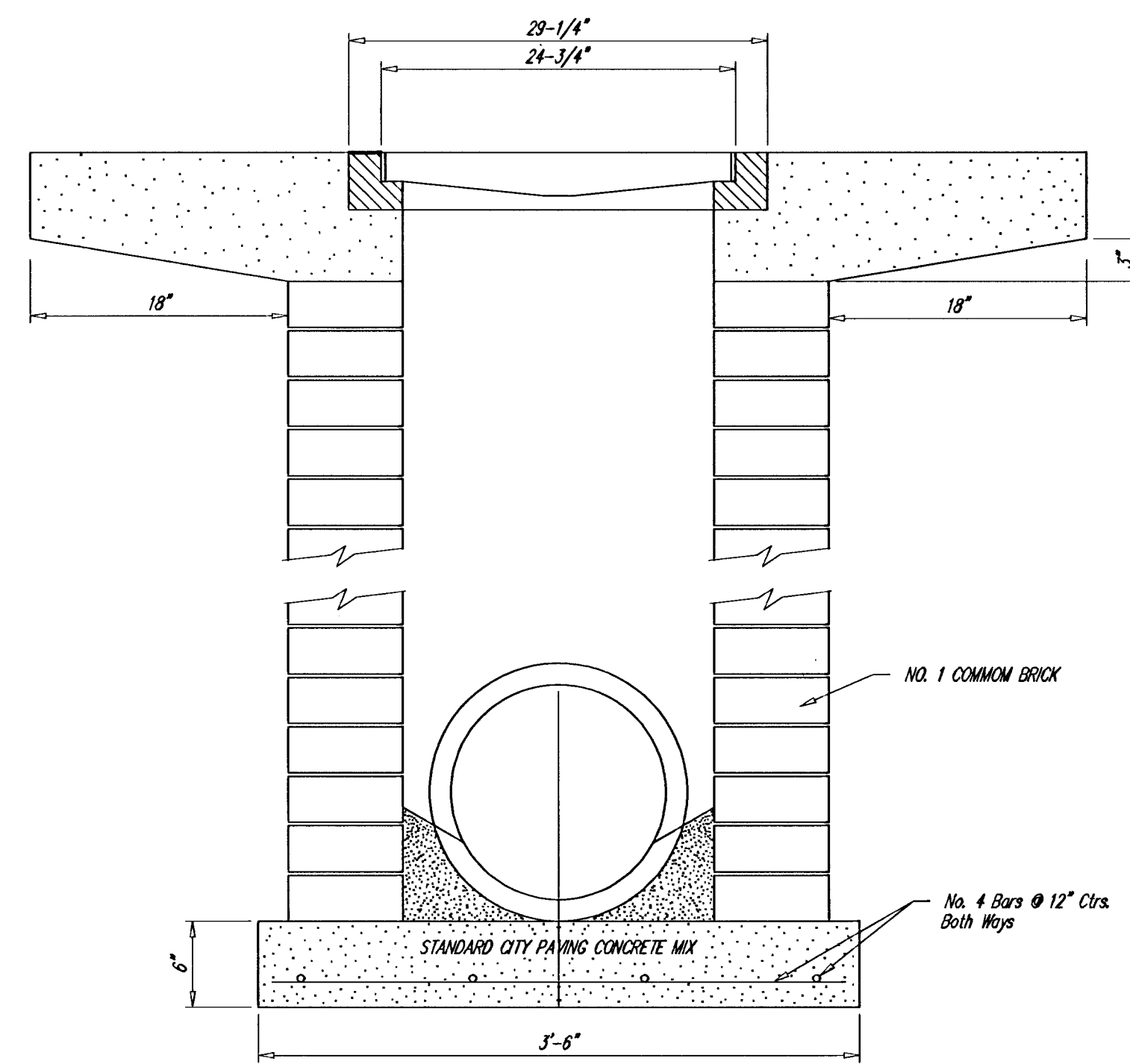

No.	Date	By	Approved	Revision

THE LOCKS AT ABERDEEN  
STREET IMPROVEMENTS  
DROP INLET DETAILS  
CITY OF WICHITA, KANSAS  
MICHAEL E. UNDEBAK, P.E. - CITY ENGINEER  
Proj# 472-68259 C.C.A.# 76861

POE & ASSOCIATES OF KANSAS, INC.  
CONSULTING ENGINEERS  
5940 E. Central, Suite 200 ■ Wichita, KS 67208-4242  
Phone 316/685-4114 ■ FAX 316/685-4444

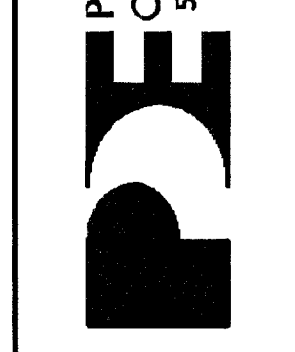

**FINAL**  
Engineer: J. Ubert  
Drawn By: B. Kulla  
Poe Job No.: 16568  
Date: May 2001