

P.I. @ Sta. 68+46.91' Back=
Sta. 68+42.98 Ahead
1. Set #4 Bar w/cap at P.I.
2. Point No. 567 (C67)
N=9862.1799
E=11488.4480

P.T. @ Sta. 69+70.23
1. Set Nail and Shiner at P.T.
2. Point No. 179 (C67)
N=9924.8151
E=11599.2187

P.C. @ East Bound Sta. 69+83.23=
P.O.T. @ West Bound Sta. 69+83.23 Back=
P.O.T. @ West Bound Sta. 69+99.09 Ahead
1. Set Nail and Shiner at P.C.
2. Point No. 89 (C55)
N=9931.2139
E=11610.5349

P.C. @ West Bound Sta. 70+46.11
1. Set Nail and Shiner at P.C.
2. Point No. 198 (C68)
N=9954.3562
E=11651.4622

P.I. @ East Bound Sta. 71+50.16 Back=
Sta. 71+28.91 Ahead
1. Set #4 Bar w/cap at P.I.
2. Point No. 555 (C55)
N=10013.3779
E=11755.8423

P.I. @ West Bound Sta. 71+82.95 Back=
Sta. 71+64.98 Ahead
1. Set #4 Bar w/cap at P.I.
2. Point No. 568 (C68)
N=10021.7084
E=11770.5748

P.C.C. @ West Bound Sta. 73+01.82
1. Set #4 Bar w/cap at P.C.C.
2. Point No. 199 (C68/C69)
N=9972.5939
E=11898.2927

P.C.C. @ East Bound Sta. 72+95.84
1. Set #4 Bar w/cap at P.C.C.
2. Point No. 88 (C55/C56)
N=9955.5534
E=11912.4357

PLAN	SURVEYED	DATE
NOTE BOOK	PLOTTED	
NO.	ALIGNMENT CHECKED	
	RT. OF WAY CHECKED	

DSNR: DEP. OPER. DEP. SCALE: 1"=20.00
Q:\1999\59773\000\MARKING68-74_06-01-2001_03:03:25.am

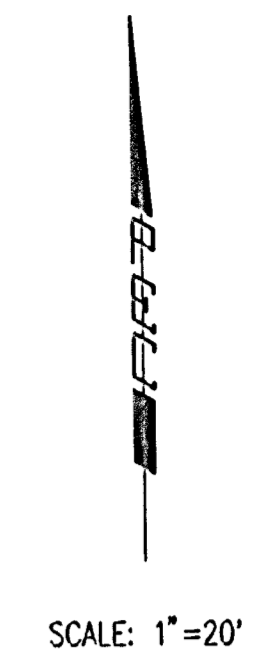
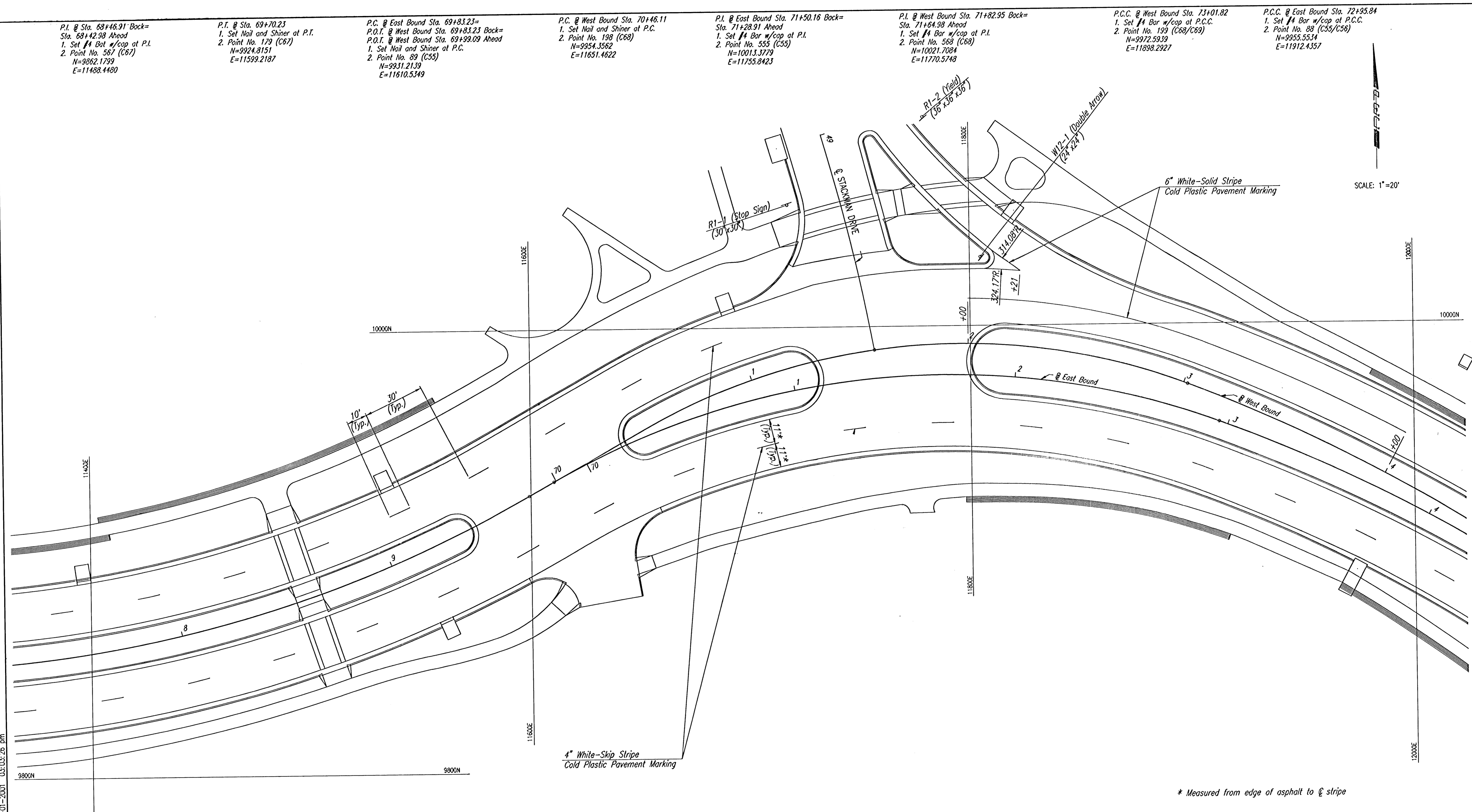

* Measured from edge of asphalt to center of stripe

B.M. #4 - Chiseled center face of Curb Inlet on East side Concrete Drive, 1st Drive West of Stockman on South side Sim Park Drive.
@ East Bound Sta. 69+87, 81' Rt.
Elev.=112.03

MUSEUM DISTRICT ROADWAY AND PEDESTRIAN IMPROVEMENTS WICHITA, KANSAS		
MARKING AND SIGNING PLAN STA. 67+50.00 TO STA. 74+00.00		
PROJECT NO.		SHEET MS-4

REV.	DATE	DESCRIPTION