

SCALE: 1"=20'

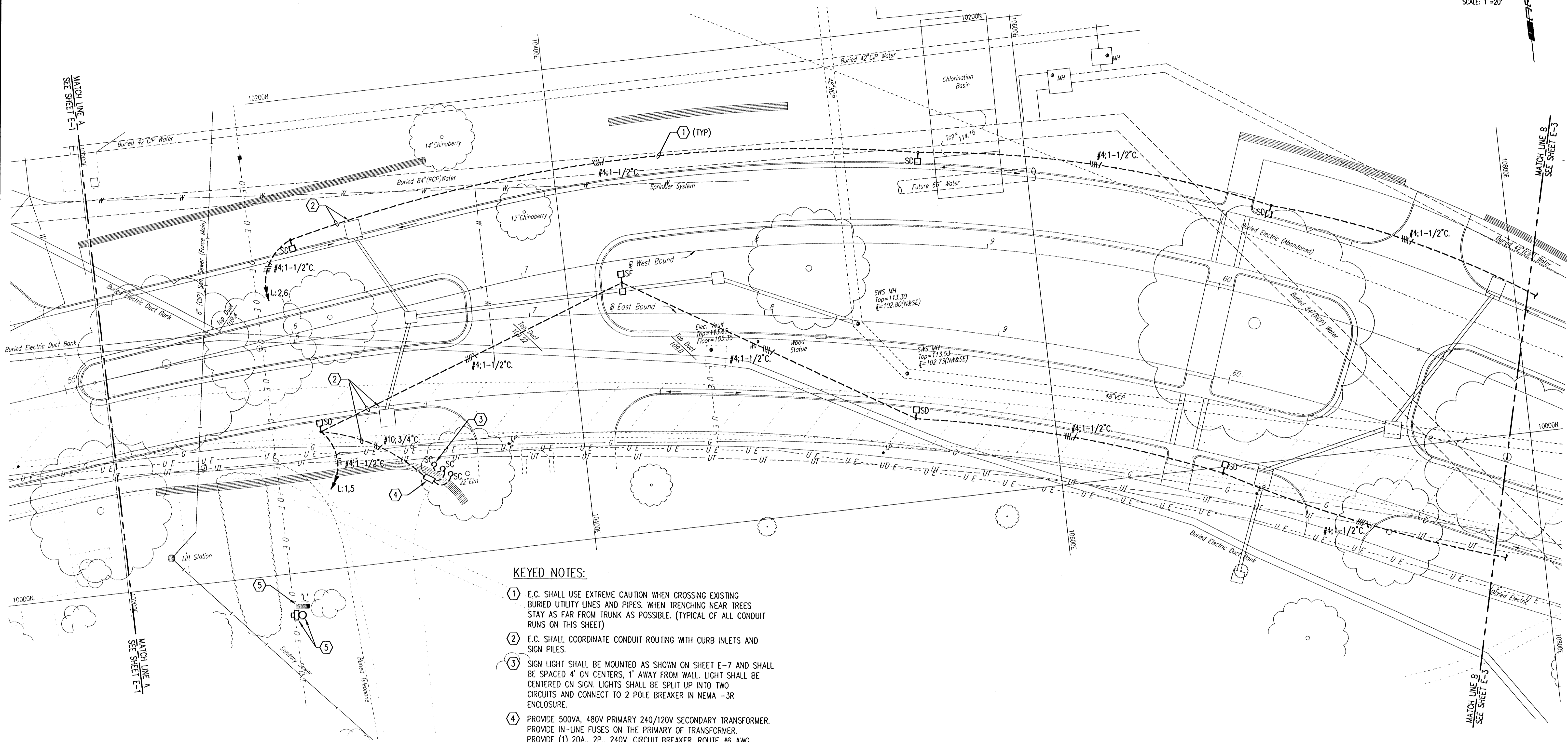

KEYED NOTES:

- ① E.C. SHALL USE EXTREME CAUTION WHEN CROSSING EXISTING BURIED UTILITY LINES AND PIPES. WHEN TRENCHING NEAR TREES STAY AS FAR FROM TRUNK AS POSSIBLE. (TYPICAL OF ALL CONDUIT RUNS ON THIS SHEET)
- ② E.C. SHALL COORDINATE CONDUIT ROUTING WITH CURB INLETS AND SIGN PILES.
- ③ SIGN LIGHT SHALL BE MOUNTED AS SHOWN ON SHEET E-7 AND SHALL BE SPACED 4' ON CENTERS, 1' AWAY FROM WALL. LIGHT SHALL BE CENTERED ON SIGN. LIGHTS SHALL BE SPLIT UP INTO TWO CIRCUITS AND CONNECT TO 2 POLE BREAKER IN NEMA -3R ENCLOSURE.
- ④ PROVIDE 500VA, 480V PRIMARY 240/120V SECONDARY TRANSFORMER. PROVIDE IN-LINE FUSES ON THE PRIMARY OF TRANSFORMER. PROVIDE (1) 20A, 2P., 240V. CIRCUIT BREAKER. ROUTE #6 AWG. CU CONDUCTOR TO 3/4"x20" GROUND ROD. ALL DEVICES SHALL BE MOUNTED IN NEMA-3R, PAD MOUNTED ENCLOSURE, MAX. 18" HIGH. SUBMIT DETAIL FOR APPROVAL.
- ⑤ KC&E METER, POLE WITH NEW OVERHEAD 480V, 1Ø SERVICE. VERIFY EXACT LOCATION WITH KC&E REPRESENTATIVE.
- ⑥ PROVIDE NEW REMOTE POWER DISTRIBUTION CABINET BY MILBANK MFG. (1-800-422-4260) CABINET SHALL INCLUDE (1) 100A. 480/277V, 1Ø, 3W. NEMA-1 PANEL BOARD WITH 100A. MAIN BREAKER, (1) PHOTOCELL, (1) 30A, 12 POLE LIGHTING CONTACTOR. CABINET SHALL BE MOUNTED ON CONCRETE PAD. VERIFY DIMENSION WITH MFG. CABINET AND ALL INTERIOR PARTS SHALL BE BY ONE MANUFACTURER.

REV.	DATE	DESCRIPTION

HELLMUTH, OBATA & KASSEBAUM, INC.
DALLAS, TEXAS

PROFESSIONAL ENGINEERING
CONSULTANTS, P.A.
WICHITA, KANSAS

BRAD J. GOLDBERG
DALLAS, TEXAS

**MUSEUM DISTRICT ROADWAY AND
PEDESTRIAN IMPROVEMENTS
WICHITA, KANSAS**

LIGHTING PLAN

PROJECT NO. 99773-000	SCALE: 1"=20'	SHEET E-2
--------------------------	------------------	--------------

DSNR: ZDH OPER: MDB SCALE: 1"=20'-0"
 E:\9999\99773\000\WUSEZ.DWG 06-04-2001 01:09:26 pm