

MATCH LINE-D
SEE SHEET E-4

MATCH LINE-D
SEE SHEET E-4

SCALE: 1"=20'

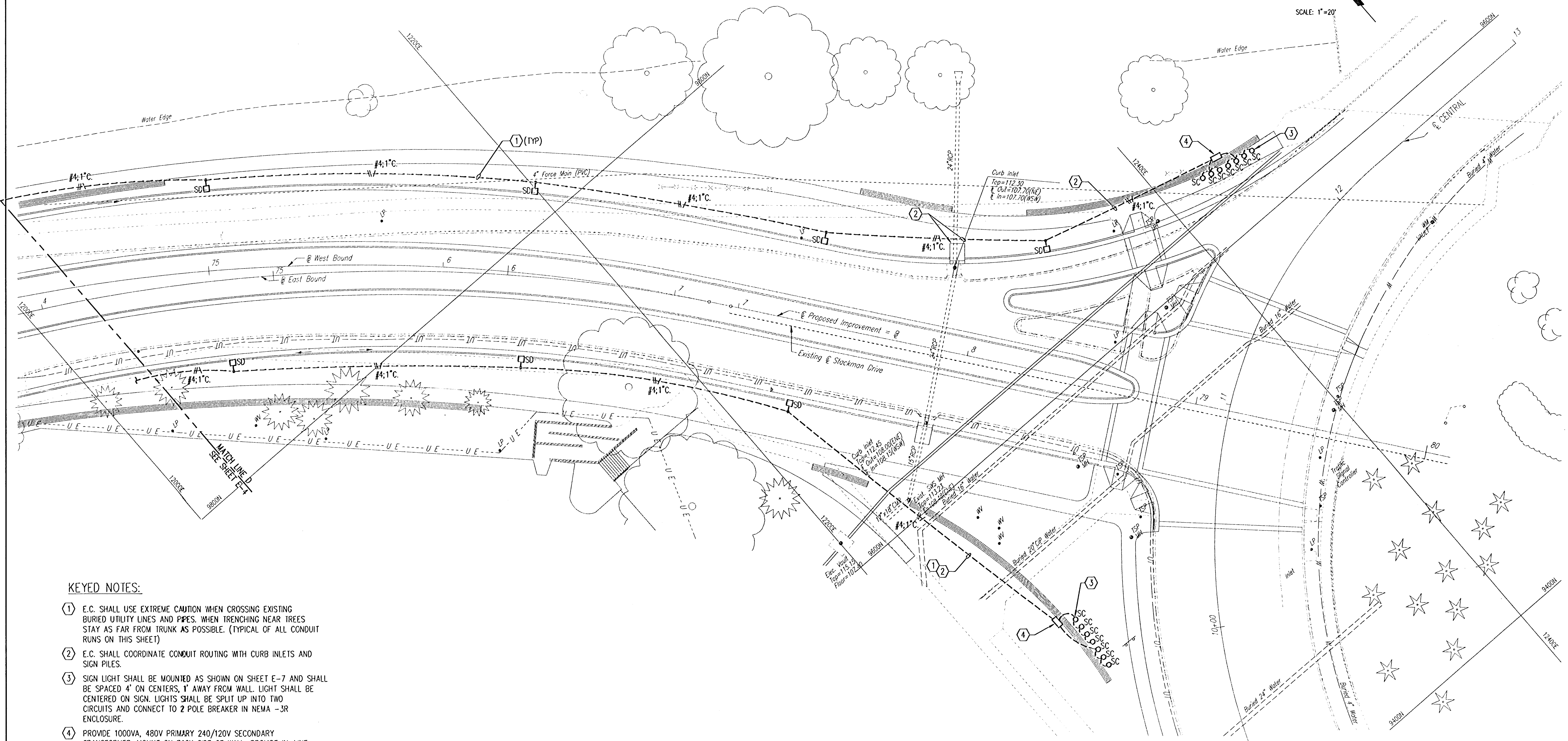

KEYED NOTES:

- ① E.C. SHALL USE EXTREME CAUTION WHEN CROSSING EXISTING BURIED UTILITY LINES AND PIPES. WHEN TRENCHING NEAR TREES STAY AS FAR FROM TRUNK AS POSSIBLE. (TYPICAL OF ALL CONDUIT RUNS ON THIS SHEET)
- ② E.C. SHALL COORDINATE CONDUIT ROUTING WITH CURB INLETS AND SIGN PILES.
- ③ SIGN LIGHT SHALL BE MOUNTED AS SHOWN ON SHEET E-7 AND SHALL BE SPACED 4' ON CENTERS, 1' AWAY FROM WALL. LIGHT SHALL BE CENTERED ON SIGN. LIGHTS SHALL BE SPLIT UP INTO TWO CIRCUITS AND CONNECT TO 2 POLE BREAKER IN NEMA -3R ENCLOSURE.
- ④ PROVIDE 1000VA, 480V PRIMARY 240/120V SECONDARY TRANSFORMER. MOUNT ON BACK SIDE OF WALL. PROVIDE IN-LINE FUSES ON THE PRIMARY OF TRANSFORMER. PROVIDE (1) 20A., 2P., 240V. CIRCUIT BREAKER. ROUTE #6 AWG. CU CONDUCTOR TO 3/4"x20" GROUND ROD. ALL DEVICES SHALL BE MOUNTED IN NEMA-3R, PAD MOUNTED ENCLOSURE, MAX. 18" HIGH. SUBMIT DETAIL FOR APPROVAL.

DSNR: ZDH OPER: MDB SCALE: 1"=20'-0"
 E:\999\99773\000\MUSE.DWG 06-04-2001 01:49:25 pm

HELLMUTH, OBATA & KASSEBAUM, INC. DALLAS, TEXAS PROFESSIONAL ENGINEERING CONSULTANTS, P.A. WICHITA, KANSAS BRAD J. GOLDBERG DALLAS, TEXAS			MUSEUM DISTRICT ROADWAY AND PEDESTRIAN IMPROVEMENTS WICHITA, KANSAS		
			LIGHTING PLAN		
PROJECT NO. 99773-000		SCALE: 1"=20'		SHEET E-5	
REV.	DATE	DESCRIPTION			