

PINE MEADOW  
SECOND ADDITION

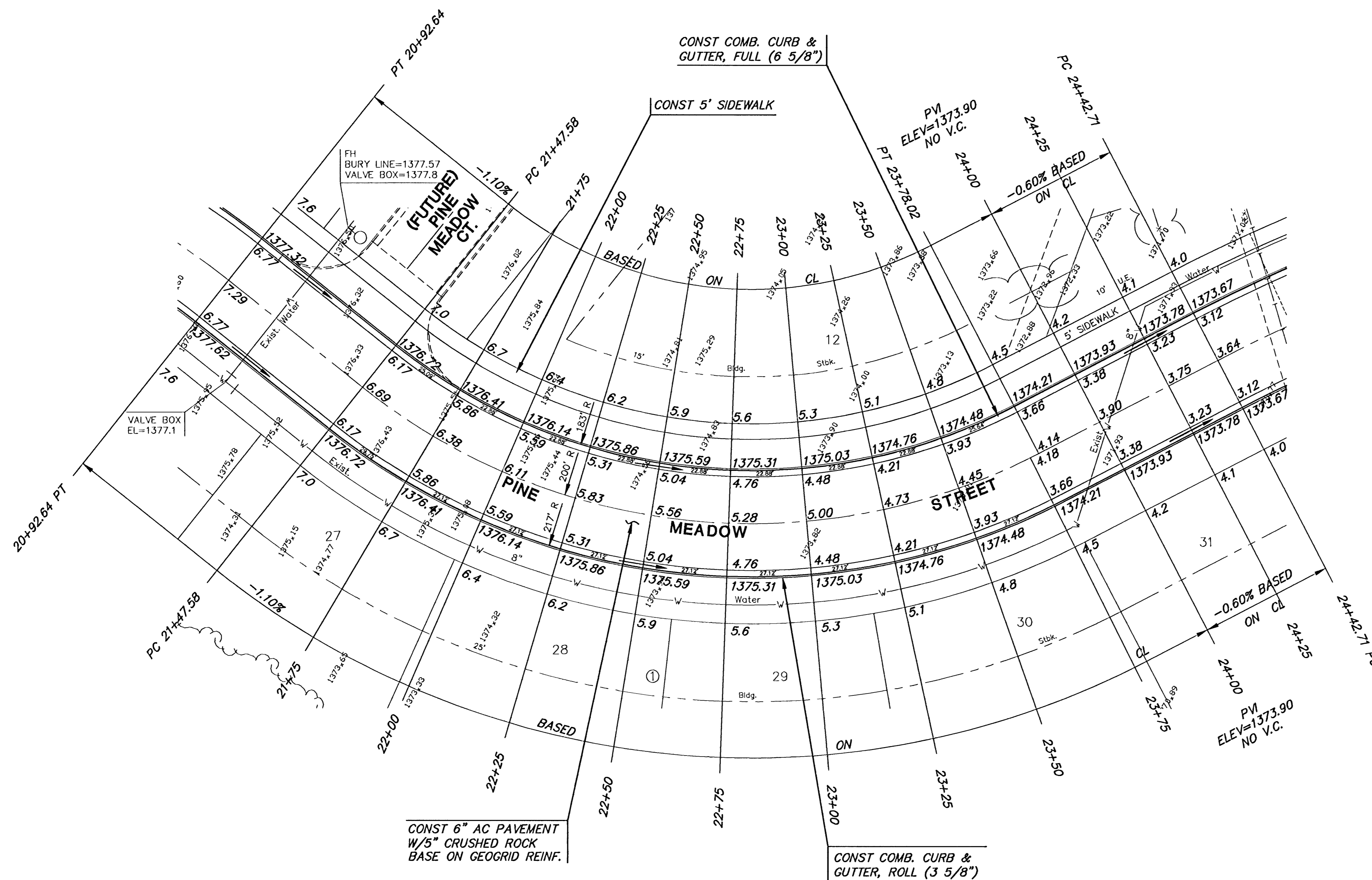

CURVE TABLE					
$\Delta = 66^{\circ}00'51''$ R = 200.00' T = 129.92' L = 230.43' LC = 217.90'					
CURVE DATA BASED ON CENTERLINE $\Delta / 2 = 33^{\circ}00'26''$					
STATION	ARC	CHORD LENGTH		DEFLECTION	TOTAL DEFLECTION
		8' Off LtCb	8' Off RtCb		
21+47.58	-	-	-	00°00'00"	00°00'00"
21+74.20	26.62'	23.28'	29.93'	03°48'47"	03°48'47"
21+75.00	.80'	.70'	.90'	00°06'53"	03°55'39"
22+00.00	25.00'	21.88'	28.11'	03°34'52"	07°30'31"
22+25.00	25.00'	21.88'	28.11'	03°34'52"	11°05'23"
22+50.00	25.00'	21.88'	28.11'	03°34'52"	14°40'14"
22+75.00	25.00'	21.88'	28.11'	03°34'52"	18°15'06"
23+00.00	25.00'	21.88'	28.11'	03°34'52"	21°49'57"
23+25.00	25.00'	21.88'	28.11'	03°34'52"	25°24'49"
23+50.00	25.00'	21.88'	28.11'	03°34'52"	28°59'40"
23+75.00	25.00'	21.88'	28.11'	03°34'52"	32°34'32"
23+78.02	3.02'	2.64'	3.39'	00°25'54"	33°00'26"

Def/Ft = 8.59437 Min.

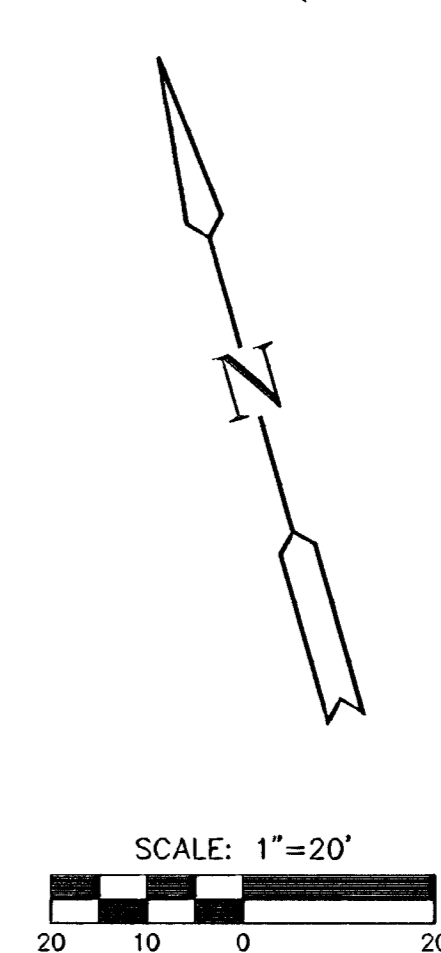

PINE MEADOW ADDITION

SUBDIVISION BENCH MARKS				
NO.	STREET AND STATION	FROM CL	DESCRIPTION	ELEVATIONS
1	PINE MEADOW STA., 16+74.39	17.5' RT	NORTHWEST END OF RETURN AT PINE MEADOW ST. AND BRISTOL ST.	
2	PINE MEADOW STA., 21+74.20	17.5' LT	SOUTHEAST END OF RETURN AT PINE MEADOW AND PINE MEADOW CT.	

NOTE: CONTRACTOR SHALL INSTALL SUBDIVISION BENCH MARKS ("FLAT SURVEY MARKERS NO. 8134-08 3" TOP DIAMETER" PROVIDED BY KANSAS BLUE PRINT CO., INC.) COSTS TO BE CONSIDERED SUBSIDIARY TO CONSTRUCTION OF COMBINED CURB AND GUTTER.

**PINE MEADOW & PINE MEADOW SECOND ADDITION**  
PROJECT NAME

**PAVING PLANS**  
SHEET TITLE

**MKEC**  
ENGINEERING CONSULTANTS  
411 N. WEBB ROAD  
WICHITA, KS. 67208  
316 - 884 - 9800

DFL DESIGN BY. DMU DRAWN BY. G/A CHECKED BY.

MARCH 2002 DATE. 01077E2 JOB NO. 5 / 20 SHEET/OF

H:\CIVIL\01077E2\DWG\PAV\01077E2.DWG Tue Mar 05 15:30:45 2002