

PINE MEADOW SECOND ADDITION

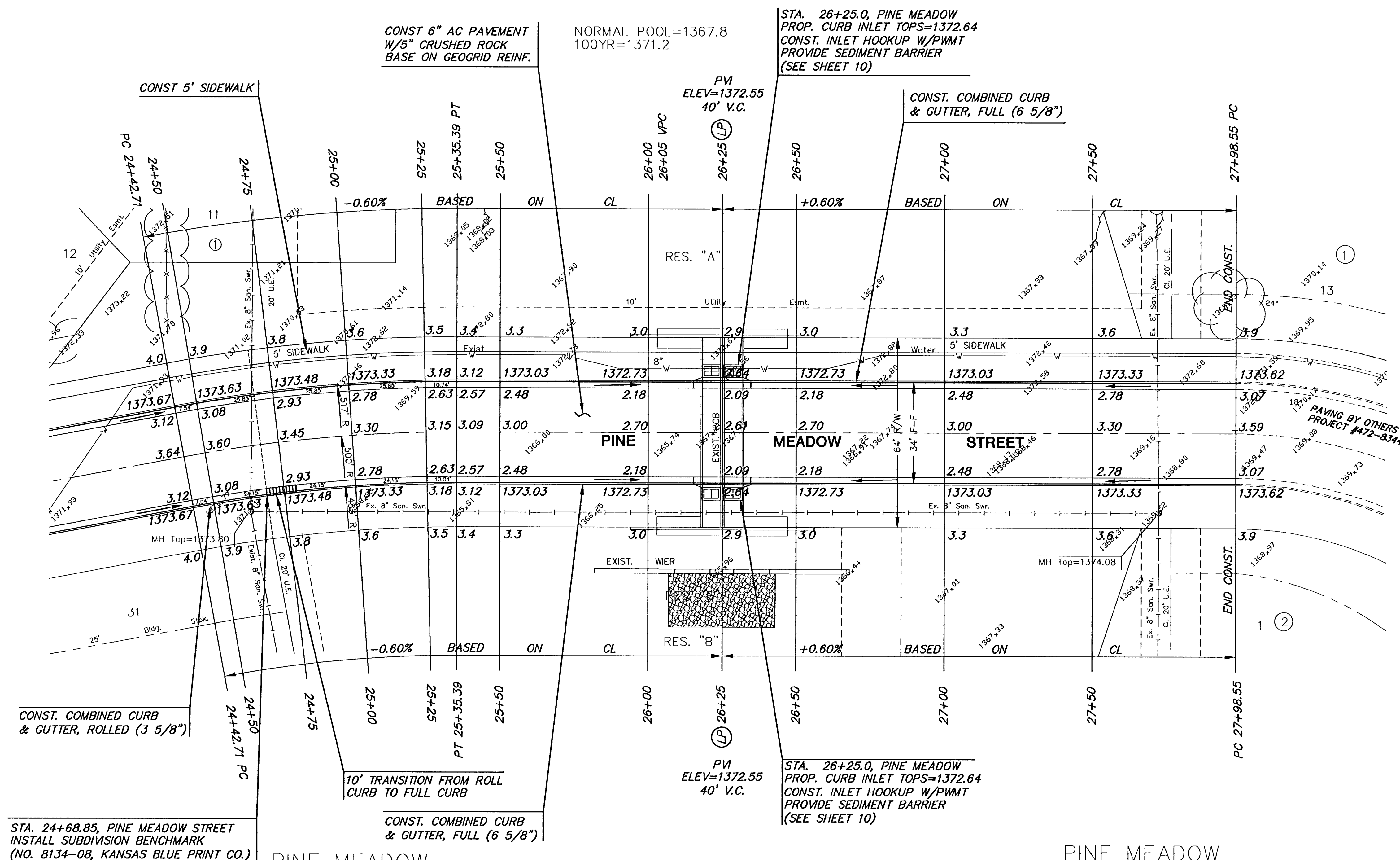

STA. 24+68.85, PINE MEADOW STREET
INSTALL SUBDIVISION BENCHMARK
(NO. 8134-08, KANSAS BLUE PRINT CO.)

PINE MEADOW
ADDITION

NORMAL POOL=1362.0
100YR=1366.7

PINE MEADOW
SECOND ADDITION

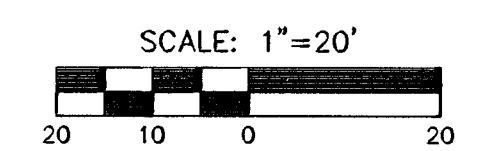

| CURVE TABLE | | | | | |
|--|--------|--------------|-------------|------------|------------------|
| $\Delta = 10^{\circ}37'12''$ R = 500.00' T = 46.47' L = 92.68' LC = 92.54' | | | | | |
| CURVE DATA BASED ON CENTERLINE $\Delta / 2 = 05^{\circ}18'36''$ | | | | | |
| STATION | ARC | CHORD LENGTH | | DEFLECTION | TOTAL DEFLECTION |
| | | 8' Off LtCb | 8' Off RtCb | | |
| 24+42.71 | - | - | - | 00°00'00" | 00°00'00" |
| 24+50.00 | 7.29' | 7.65' | 6.93' | 00°25'04" | 00°25'04" |
| 24+75.00 | 25.00' | 26.25' | 23.75' | 01°25'57" | 01°51'00" |
| 25+00.00 | 25.00' | 26.25' | 23.75' | 01°25'57" | 03°16'57" |
| 25+25.00 | 25.00' | 26.25' | 23.75' | 01°25'57" | 04°42'54" |
| 25+35.39 | 10.39' | 10.91' | 9.87' | 00°35'42" | 05°18'36" |
| Def/Ft = 3.43775 Min. | | | | | |

MKEC
ENGINEERING
CONSULTANTS
411 N. WEBB ROAD
WICHITA, KS. 67206
316 - 864 - 9600

PINE MEADOW & PINE MEADOW SECOND ADDITION
PROJECT NAME

PAVING PLANS
SHEET TITLE

| | | |
|--------------------|--------------------|--------------------|
| DFL DESIGN BY: | DMU DRAWN BY: | GJA CHECKED BY: |
| MARCH 2002 DATE | 01077E3 JOB NO. | 6 / 20 SHEET/OF |

H:\GVL\01077\DWG\PAV\01077E3

H:\GVL\01077\DWG\PAV\01077E3.DWG Tue Mar 05 15:31:15 2002