

SCALE: 1" = 40'

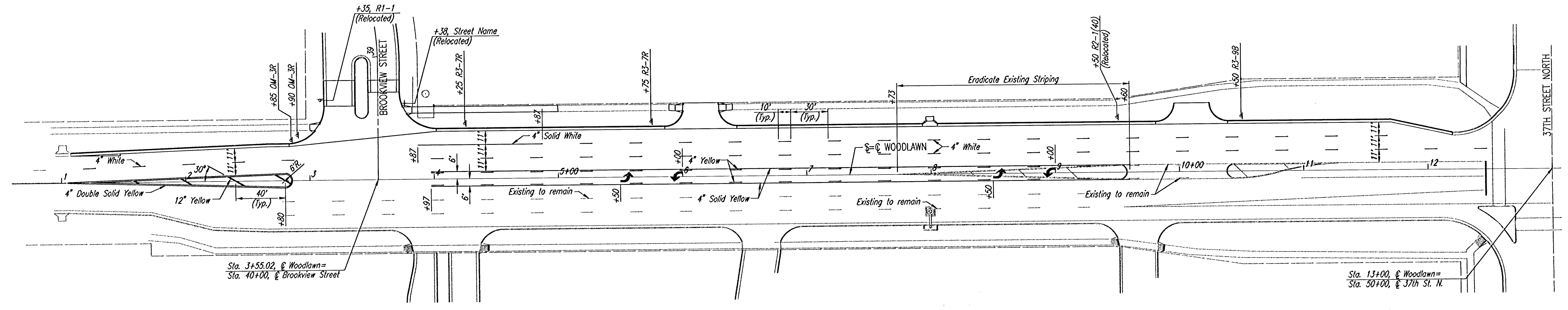

NOTES: IMPROVEMENTS AND STRIPING SHOWN AS EXISTING ON THE EAST SIDE OF WOODLAWN ARE PROPOSED (BY OTHERS). CONTRACTOR SHALL VERIFY EXISTING STRIPING BEFORE INSTALLATION AND REPORT DISCREPANCIES TO THE ENGINEER.

ALL EXISTING MARKING WHICH CONFLICTS WITH THE PROPOSED PLAN SHALL BE REMOVED BY GRINDING OR OTHER MECHANICAL MEANS (PAINTING OVER EXISTING MARKING WILL NOT BE ALLOWED). THIS WORK SHALL BE CONSIDERED SUBSIDIARY TO THE BID ITEM "PAVEMENT MARKING".

UNLESS OTHERWISE NOTED, DIMENSIONS ARE FROM ϕ STRIPE TO ϕ STRIPE.

ALL MARKINGS SHALL CONFORM TO THE LATEST STANDARDS SET FORTH IN THE LATEST PUBLICATION OF THE "MANUAL ON UNIFORM TRAFFIC CONTROL DEVICES".

ALL PAVEMENT MARKINGS SHALL BE THE "COLD-LAID PLASTIC TAPE" TYPE OR THERMOPLASTIC TYPE (WHITE AND YELLOW), MEETING THE REQUIRED SPECIFICATIONS OF THE KANSAS DEPARTMENT OF TRANSPORTATION.

INSTALLATION OF MARKING TAPES ON OTHER THAN NEW ASPHALTIC CONCRETE PAVEMENT SHALL BE ACCOMPLISHED IN ACCORDANCE WITH INSTALLATION SPECIFICATIONS FOR COLD-LAID MARKINGS.

WHERE NEW ASPHALTIC CONCRETE PAVEMENT IS BEING CONSTRUCTED, THE NEW PAVEMENT MARKINGS MUST BE INSTALLED WHILE THE NEW WEARING SURFACE IS STILL WARM (AT LEAST 130°F-54.4°C) AND ROLLED SO AS TO INLAY THE PAVEMENT MARKINGS INTO THE NEW PAVEMENT SURFACE.

RECAPITULATION OF QUANTITIES		
ITEMS	TOTAL	UNITS
PAVEMENT MARKING (THERMOPLASTIC)(WHITE)(4")	520	L.F.
PAVEMENT MARKING (THERMOPLASTIC)(YELLOW)(4")	2087	L.F.
PAVEMENT MARKING (THERMOPLASTIC)(YELLOW)(12")	45	L.F.
PAVEMENT MARKING SYMBOL (WHITE ARROWS)	4	EACH

FOR INFORMATION ONLY - BID ITEM "PAVEMENT MARKING" IS PAID AS LUMP SUM.

WOODLAWN

PAVEMENT MARKING AND SIGNING PLAN

Professional Engineering Consultants, P.A.
 303 S. TOPEKA • WICHITA, KANSAS 67202
 316-262-2691 • FAX 316-262-3003

Designed by DRC	Checked by
Drawn by DEP	Date JUNE, 2001 Job No. 01034

DSNR: BER OPER: DEP SCALE: 1"=40.00
 CA:2001\01034\000\Woodlawn\MARKING_11-13-2001_01:17:09_pm