

WATER VALVE BOX ELEVATIONS			
STREET	STATION	OFFSET	PROPOSED ELEVATION
BRACKEN COURT	39+80.50	36.75' RL	1368.6

Sta. 40+00.00 @ Bracken Court=
Ctr. Cul-de-sac

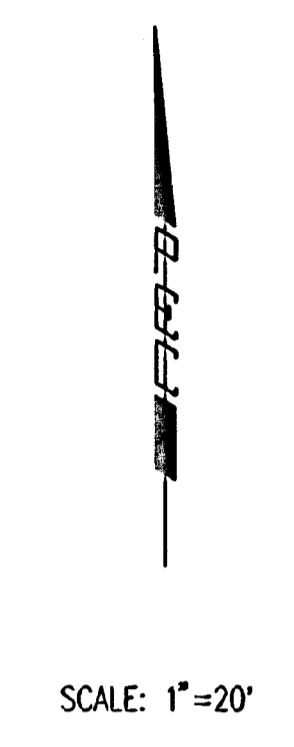
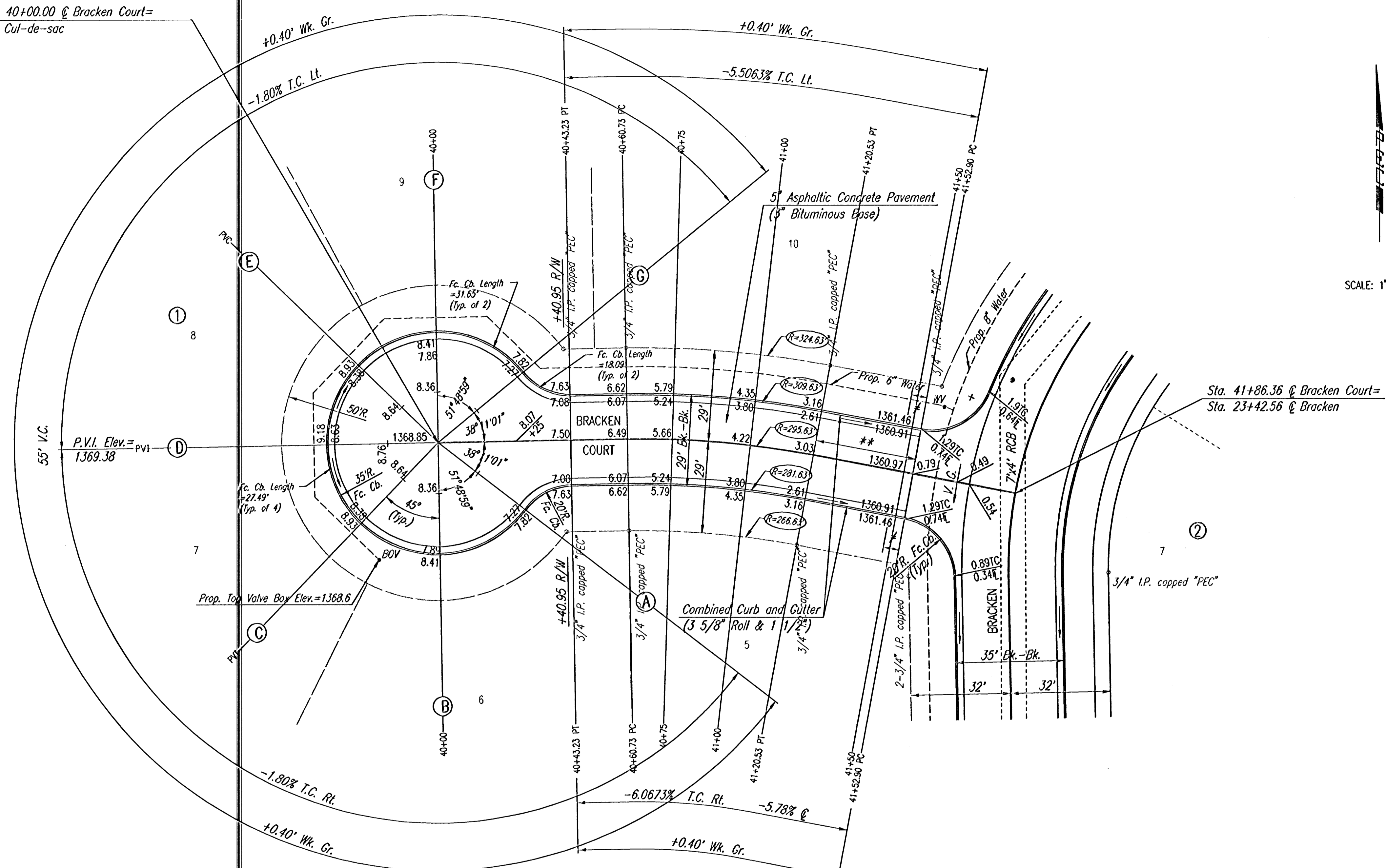

Sta. 41+86.36 @ Bracken Court=
Sta. 23+42.56 @ Bracken

5' TRANSITION FROM COMBINED CURB AND GUTTER 3 5/8\"/>

** TRANSITION FROM 3/8\"/>

@ CURVE DATA						
$\Delta=11^{\circ}35'20''$		$D=19^{\circ}22'52''$		$R=295.63'$	$L=59.80'$	$T=30.00'$
CURVE DATA BASED ON @ RADIUS $\Delta/2=5^{\circ}47'40''$						
@ STATION	@ ARC LENGTH	FACE CURB LENGTH		CHORD LENGTH		@ TOTAL DEFLECTION
		LEFT CURB	RIGHT CURB	8' OFF LEFT FACE CURB	8' OFF RIGHT FACE CURB	
40+60.73						0°00'00"
40+75	14.27'	14.95'	13.59'	15.33'	13.21'	1°22'58"
41+00	25.00'	28.18'	23.82'	28.85'	23.13'	2°25'21"
41+20.53	20.53'	21.50'	19.55'	22.05'	18.99'	1°59'21"
TOTAL	59.80'	62.63'	56.96'	Delta/lt.=5.813824 min.		5°47'40"

NOTE: THIS STREET TO BE CONSTRUCTED WITH ROLL-TYPE CURB. TOP OF CURB ELEVATIONS GIVEN ARE FOR FULL HEIGHT CURB.

DSNR: DEP OPER: SAD SCALE: 1"=20.00
 G:\2001\01545\000\BRACKENCT.DWG 03-13-2002 04:02:52 pm

BALTHROP 4TH ADDITION

BRACKEN COURT

STA. 40+00.00 TO STA. 41+86.36

Professional Engineering Consultants, P.A.
 303 S. TOPEKA • WICHITA, KANSAS 67202
 316-262-2691 • FAX 316-262-3003

Designed by	BER	Checked by	
Drawn by	DEP	Date	FEB. 2002
		Job No.	01545