

Subdivision Bench Marks

No.	Street and Station	From CL	Description	Elevation
1	Stout, Sta. 9+43.47	17.5' Lt.	S.W. End of Curb Return Intersection of Stout and Bellick/Hunters View.	

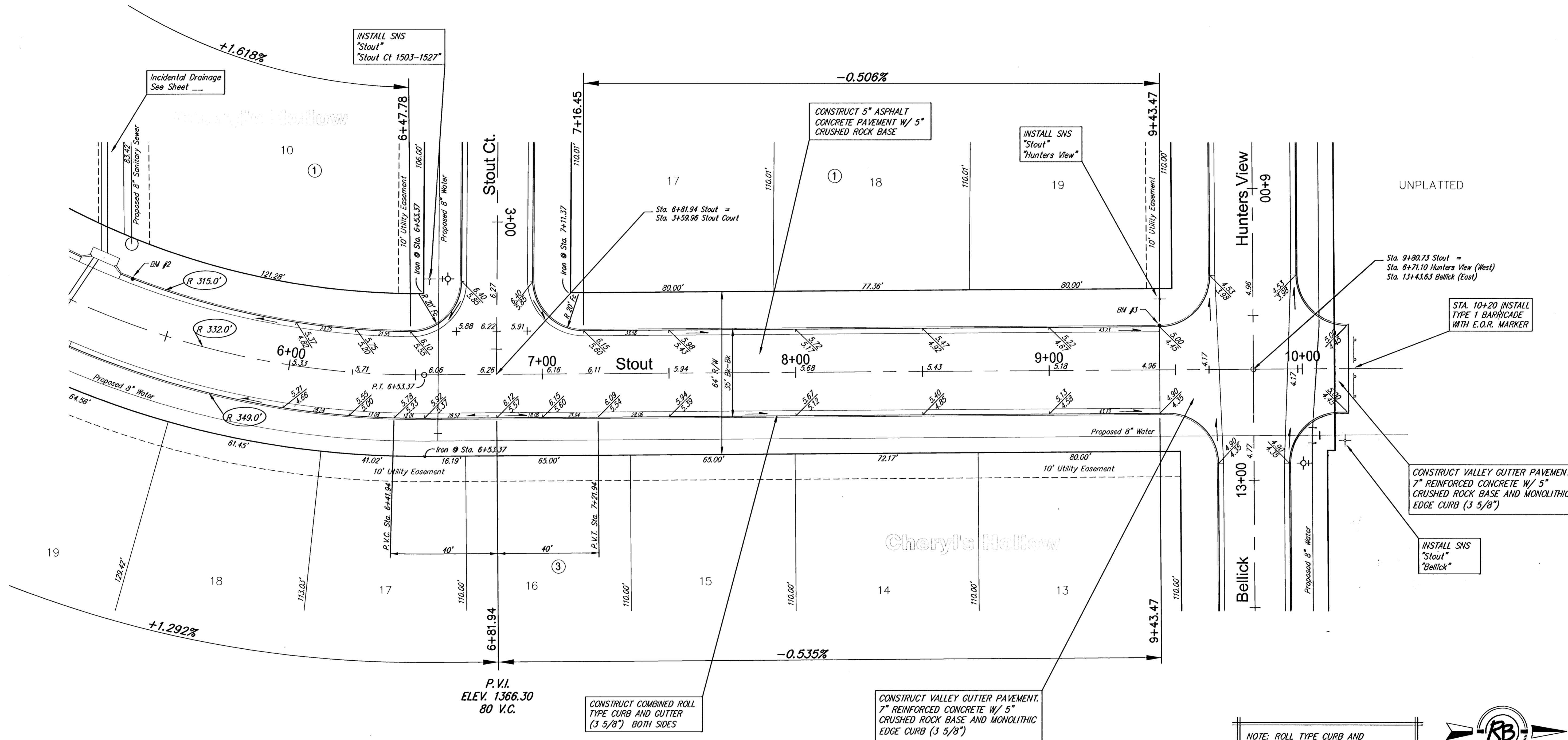

Sta. 9+80.73 Stout =
Sta. 6+71.10 Hunters View (West)
Sta. 13+43.63 Bellick (East)

STA. 10+20 INSTALL
TYPE 1 BARRICADE
WITH E.O.R. MARKER

CONSTRUCT VALLEY GUTTER PAVEMENT,
7" REINFORCED CONCRETE W/ 5"
CRUSHED ROCK BASE AND MONOLITHIC
EDGE CURB (3 5/8")

INSTALL SWS
"Stout"
"Bellick"

CONSTRUCT COMBINED ROLL
TYPE CURB AND GUTTER
(3 5/8") BOTH SIDES

CONSTRUCT VALLEY GUTTER PAVEMENT,
7" REINFORCED CONCRETE W/ 5"
CRUSHED ROCK BASE AND MONOLITHIC
EDGE CURB (3 5/8")

NOTE: ROLL TYPE CURB AND
GUTTER TO BE CONSTRUCTED ALONG
PAVEMENT DEPICTED ON THIS SHEET

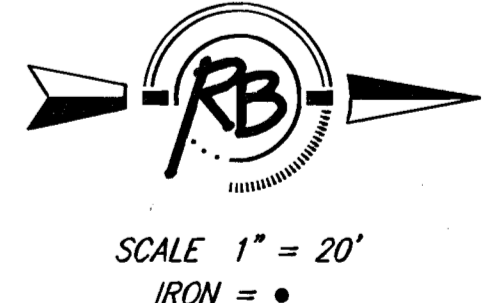

Cheryl's Hollow Addition, Paving Improvements
Stout
WICHITA, KANSAS

	Ruggles & Bohm, P.A. Engineering, Surveying, Land Planning		DESIGN KWL
	924 North Main Wichita, Kansas 67203 www.rbkansas.com		DRAWN RA
(316) 264-8008 (316) 264-4621 fax E-mail: info@rbkansas.com		REVIEW	SHEET 7
DRAWING FILE paving [Stout 2]	PROJECT NUMBER	DATE Aug. 2, 2005	OF 43