

BENCHMARK
 119th St. W. & Pawnee
 City of Wichita Benchmark Disc.
 NE corner of intersection. 40' E
 and 30' N of centerline. 59.5' N of
 power pole @ SE corner of
 intersection. 156.8' NNE of
 centerline of E concrete headwall on
 culvert under 119th St. W.
 Elev. = 148.68 (City Datum)
 Elev. = 1336.08 (N.G.V.D.29)

Scale: 1" = 20'
 • = Iron

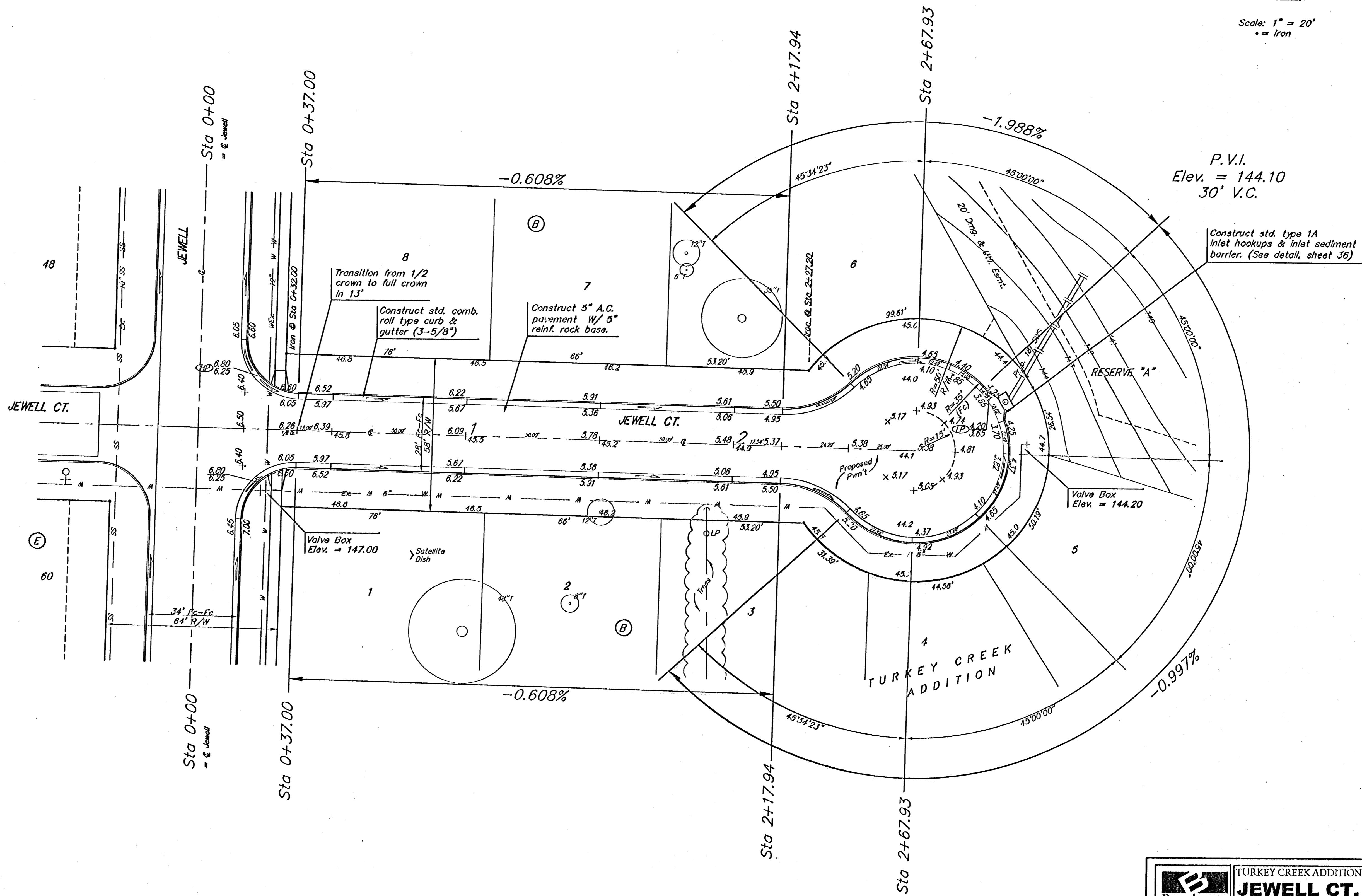

P.V.I.
 Elev. = 144.10
 30' V.C.

Construct std. type 1A
 inlet hookups & inlet sediment
 barrier. (See detail, sheet 36)

8
 Transition from 1/2
 crown to full crown
 in 13'
 Construct std. comb.
 roll type curb &
 gutter (3-5/8")

7
 Construct 5" A.C.
 pavement W/ 5"
 reinf. rock base.

Valve Box
 Elev. = 147.00

Valve Box
 Elev. = 144.20

Adjust water valve
 boxes as needed to
 grade. Incidental to
 'Site Clearing and
 Restoration'.

Existing trees and
 structures shall be
 removed by others
 prior to construction.

NOTE:
 ROLL TYPE CURB & GUTTER TO
 BE CONSTRUCTED ON THE
 PAVEMENT SHOWN ON THIS SHEET.
 TOP OF CURB ELEVATIONS ARE
 GIVEN FOR FULL HEIGHT CURB.

		TURKEY CREEK ADDITION - PH. I JEWELL CT. STA 0+00 TO STA 2+67.93	
<small>Baughman Company, P.A. 315 Elm St. Wichita, KS 67211 P3162627771 F3162626149 ENGINEERING SURVEYING PLANNING LANDSCAPE ARCHITECTURE</small>			
PROJECT NUMBER 47284028	DESIGN TMS	DRAWN TMS	DATE 12/04
REVISIONS	APPROVED	SCALE Noted	SHEET 8 OF 48
<small>TurkeyCreek/St3</small>		<small>04060931</small>	